



4 Greystones Road, Bearsted, Maidstone, Kent, ME15 8PD
Offers In Excess Of £540,000

This well-maintained and extended detached property is located in a pleasant and sought-after cul-de-sac in Bearsted, offering a nice setting with convenient access to local amenities and transport links.

The property provides generous accommodation, including an entrance hall, ground floor WC, a spacious lounge/dining room leading to a double-glazed conservatory, and an extended kitchen. Upstairs, there are three well-proportioned bedrooms, along with a family bathroom and a separate shower.

A particular feature is the excellent parking provision, with a block-paved in-and-out driveway and additional parking to the side. The south facing rear garden is enclosed and low maintenance, with side access and a detached storage garage featuring windows to both the front and rear and personal door to the front.

Bearsted benefits from excellent transport links with easy access to the M20 and M2 motorways and via mainline train station taking you straight into London Victoria. The area has excellent schools and the picturesque Village Green boasts a selection of popular pubs, cafe's and restaurants. Local leisure facilities include Bearsted golf, bowls and tennis clubs and nearby leisure centres, whilst the beautiful grounds of both Leeds Castle and Mote Park are also close by. Tenure: Freehold. EPC Rating: D. Council Tax Band: E.



Ground Floor
Entrance Hall
Cloakroom/Wc
Generous Sized Lounge/Dining Room
Double Glazed Conservatory
Kitchen
First Floor
Landing
Bedroom
Bedroom
Bedroom
Bathroom/Wc
Shower
Externally
Drive Way
Gardens
Detached Storage Garage
Viewing

Strictly by arrangement with the Agent's Bearsted Office, 132 Ashford Road, Bearsted, Maidstone, Kent
ME14 4LX . Tel: 01622 739574.

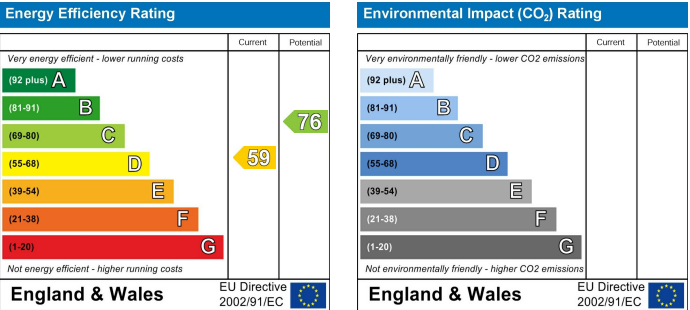

Page & Wells limited for themselves and for the vendors of this property whose agents they are give notice that: 1. These particulars do not constitute any part of, an offer or a contract. 2. All statements contained in these particulars as to this property are made without responsibility on the part of Page & Wells Limited or the Vendor. 3. None of the statements contained in these particulars as to the property is to be relied on as statements or representations of fact. 4. Any intending purchaser must satisfy himself by inspection or otherwise as to the correctness of each of the statements contained in these particulars. 5. The vendor does not make or give, and neither Page & Wells Limited nor any person in their employment has any authority to make or give any representation whatsoever in relation to this property. These particulars are supplied on the understanding that all negotiations are carried out throughout Page & Wells Limited. Properties with a reference prefixes EAA are those which Page & Wells Limited disclose an interest in accordance with the provisions of the Estates Agents Act 1979



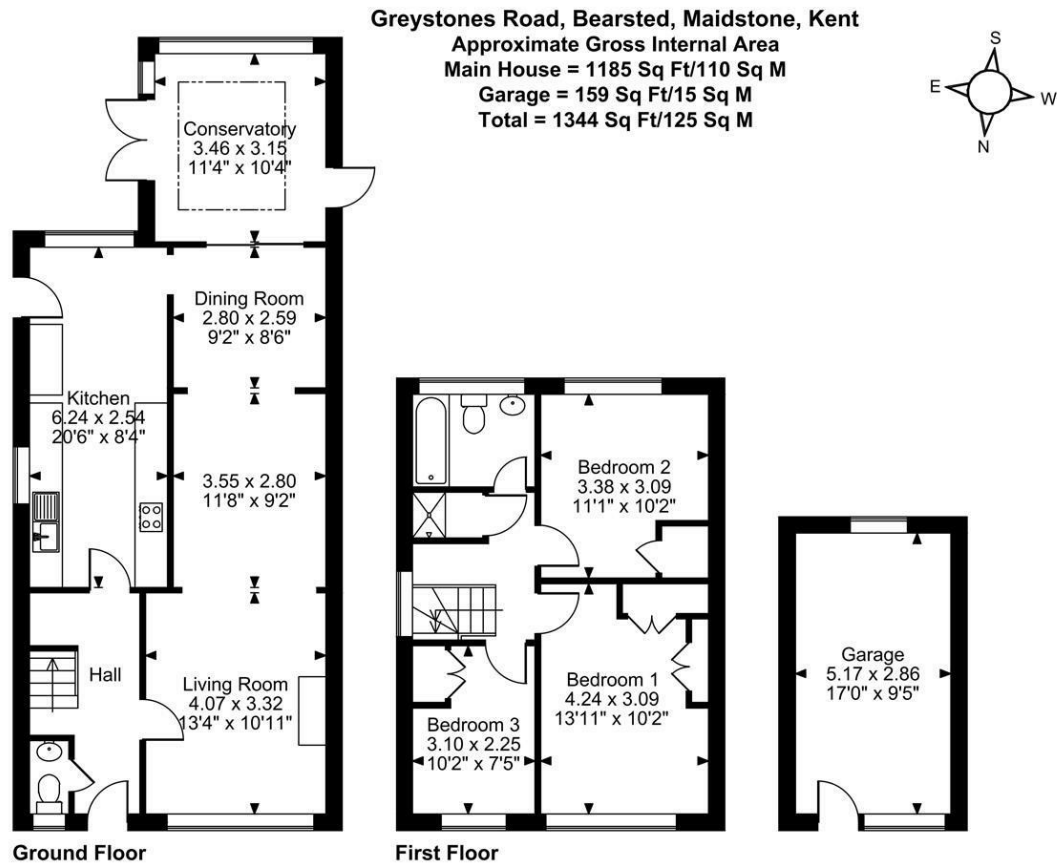

FOR ILLUSTRATIVE PURPOSES ONLY - NOT TO SCALE

The position & size of doors, windows, appliances and other features are approximate only.

© ehouse. Unauthorised reproduction prohibited. Drawing ref. dig/8645498/TOW

