



**Madginford Road, Bearsted, Maidstone, , ME15 8LB**

**Guide Price £425,000**





**\*\* GUIDE PRICE £425,000 - £450,000 \*\*** This extended three-bedroom detached bungalow is situated on a desirable corner plot within the sought-after Madginford area of Bearsted.

As you approach the property, you will be greeted by an attractive block-paved footpath that leads to a welcoming porch and entrance hall. The spacious sitting room overlooks the lush front garden, creating a serene atmosphere. The well-designed kitchen seamlessly connects to a separate dining room, which could easily be reconfigured back into an open space, reminiscent of its original design.

The bungalow offers three generous bedrooms, complemented by a shower room. An additional extension to the side currently serves as a library or study, providing versatile space that could also be transformed into a dressing room. Outside, the property showcases a substantial front garden and a block-paved driveway, accommodating a few vehicles and leading to a detached garage. A handy side gate provides access to the rear garden, which is mostly laid to lawn and features raised flower beds, a charming patio seating area, and a convenient shed for all your gardening needs. This home presents a blank canvas, inviting you to personalise it and make it your own. Tenure: Freehold. EPC Rating: D. Council Tax Band: E.



## LOCATION

The neighbourhood boasts a diverse range of amenities, including shops, a library, and schools. Just a short distance away is the picturesque village centre of Bearsted, featuring historic buildings, lush green spaces, sports clubs, pubs, restaurants, a church, and a London line train station. Within a few minutes' walk, you will find the stunning grounds of Mote Park, and Maidstone town centre is easily accessible, located about 3 miles away, with a reliable bus service available.

## ACCOMMODATION

Porch

Entrance Hall

Cloakroom

Sitting Room

Dining Room

Kitchen

Bedroom One

Bedroom Two

Bedroom Three

Shower Room

Library/Study

## EXTERNALLY

Front & Rear Garden

Detached Garage

## VIEWING

Strictly by arrangement with the Agent's Bearsted Office, 132 Ashford Road, Bearsted, Maidstone, Kent ME14 4LX. Tel: 01622 739574.

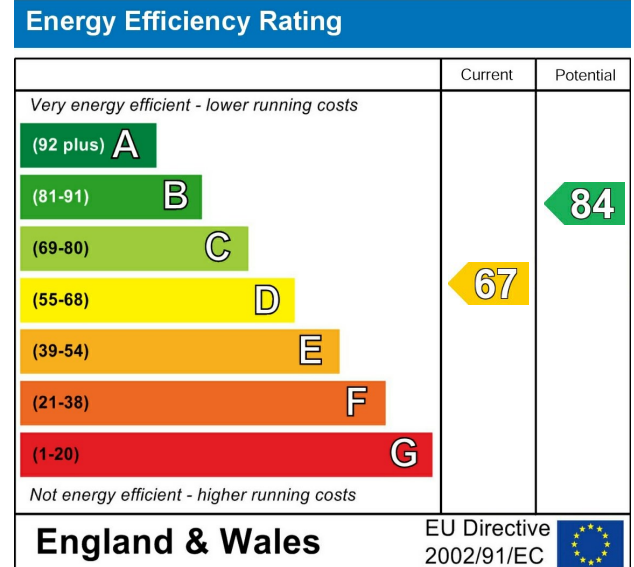

Page & Wells limited for themselves and for the vendors of this property whose agents they are give notice that: 1. These particulars do not constitute any part of, an offer or a contract. 2. All statements contained in these particulars as to this property are made without responsibility on the part of Page & Wells Limited or the Vendor. 3. None of the statements contained in these particulars as to the property is to be relied on as statements or representations of fact. 4. Any intending purchaser must satisfy himself by inspection or otherwise as to the correctness of each of the statements contained in these particulars. 5. The vendor does not make or give, and neither Page & Wells Limited nor any person in their employment has any authority to make or give any representation whatsoever in relation to this property. These particulars are supplied on the understanding that all negotiations are carried out throughout Page & Wells Limited. Properties with a reference prefixes EAA are whose which Page & Wells Limited disclose an interest in accordance with the provisions of the Estates Agents Act 1979



Madginford Road, Bearsted, Maidstone, Kent  
 Approximate Gross Internal Area  
 Main House = 1068 Sq Ft/99 Sq M  
 Garage = 143 Sq Ft/13 Sq M  
 Total = 1211 Sq Ft/112 Sq M

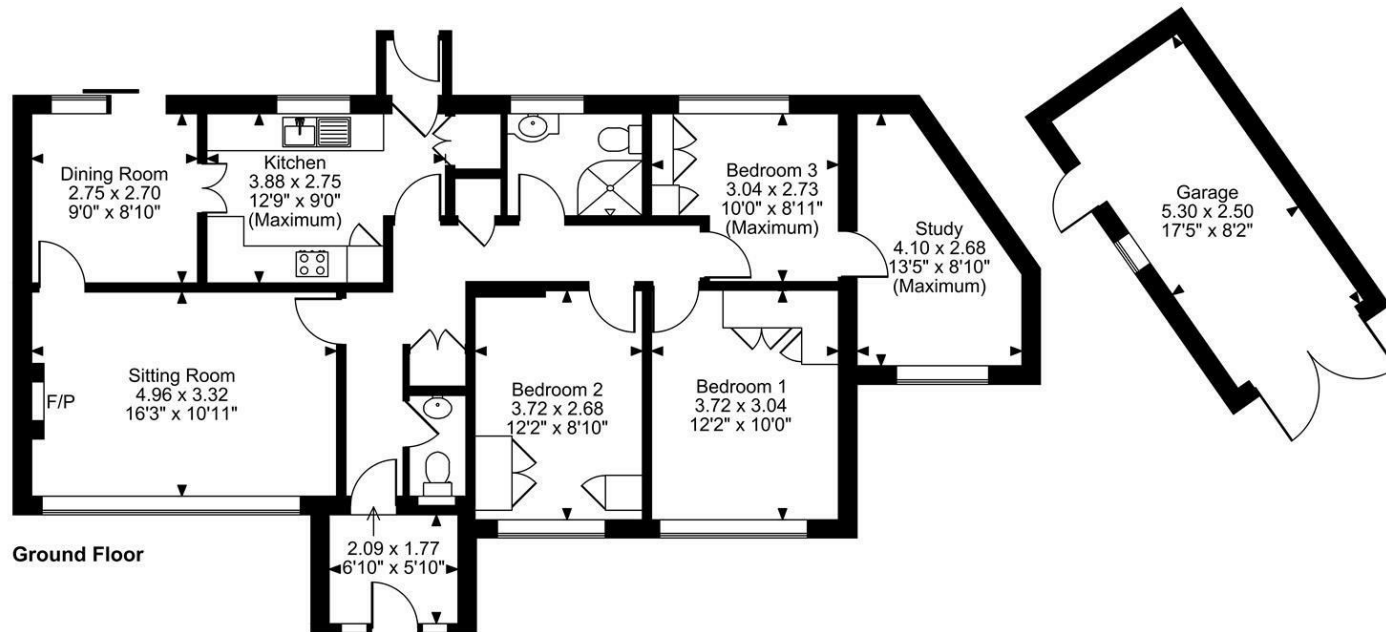
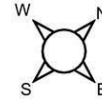

**FOR ILLUSTRATIVE PURPOSES ONLY - NOT TO SCALE**

The position & size of doors, windows, appliances and other features are approximate only.  
 © ehouse. Unauthorised reproduction prohibited. Drawing ref. dig/8627736/LCO

