



**31 Dickens Close, Langley, Maidstone, ME17 1TB**  
**Offers In The Region Of £350,000**

A spacious and well planned semi-detached bungalow situated on a good sized plot having a frontage of approximately 100'. The property has the benefit of oil fired central heating, UPVC double glazed windows and features a large kitchen and a 26' double glazed conservatory. The popular village of Langley is approximately 6 miles from Maidstone town centre, where all amenities are available. There are a good selection of shops and schools nearby, and the larger village of Headcorn is some 6 miles distance where there is a London line station. No forward chain. Tenure: Freehold. EPC Rating: E. Council Tax Band: D.



**INTERNALLY**

**Sitting Room**

**Kitchen/Breakfast Room**

**Large Conservatory**

**Bathroom**

**Bedroom One**

**Bedroom Two**

**EXTERNALLY**

The property is situated on a large plot. The front and side gardens are open plan and walled. The wide rear garden is fully enclosed and has a depth of approximately 50'. Oil tank.

**Detached Garage**

**VIEWING**

Strictly by arrangement with the Agent's Bearsted Office, 132 Ashford Road, Bearsted, Maidstone, Kent ME14 4LX. Tel: 01622 739574.

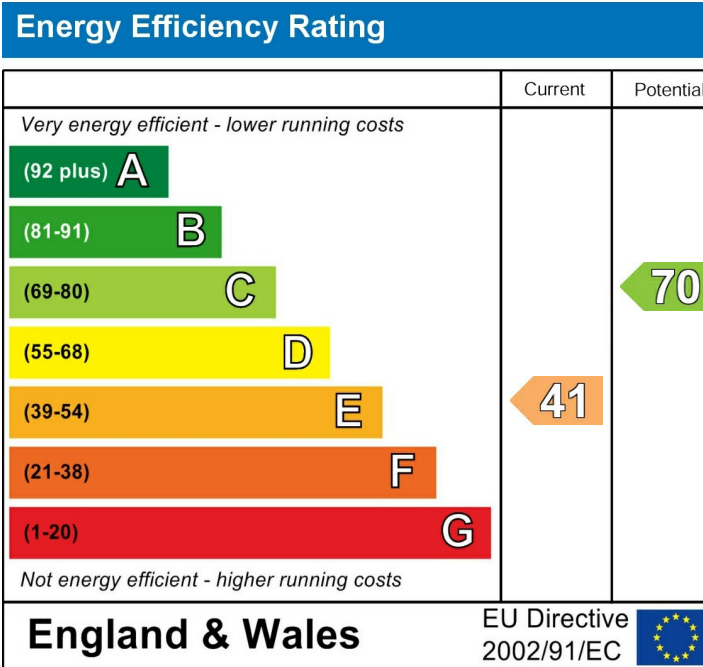

Page & Wells limited for themselves and for the vendors of this property whose agents they are give notice that: 1. These particulars do not constitute any part of, an offer or a contract. 2. All statements contained in these particulars as to this property are made without responsibility on the part of Page & Wells Limited or the Vendor. 3. None of the statements contained in these particulars as to the property is to be relied on as statements or representations of fact. 4. Any intending purchaser must satisfy himself by inspection or otherwise as to the correctness of each of the statements contained in these particulars. 5. The vendor does not make or give, and neither Page & Wells Limited nor any person in their employment has any authority to make or give any representation whatsoever in relation to this property. These particulars are supplied on the understanding that all negotiations are carried out throughout Page & Wells Limited. Properties with a reference prefixes EAA are those which Page & Wells Limited disclose an interest in accordance with the provisions of the Estates Agents Act 1979

Langley, Maidstone, Kent  
Approximate Gross Internal Area  
909 Sq Ft/84 Sq M

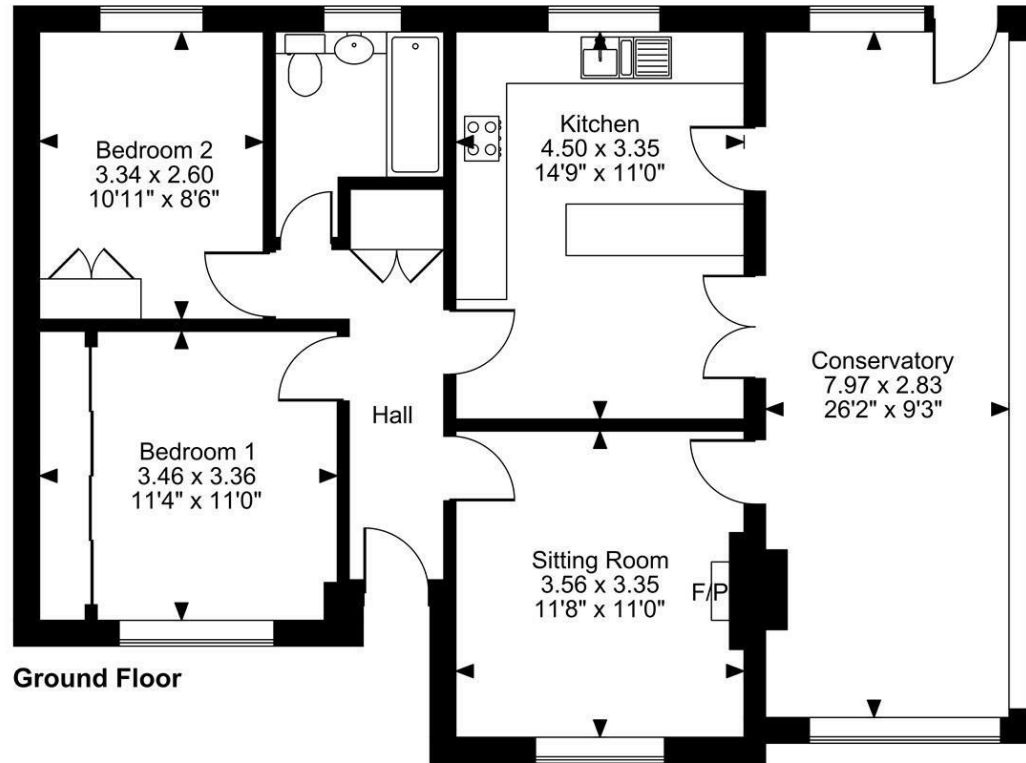
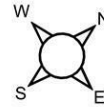

Ground Floor

**FOR ILLUSTRATIVE PURPOSES ONLY - NOT TO SCALE**

The position & size of doors, windows, appliances and other features are approximate only.

© ehouse. Unauthorised reproduction prohibited. Drawing ref. dig/8627126/TOW

