



**The Coach House Thurnham Lane, Thurnham, Maidstone, ME14 3LQ**  
**Offers In The Region Of £600,000**





Introducing this splendid historic Grade II curtilage listed former Coach House meticulously restored and developed to an exceptional standard by the current owners. Attention to detail is second to none, with stunning period features including gorgeous herringbone facades and a fabulous bell tower.

The property is accessed via electric entrance gates, providing a high degree of privacy. It is situated within an approximate half acre plot with well-stocked mature gardens and former quarry land, offering a beautiful woodland walk around the perimeter.

As you enter the property, you are welcomed into the entrance hall, leading to the spacious sitting/dining room with fabulous floor-to-ceiling windows replacing the former Coach House doors. The room also features a magnificent handcrafted staircase and a beautiful fireplace housing the gas log burner. The kitchen boasts a bespoke built-in unit with an inset sink and space for an electric Aga. Completing the ground floor is a downstairs cloakroom.

Upstairs, two fabulous double bedrooms capture attention with stunning vaulted ceilings and their own roll-top baths. The principal bedroom also features its own pedestal basin and stunning southerly views across the countryside. Additionally, a separate WC is accessed via the landing.

Noteworthy features include period column radiators, an array of attractive windows (all refurbished or replaced), solid wood floorboards, reclaimed internal doors, and ornate light switches. Whilst the property would make a superb home, it could also work exceptionally well as a holiday home or catering for high end holiday lets. Tenure: Freehold. EPC Rating: C. Council Tax Band: E.





## LOCATION

Thurnham is a quaint village nestled in the district of Maidstone, characterised by its serene surroundings near the picturesque North Downs. The property is a stone's throw away from The Black Horse, a popular gastro pub, while convenience stores, further dining establishments, and an array of other amenities can be found in the nearby village of Bearsted and the towns of Maidstone and Sittingbourne. Thurnham also features historic landmarks such as Thurnham Castle, adding to the area's charm and offering insights into its rich past. Outdoor enthusiasts will appreciate the abundance of opportunities for hiking, cycling, and exploring the scenic countryside surrounding the village. Additionally, Thurnham provides community facilities such as a village hall for gatherings and events, fostering a strong sense of community among its residents. Connectivity through road and public transportation ensures convenient access to surrounding areas, enhancing the overall appeal of Thurnham as a peaceful rural retreat.

## ACCOMMODATION

### Ground Floor:

Entrance Hall

Cloakroom

Sitting Room

Kitchen

### First Floor:

Bedroom 1 with bath

Bedroom 2 with bath

Cloakroom

## EXTERNALLY

## VIEWING

Strictly by arrangement with the Agent's Bearsted Office, 132 Ashford Road, Bearsted, Maidstone, Kent ME14 4LX . Tel: 01622 739574.

Energy Efficiency Rating		
	Current	Potential
<i>Very energy efficient - lower running costs</i>		
(92 plus) <b>A</b>		
(81-91) <b>B</b>		<b>86</b>
(69-80) <b>C</b>	<b>73</b>	
(55-68) <b>D</b>		
(39-54) <b>E</b>		
(21-38) <b>F</b>		
(1-20) <b>G</b>		
<i>Not energy efficient - higher running costs</i>		
<b>England &amp; Wales</b>	EU Directive 2002/91/EC	

Page & Wells limited for themselves and for the vendors of this property whose agents they are give notice that: 1. These particulars do not constitute any part of, an offer or a contract. 2. All statements contained in these particulars as to this property are made without responsibility on the part of Page & Wells Limited or the Vendor. 3. None of the statements contained in these particulars as to the property is to be relied on as statements or representations of fact. 4. Any intending purchaser must satisfy himself by inspection or otherwise as to the correctness of each of the statements contained in these particulars. 5. The vendor does not make or give, and neither Page & Wells Limited nor any person in their employment has any authority to make or give any representation whatsoever in relation to this property. These particulars are supplied on the understanding that all negotiations are carried out throughout Page & Wells Limited. Properties with a reference prefixes EAA are those which Page & Wells Limited disclose an interest in accordance with the provisions of the Estates Agents Act 1979

Thurnham Lane Thurnham, Maidstone  
Approximate Gross Internal Area  
855 Sq Ft/79 Sq M

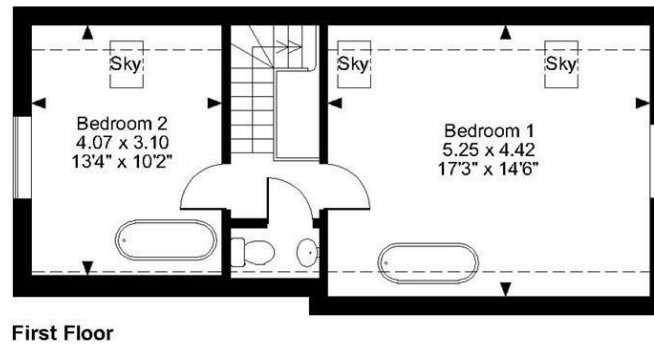
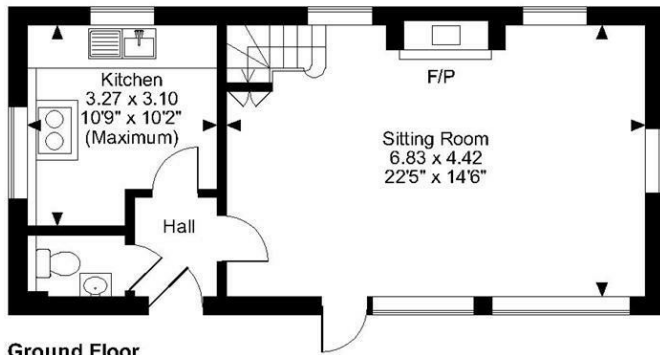
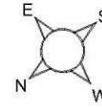

**FOR ILLUSTRATIVE PURPOSES ONLY - NOT TO SCALE**

The position & size of doors, windows, appliances and other features are approximate only.

☐☐☐☐ Denotes restricted head height

© ehouse. Unauthorised reproduction prohibited. Drawing ref. dig/8590254/SS

