



1 Athelstan Green, Hollingbourne, Maidstone, Kent, ME17 1UX
Offers In The Region Of £625,000



Nestled within the highly desirable cul-de-sac of Athelstan Green, in the sought after village of Hollingbourne is this spacious 3-bedroom detached bungalow with scenic views of the North Downs, offering nearly 1,400 sqft of internal space.

The entrance porch leads to a hallway, giving way to a large dual aspect sitting room with fireplace. The contemporary kitchen with granite worktops opens up to a stunning vaulted ceiling dining area with French doors to the rear garden. The property includes a principal bedroom with a modern en-suite wet room, a further double bedroom, a single bedroom, as well as a modern bathroom.

Externally, the property features a large block-paved driveway for up to 5 vehicles, a lawned front garden with established borders, and an attached garage. The rear garden boasts a well-maintained lawn, a spacious patio seating area, and a garden shed.

The popular village of Hollingbourne is served by a station cafe, a few popular pubs and restaurants, a hairdresser, osteopath, primary school, parish church and local parks/walks through the countryside. There is a London line station in the village with direct links to Victoria and Blackfriars, and two stops to Maidstone, the county town of Kent, which is approx. 6-miles distance. Tenure: Freehold. EPC Rating: D. Council Tax Band: E.



INTERNALLY

Entrance Porch

Hallway

Sitting Room

Kitchen

Dining Area

Bedroom 1

En-suite Wet Room

Bedroom 2

Bedroom 3

Bathroom

EXTERNALLY

Front Garden

Driveway

Garage

Rear Garden

VIEWING

Strictly by arrangement with the Agent's Bearsted
Office: 132 Ashford Road, Bearsted, Maidstone, Kent
ME14 4LX. Tel: 01622 739574.

Energy Efficiency Rating

	Current	Potential
<i>Very energy efficient - lower running costs</i>		
(92 plus) A		
(81-91) B		
(69-80) C		76
(55-68) D	56	
(39-54) E		
(21-38) F		
(1-20) G		
<i>Not energy efficient - higher running costs</i>		
England & Wales	EU Directive 2002/91/EC	

Page & Wells limited for themselves and for the vendors of this property whose agents they are give notice that: 1. These particulars do not constitute any part of, an offer or a contract. 2. All statements contained in these particulars as to this property are made without responsibility on the part of Page & Wells Limited or the Vendor. 3. None of the statements contained in these particulars as to the property is to be relied on as statements or representations of fact. 4. Any intending purchaser must satisfy himself by inspection or otherwise as to the correctness of each of the statements contained in these particulars. 5. The vendor does not make or give, and neither Page & Wells Limited nor any person in their employment has any authority to make or give any representation whatsoever in relation to this property. These particulars are supplied on the understanding that all negotiations are carried out throughout Page & Wells Limited. Properties with a reference prefixes EAA are those which Page & Wells Limited disclose an interest in accordance with the provisions of the Estates Agents Act 1979

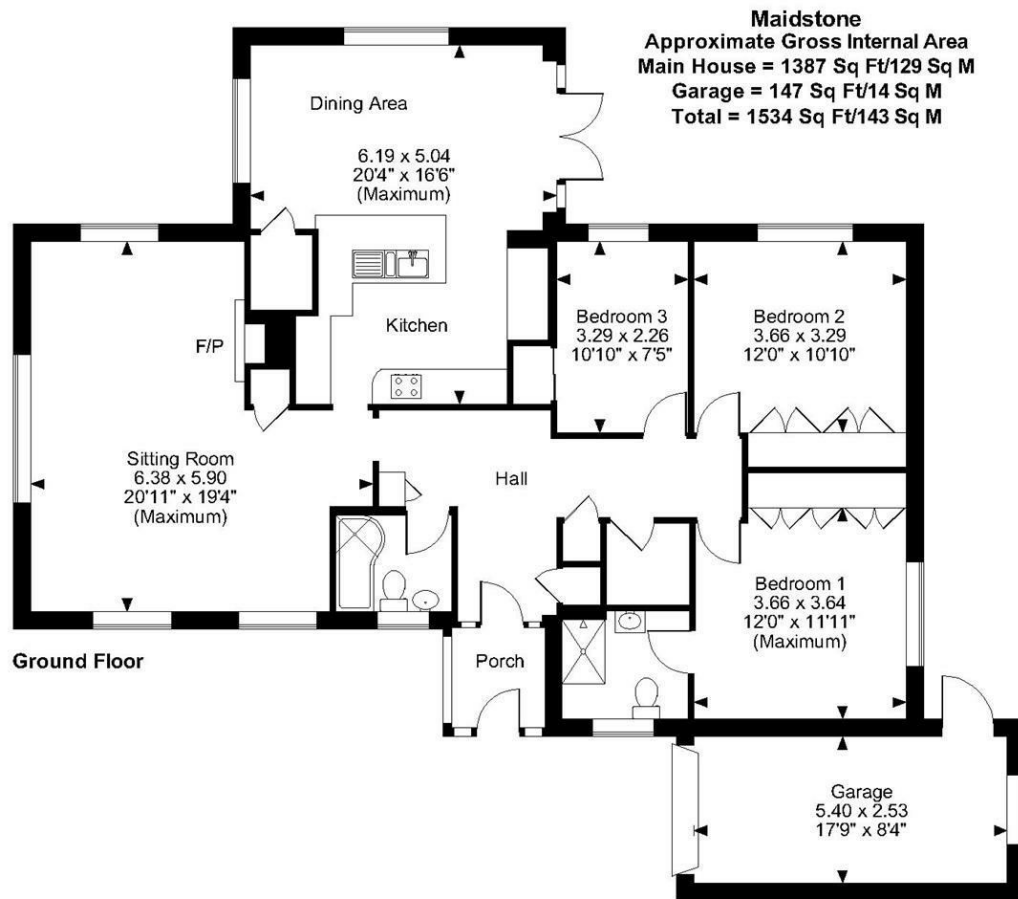

FOR ILLUSTRATIVE PURPOSES ONLY - NOT TO SCALE

The position & size of doors, windows, appliances and other features are approximate only.

© ehouse. Unauthorised reproduction prohibited. Drawing ref. dig/8585627/LCO

