



**13 Whiteheads Lane, Bearsted, Maidstone, Kent, ME14 4DE**  
**Offers In Excess Of £465,000**





An exceptionally spacious well-planned chalet style property situated in a highly sought after cul-de-sac close to the picturesque village green. The property was constructed approximately 50 years ago with a later addition and has the benefit of a recently fitted boiler and replacement double glazed windows throughout. On the ground floor, the property comprises a light and airy lounge looking out to the garden, a spacious dining room, well proportioned kitchen, double bedroom and a useful cloakroom. On the first floor, there is a good sized principal bedroom with the benefit of a modern en-suite, a family bathroom and 2 further bedrooms. Externally, the property offers beautifully maintained gardens, parking for up to 3 vehicles and a detached garage with power.

The village is served by a comprehensive range of excellent shops, schools, inns, restaurants, parish church and London line station. Maidstone, the county town of Kent, is some 3 miles distance. Tenure: Freehold. EPC Rating: C. Council Tax Band: C.



## ON THE GROUND FLOOR

### L-Shaped Entrance Hall

Double glazed door. Radiator.

### Cloakroom

White suite comprising wash hand basin. Low level WC. Radiator. Part tiled walls. Vinyl floor covering.

### Sitting Room

Radiator. Sliding double glazed patio doors to rear garden.

### Dining Room

Double glazed window. Radiator.

### Kitchen

Wooden doored units comprising stainless steel sink unit with cupboards and drawers under. Range of floor and wall cupboards. Floor to ceiling cupboard. Plumbing for washing machine and dishwasher. Part tiled walls. Radiator. Gas fired boiler for central heating and domestic hot water. Double glazed window overlooking rear garden. Stable door to side.

### Bedroom Four

Double glazed window. Radiator.

## ON THE FIRST FLOOR

### Landing

Approached by an attractive railed staircase. Double glazed window.

### Principal Bedroom

Double glazed window. Radiator.

### Shower Room En-suite

Suite comprising tiled shower enclosure. Wash hand basin with cupboard below. Low level WC. Radiator. Tiled walls. Vinyl floor covering.

### Bedroom Two

Double glazed window. Radiator.

### Bedroom Three

Double glazed window. Radiator.

### Spacious Shower Room

Shower enclosure. Low level WC. Wash hand basin. Heated towel rail. Double glazed window.

## EXTERNALLY

### Garage and Carport

An extensive drive providing parking facilities for numerous vehicles.

### Gardens

The property is situated on an attractive plot enjoying a high degree of seclusion. The FRONT GARDEN is

open plan and laid mainly to lawn with hedging. The REAR GARDEN has a depth of approximately 50' and is fully fenced and comprises extensive lawned area, shrubs and flower borders. Patio. Shed.

## VIEWING

Strictly by arrangement with the Agent's Bearsted Office, 132 Ashford Road, Bearsted, Maidstone, Kent ME14 4LX . Tel: 01622 739574.

## DIRECTIONS

From the Agent's Bearsted Office turn right into the A20 and immediately left into Yeoman Lane. Take the second turning on the right into Mount Lane and first left into Whiteheads Lane.

## Energy Efficiency Rating

	Current	Potential
<i>Very energy efficient - lower running costs</i>		
(92 plus) <b>A</b>		<b>87</b>
(81-91) <b>B</b>		
(69-80) <b>C</b>	<b>74</b>	
(55-68) <b>D</b>		
(39-54) <b>E</b>		
(21-38) <b>F</b>		
(1-20) <b>G</b>		
<i>Not energy efficient - higher running costs</i>		
<b>England &amp; Wales</b>	EU Directive 2002/91/EC	



**Whiteheads Lane, Bearsted, Maidstone, Kent**

**Approximate Gross Internal Area**

**Main House = 1059 Sq Ft/98 Sq M**

**Garage = 210 Sq Ft/20 Sq M**

**Shed = 41 Sq Ft/4 Sq M**

**Total = 1310 Sq Ft/122 Sq M**

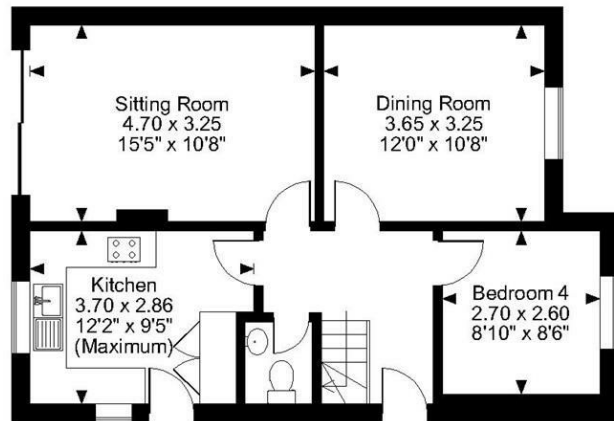
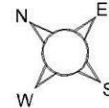

**Ground Floor**

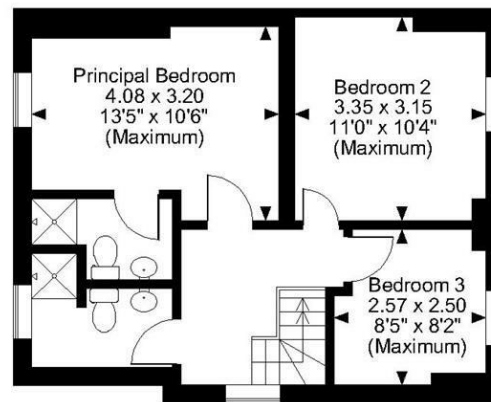

**First Floor**

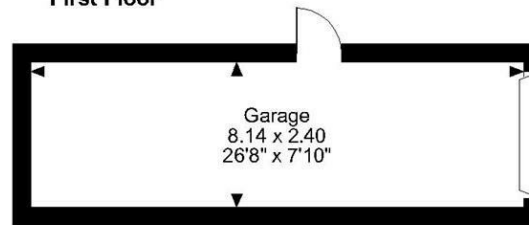
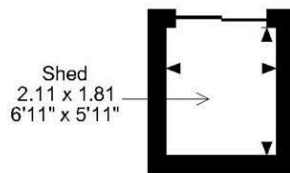

**FOR ILLUSTRATIVE PURPOSES ONLY - NOT TO SCALE**

The position & size of doors, windows, appliances and other features are approximate only.

© ehouse. Unauthorised reproduction prohibited. Drawing ref. dig/8567416/TOW

