



**Carterhatch Road, EN3 5LS**

£435,000

Freehold

**Castles**







## Carterhatch Road, EN3 5LS

A chain free 2/3 bedroom mid terraced older style family house located close to amenities on the Hertford Road in Enfield Highway, & within approximately 1m of Brimsdown train station (serving London Liverpool St and Tottenham Hale). The property is in good decorative order and offers spacious accommodation and internal viewing is highly recommended. Features include: double glazing, gas central heating, through lounge, fitted kitchen, south facing rear garden, ground floor family bathroom, en-suite shower room to bedroom 3, outbuilding with rear vehicle access (previously a garage).

EPC Rating: TBC

Council Tax Band: D

£435,000 Freehold

# Castles

020 8804 8000  
enfield@castles.london





### APPROXIMATE GROSS INTERNAL AREA

95.27 sqm / 1025.47 sqft

(Excluding Outbuilding / Workshop)

114.78 sqm / 1235.48 sqft (Including Outbuilding / Workshop)

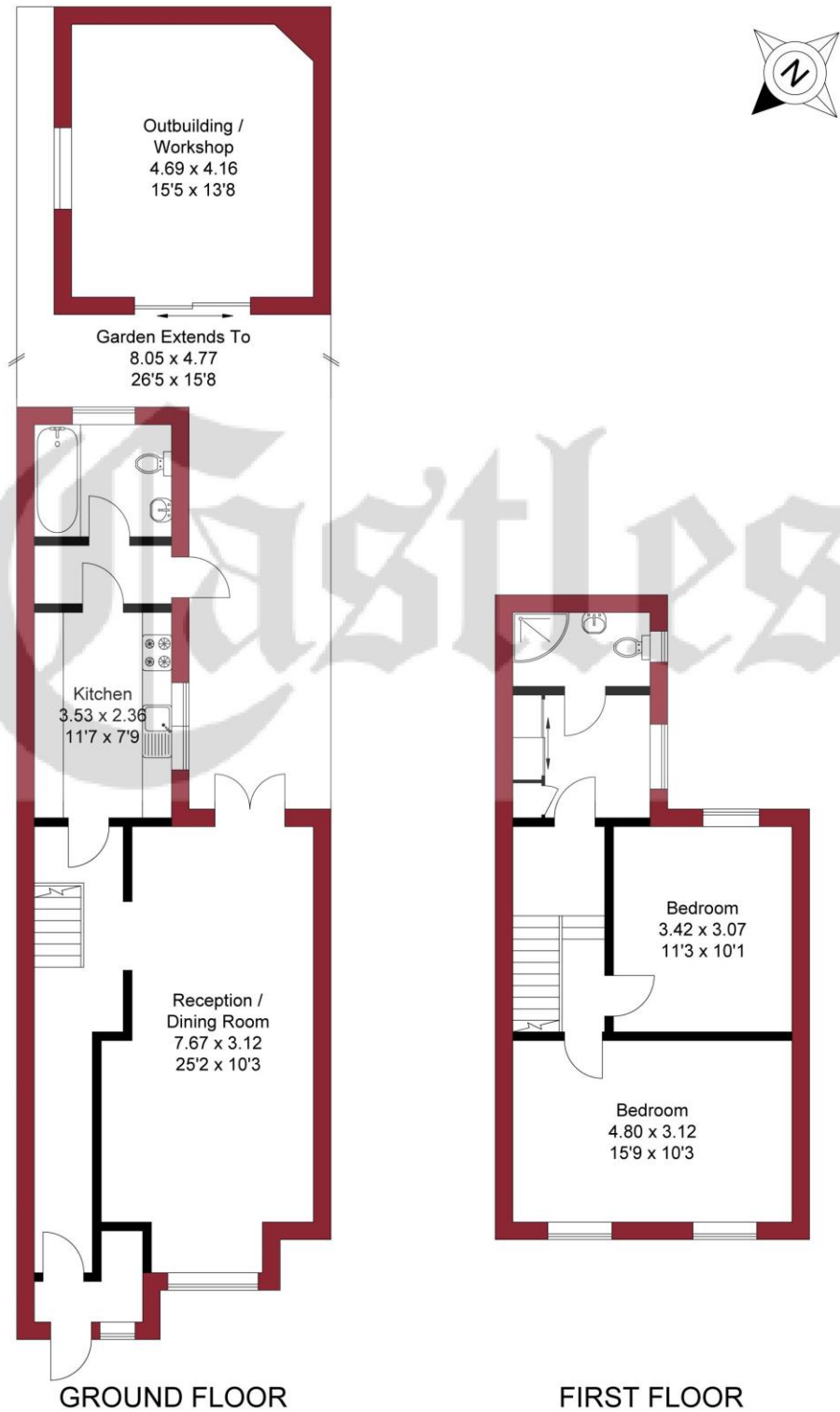

THIS PLAN IS FOR ILLUSTRATION ONLY AND MAY NOT BE REPRESENTATIVE OF THE PROPERTY

### An overview of Enfield

Enfield boasts a proud and distinguished history, home to several country houses and ancient monuments, the area also hosts a notable contingent of famous residents both past and present.

With affordable homes and a safe, green environment, Enfield attracts many buyers pleasantly surprised by the good value of property compared to some of the more pricey neighbouring boroughs.

On the lush, green perimeter of London, Enfield has excellent transport links with a quick and easy train journey into the City and West End.

There are a range of activities to keep residents busy in the borough with seven bustling shopping areas, 900 hectares of parks, three golf clubs, and numerous cinemas, theatres and museums. There is a diverse community residing in the area.

Notable for its range of great schools, vast green spaces and bustling retail centres, as well as good transport links to the rest of the city, Enfield is undoubtedly a thriving place to live and work and proves an excellent choice for first time buyers, families, young professionals and property investors alike."

# Castles

243-245 Hertford Road  
Enfield, EN3 5JJ  
0208 804 8000  
enfield@castles.london  
www.castles.london

All details including floorplans are for representation purposes only and do not constitute a contract or warranty. Whilst every effort is made to ensure accuracy of descriptions and measurements, no responsibility is taken for errors, omissions and misstatements.

rightmove  
find your happy

Zoopla  
Smarter property search

PrimeLocation  
Find the home you deserve

The Property Ombudsman

A free, fair and independent service for buyers, sellers, tenants and landlords of property in the UK.

NAEA  
National Association of Estate Agents  
LICENSED MEMBER