



Old Highway, Hoddesdon, EN11 0LS

£350,000

Freehold

Castles



Old Highway, Hoddesdon, EN11 0LS

An immaculately presented chain free Victorian property located on a desirable location within a short distance of Rye House train station. This property boasts 2 great size bedrooms and a large garden and would be ideal for a first time buyer or a buy to let investment. Features include: 2 double bedrooms, double glazing (untested), large rear garden, close to Rye House train station, close to Rye Park, ground floor bathroom.

EPC Rating: C
Current: 70 Potential: 90

Council Tax Band: C



£350,000 Freehold

Castles

020 8804 8000
enfield@castles.london



APPROXIMATE GROSS INTERNAL AREA
60.13 sqm / 647.23 sqft

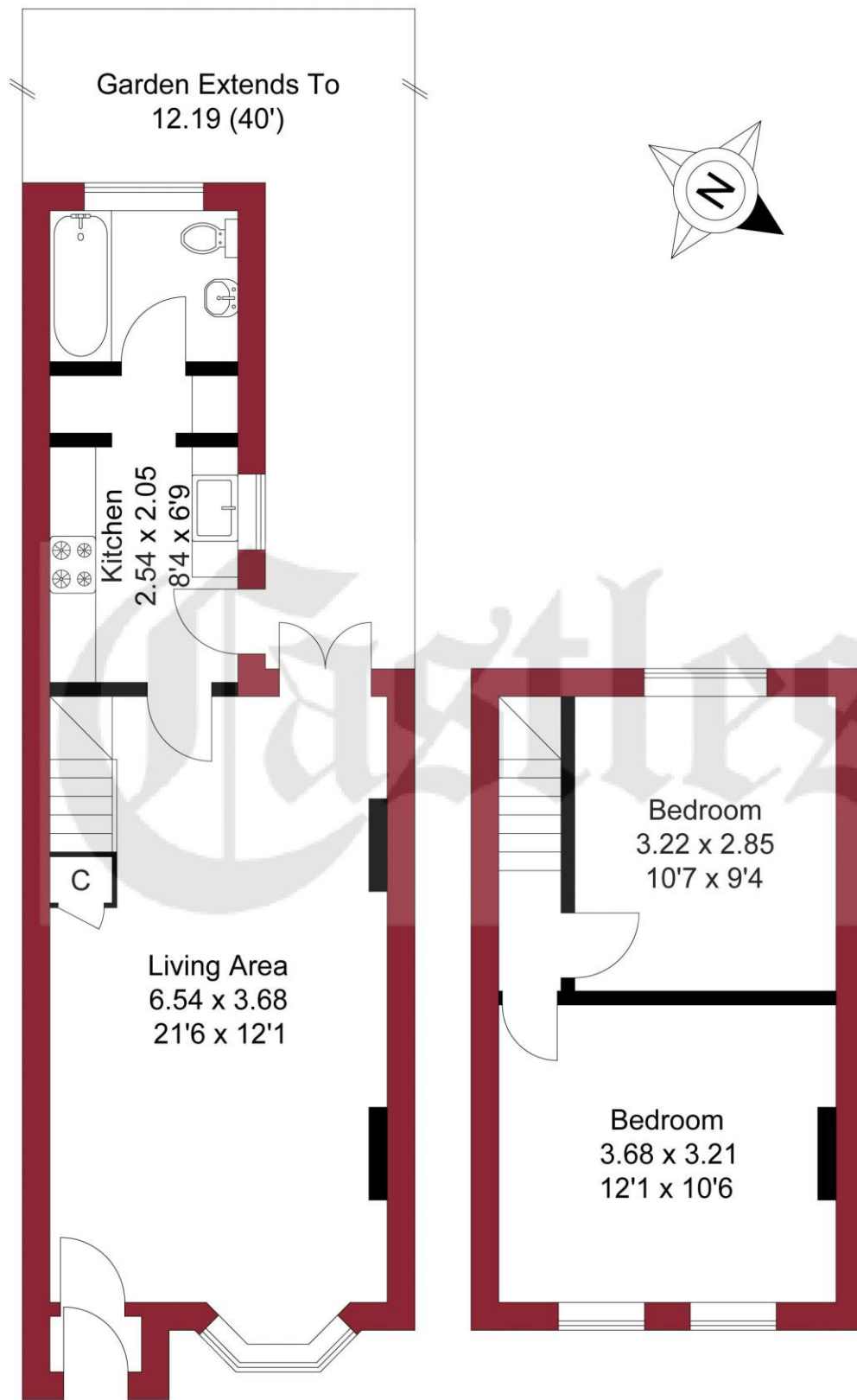

GROUND FLOOR

FIRST FLOOR

THIS PLAN IS FOR ILLUSTRATION ONLY AND MAY NOT BE REPRESENTATIVE OF THE PROPERTY

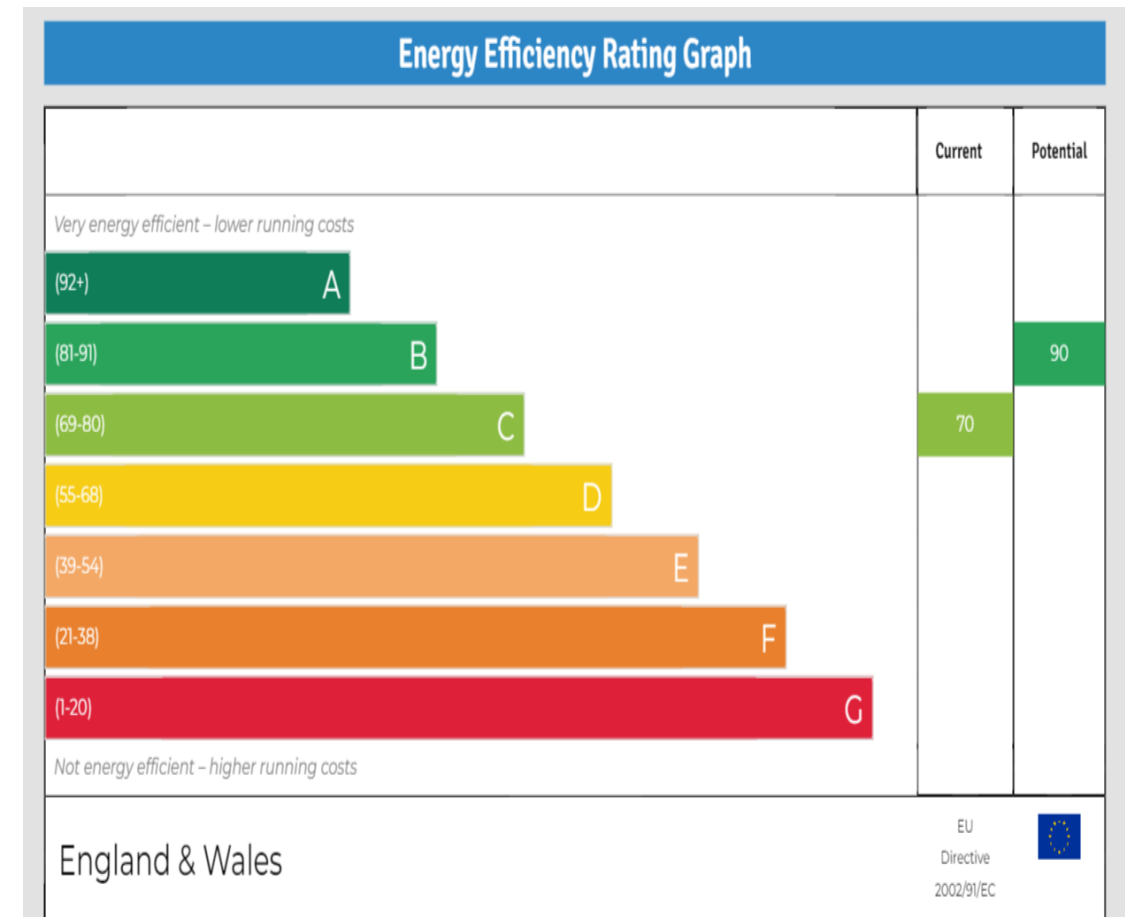

Castles

243-245 Hertford Road
Enfield, EN3 5JJ
0208 804 8000
enfield@castles.london
www.castles.london

All details including floorplans are for representation purposes only and do not constitute a contract or warranty. Whilst every effort is made to ensure accuracy of descriptions and measurements, no responsibility is taken for errors, omissions and misstatements.

rightmove
find your happy

Zoopa
Smarter property search

PrimeLocation
Find the home you deserve

The Property Ombudsman

A free, fair and independent service for buyers, sellers, tenants and landlords of property in the UK.

NAEA
National Association of Estate Agents
LICENSED MEMBER