



Castles

ASKING PRICE

£600,000

The Broadway

Crouch End, N8 8DR

Castles

PROPERTY SUMMARY

Set within a prestigious development in the heart of one of London's premier urban villages, is this contemporary, two-bedroom, second floor apartment. With Crouch End Broadway on your doorstep offering a variety of eateries and retailers and providing a multitude of local bus routes to nearby Archway and Finsbury Park stations.

The property offers an abundance of natural light and space and further comprises open-planned kitchen/reception, en-suite to principal bedroom and additional family bathroom. Further benefits from front and rear access, internal elevator, allocated parking and generous communal terrace (currently under re-construction).

Local Authority: Haringey
Council Tax band: E

Lease: 976 years from (09 August 3001)
Current Service/Maintenance Charge: £3760.00 per annum
Ground Rent: £100.00 per annum

Nb. The Service Charge, Ground Rent and Leasehold information stated has been confirmed by our vendor





Village Apartments, N8 Approximate Gross Internal Area = 862 sq ft / 80.1 sq m

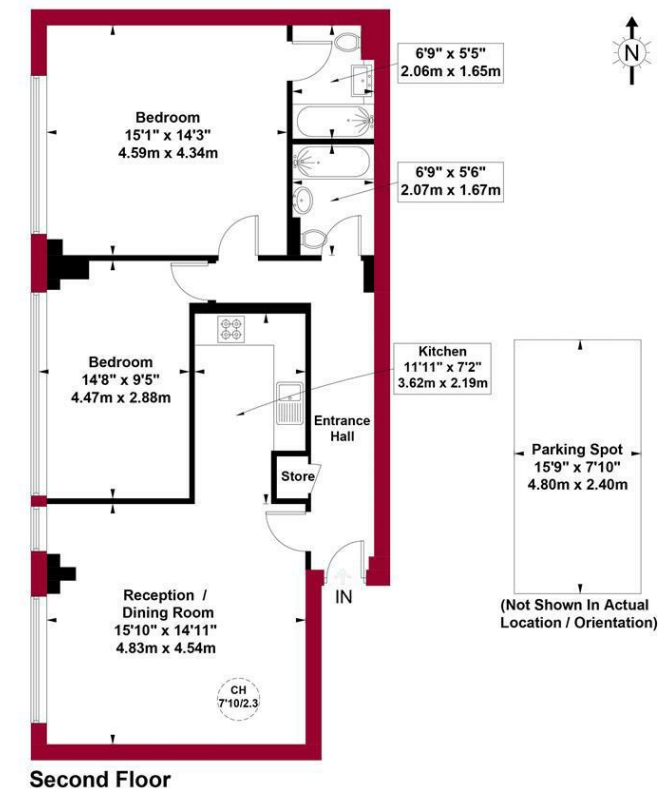

This plan is for layout guidance only and is not drawn to scale unless stated. All dimensions, including windows, doors, and the Total Gross Internal Area (GIA), are approximate. For precise measurements, please consult a qualified architect or surveyor before making any decisions based on this plan.



For a guide to the area
please scan this code for
more information



Flat - Second Floor

Leasehold

Council:

Council Tax Band: E

Lease Remaining: n/a

Service Charge: n/a

Ground Rent: n/a

Agents Note: Whilst every care has been taken to prepare these particulars, they are for guidance purposes only. All measurements are approximate and are for general guidance purposes only and whilst every care has been taken to ensure their accuracy, they should not be relied upon and potential buyers/tenants are advised to recheck the measurements



OFFICE ADDRESS

12 Topsfield Parade
Crouch End
London
N8 8PR

OFFICE DETAILS

020 8348 5515
crouchend@castles.london
<https://www.castles.london>

