



Castles

OFFERS IN EXCESS OF

£409,950

St. Andrew's Road

Edmonton, N9 8BY

PROPERTY SUMMARY

A three bedroom 1930's Terraced property situated on this quiet location. The property comprises of through lounge, kitchen, rear garden with a further three bedrooms, bathroom to first floor, double glazed windows and gas central heating. The property is offered for sale on a chain free basis.





APPROXIMATE GROSS INTERNAL AREA
71.98 sqm / 774.78 sqft

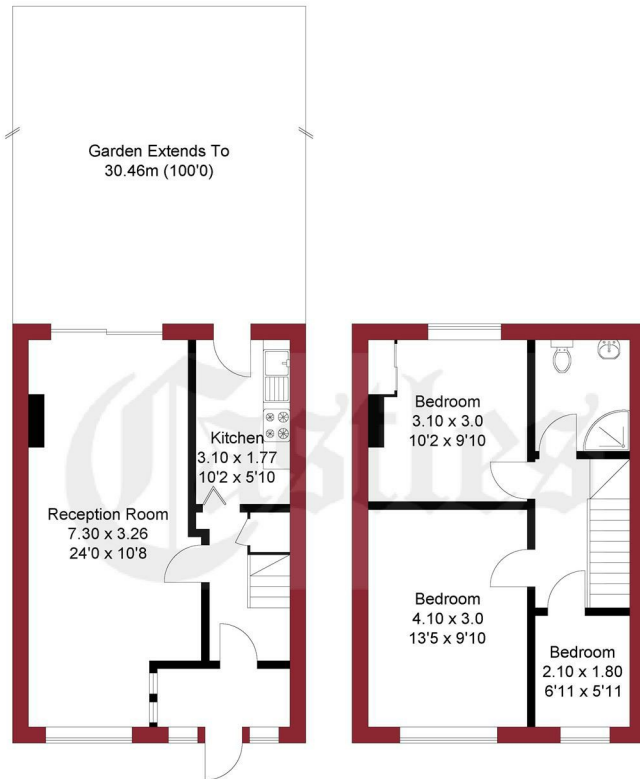

GROUND FLOOR

FIRST FLOOR

THIS PLAN IS FOR ILLUSTRATION ONLY AND MAY NOT BE
REPRESENTATIVE OF THE PROPERTY

For a guide to the area
please scan this code for
more information

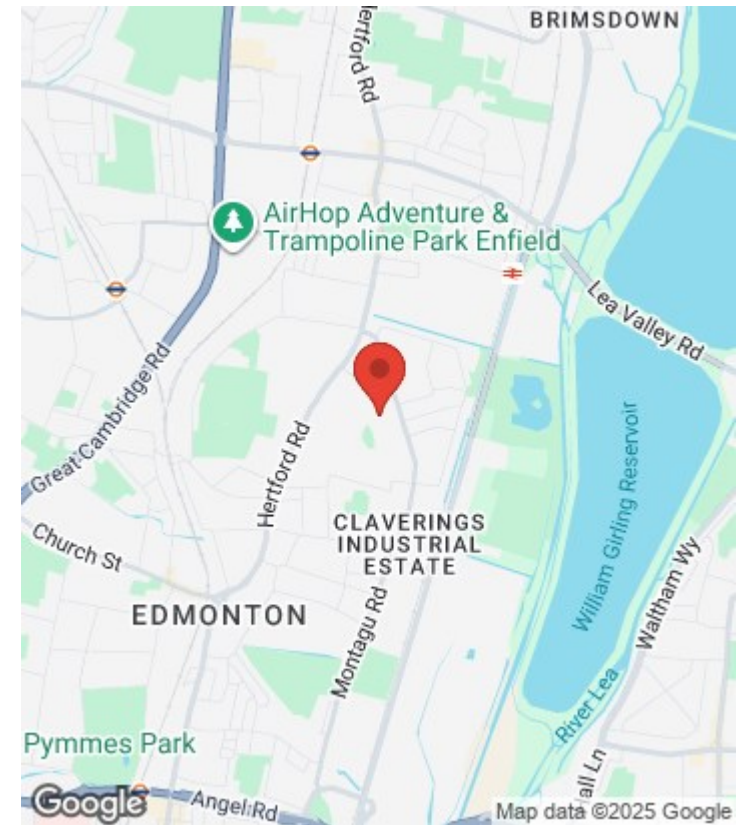

House

Freehold

Council:

Council Tax Band: C

Agents Note: Whilst every care has been taken to prepare these particulars, they are for guidance purposes only. All measurements are approximate and are for general guidance purposes only and whilst every care has been taken to ensure their accuracy, they should not be relied upon and potential buyers/tenants are advised to recheck the measurements



OFFICE ADDRESS

438 Hertford Road
Edmonton
London
N9 8AB

OFFICE DETAILS

020 8804 8123
edmonton@castles.london
<https://www.castles.london/>

