



Castles

OFFERS IN EXCESS OF
£199,950
Bury Street
Edmonton, N9 7LE

PROPERTY SUMMARY

We are please to offer for sale this one bedroom ground floor grade 2 listed Apartment situated within 1/2 mile of Edmonton Green, The property comprises of 16ft bedroom, 24ft lounge/kitchen area and bathroom. The property is situated within a church with spiral staircase to upper floor. It is offered on a chain free basis, comes with share of freehold and a 125 year lease

All information has been provided and confirmed by the owner

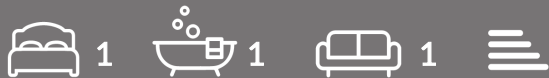



APPROXIMATE GROSS INTERNAL AREA
48.82 sqm / 525.49 sqft

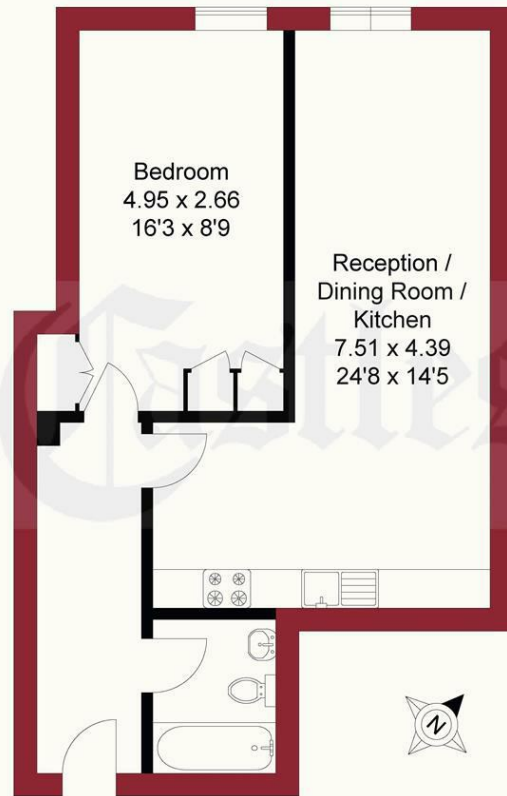

THIS PLAN IS FOR ILLUSTRATION ONLY AND MAY NOT BE
REPRESENTATIVE OF THE PROPERTY

For a guide to the area
please scan this code for
more information

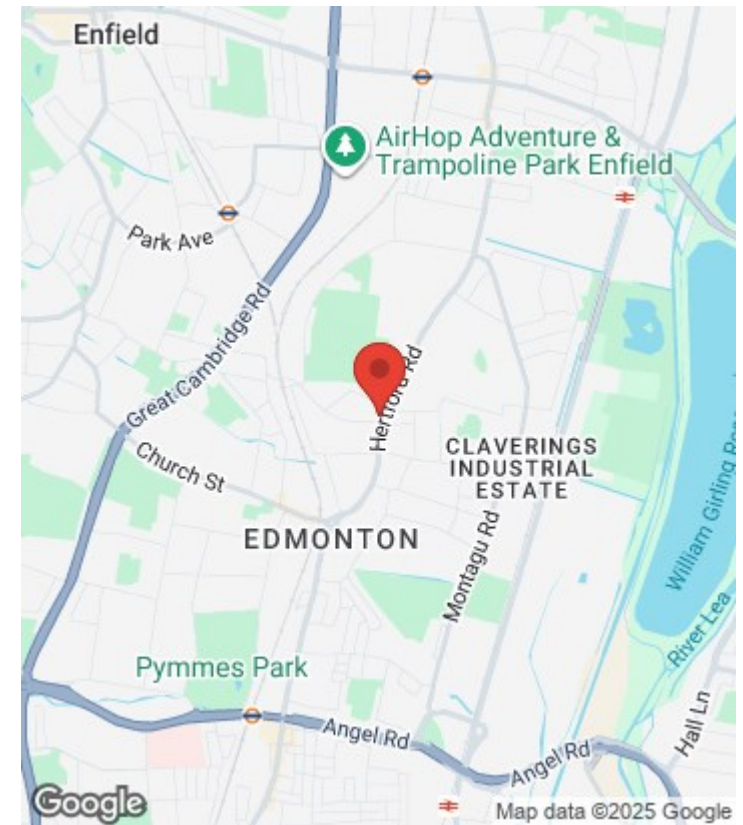

Flat - Ground Floor

Leasehold - Share of Freehold

Council:

Council Tax Band: B

Agents Note: Whilst every care has been taken to prepare these particulars, they are for guidance purposes only. All measurements are approximate and are for general guidance purposes only and whilst every care has been taken to ensure their accuracy, they should not be relied upon and potential buyers/tenants are advised to recheck the measurements



OFFICE ADDRESS

438 Hertford Road
Edmonton
London
N9 8AB

OFFICE DETAILS

020 8804 8123
edmonton@castles.london
<https://www.castles.london/>

Energy Efficiency Rating		Current	Potential
Very energy efficient - lower running costs			
92-100	A		
81-91	B		
69-80	C		
55-68	D		
39-54	E		
21-38	F		
1-20	G		
Not energy efficient - higher running costs			
England & Wales			
EU Directive 2002/91/EC			