



Everything you need to know about:

**Lodge Court,
Staining, Blackpool,
FY3 0EH**



Introduction



The Property



Local Authority



Transport Links

Education



Health



Local Policing





An invaluable insight into your new home

This i-PACK brochure offers an informed overview of **Lodge Court** as a potential new home, along with essential material about its surrounding area and its local community. It provides a valuable insight for any prospective owner or tenant.

We wanted to provide you with information that you can absorb quickly, so we have presented it as visually as possible, making use of maps, icons, tables, graphs and charts. Overall, the brochure contains information about:

- **The Property** - including property details, floor plans, room details, photographs and Energy Performance Certificate.
- **Transport** - including locations of bus and coach stops, railway stations and ferry ports.
- **Health** - including locations, contact details and organisational information on the nearest GPs, pharmacies, hospitals and dentists.
- **Local Policing** - including locations, contact details and information about local community policing and the nearest police station, as well as police officers assigned to the area.
- **Education** - including locations of infant, primary and secondary schools and Key Performance Indicators (KPIs) for each key stage.





LODGE COURT, BLACKPOOL £199,950



x3
Bedrooms



x2
Living Rooms



x1
Bathrooms

Where you are

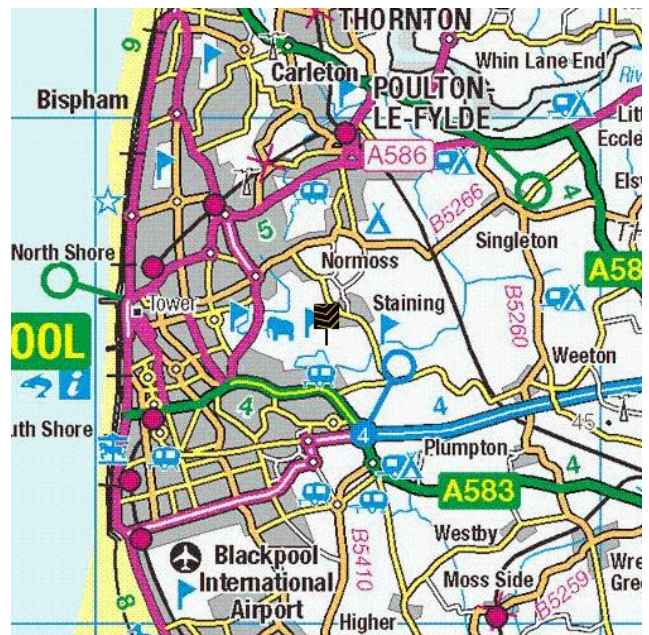
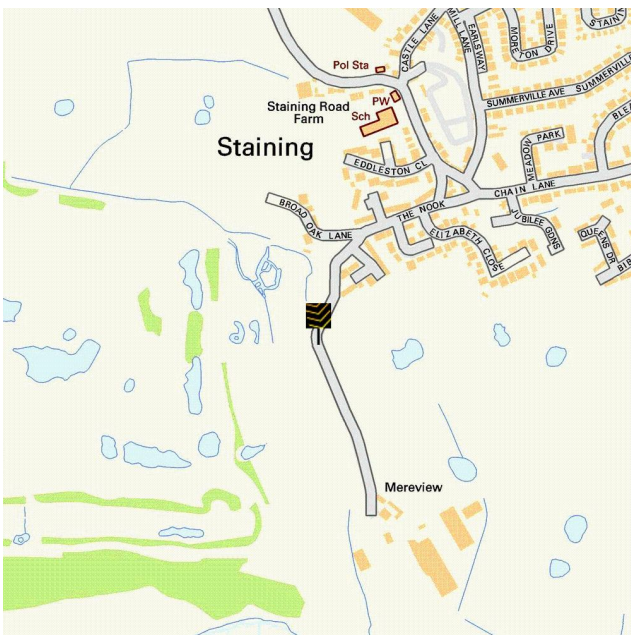





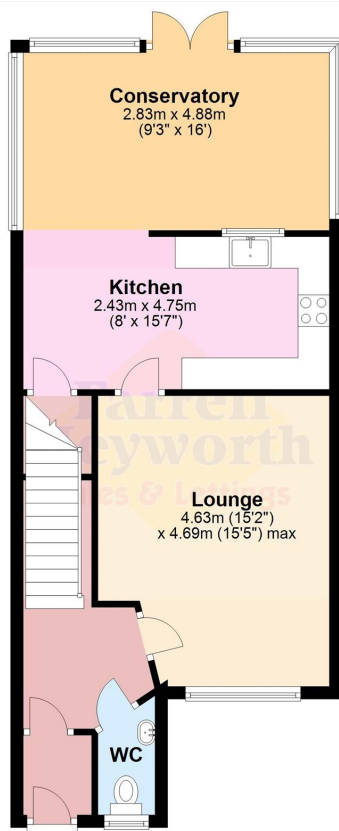

Ground Floor

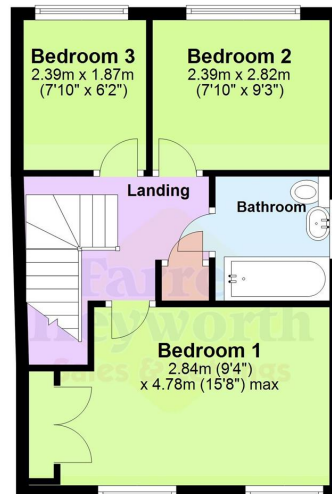

First Floor





Everything you want
to know about
local authorities





Get to know your local authorities

Local government directly affects quality of life, particularly when it comes to council tax, planning, waste disposal and the impact of local policies. You may want to investigate how this is likely to affect you if you decide to move. There are nearly 400 local authorities in England, with five different types of local government structure. These can be broadly divided into **single-tier** and **two-tier authorities**. Single-tier authorities are **Metropolitan Authorities, London Boroughs** and **Unitary or Shire Authorities**. Two-tier authorities have both a **County Council**, and a **District Council or City Council**. There are also around 10,000 parish and town councils, effectively creating an additional tier in some areas - mostly, but not exclusively, in rural areas. The National Association of Local Councils (NALC) represents and works on behalf of these community councils and is a useful contact point.

The local authority locations and contact details for **Lodge Court** are:

| Shire / County / District | Website | Address | Contact details |
|---------------------------|---------|---------|-----------------|
|---------------------------|---------|---------|-----------------|

Disclaimer: The information displayed above has been obtained using the property's postcode in proximity to its local authority. It is recommended that this information is independently verified.



Everything you want
to know about
transport links







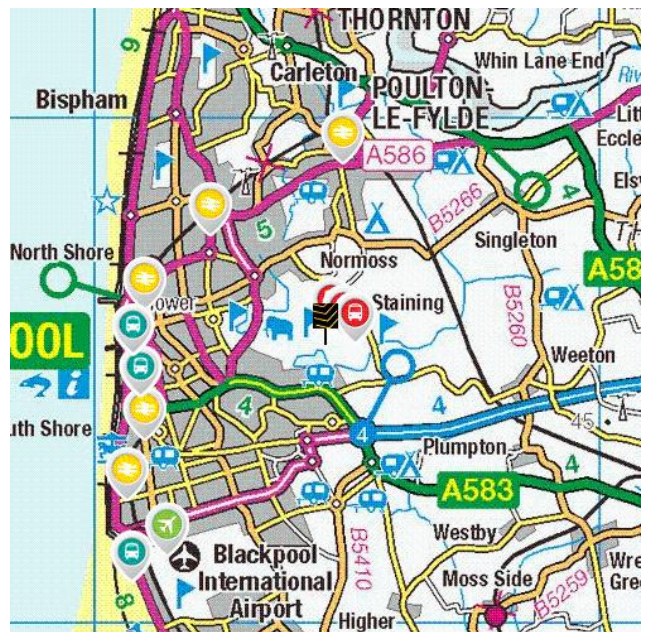
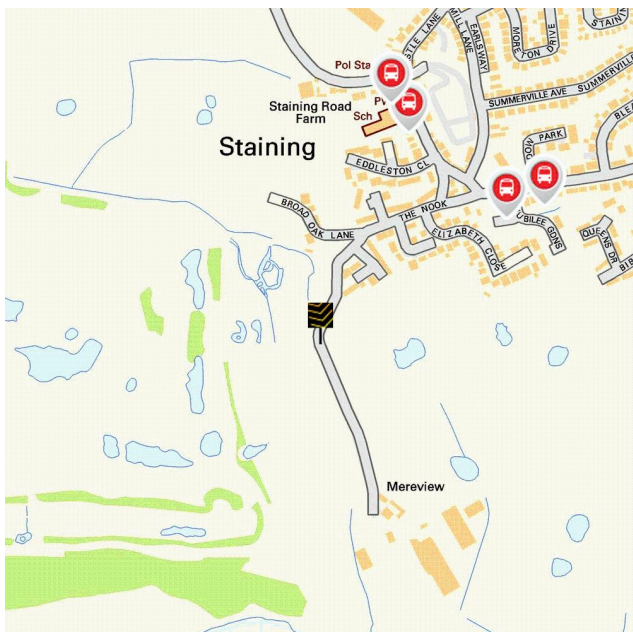

Become familiar with public transport links

Being able to choose to travel by public transport is important for many reasons. It helps to reduce congestion, provides access to work and education, and facilitates use of health and leisure facilities. If you or your family members travel abroad, access to the nearest ferry terminals is also likely to be a significant factor in choosing a new property. Using the maps below, you can pinpoint the precise locations of transport links for **Lodge Court**. Tables for each type of transport indicate the property's distance from the nearest bus stops, railway stations, coach stops and ferry terminals (providing that these facilities are within the scale proximity of the maps.)

Transport Links



| | Airports | Approx Distance |
|--|---------------------------------------|-----------------|
|  | Blackpool International Airport | 3.21 miles |
| | Liverpool John Lennon Airport | 33.47 miles |
| | Manchester Airport | 43.12 miles |
| | Ferry ports | Approx Distance |
|  | Fleetwood for Knott End Ferry Landing | 7.77 miles |
| | Knott End-On-Sea Ferry Landing | 7.82 miles |
| | Heysham Ferry Terminal | 15.45 miles |
| | Piel Island Ferry Landing | 18.65 miles |
| | Roa Island Ferry Landing | 19.26 miles |
| | Train Stations | Approx Distance |
|  | Layton (Lancs) Rail Station | 1.99 miles |
| | Blackpool North Rail Station | 2.27 miles |
| | Poulton-le-Fylde Rail Station | 2.3 miles |
| | Blackpool South Rail Station | 2.49 miles |
| | Blackpool Pleasure Beach Rail Station | 3.06 miles |

Disclaimer: The information represented in this section has been sourced from the Department of Transport's Open Data and is based on the property's postcode. It is recommended that this information is independently verified.



Farrell Heyworth Landmark House 5a Cleveleys Avenue, Thornton-Cleveleys, FY5 2UH **01253 886000**

| | Bus Stops | Approx Distance |
|---|---|-----------------|
|  | Meadow Park | 0.22 miles |
| | Primary School | 0.23 miles |
| | Castle Lane | 0.25 miles |
| | Meadow Park | 0.26 miles |
| | Bibby Drive | 0.37 miles |
| | Coach Stops | Approx Distance |
|  | Blackpool: Lonsdale Coach Park | 2.35 miles |
| | Blackpool: Central Coach Station | 2.37 miles |
| | Blackpool: Pontins Coach Stop | 3.73 miles |
| | St Annes-on-the-Sea: Ashton Gdns Coach Stop | 4.72 miles |
| | Ansdell Coach Stop | 5.22 miles |

Disclaimer: The information represented in this section has been sourced from the Department of Transport's Open Data and is based on the property's postcode. It is recommended that this information is independently verified.



Farrell Heyworth Landmark House 5a Cleveleys Avenue, Thornton-Cleveleys, FY5 2UH **01253 886000**



Everything you want
to know about
local schools





How are local schools performing?

If schools are important to you, then this section sets out the published Key Performance Indicators for schools near to your prospective new home. Key Performance Indicators look primarily at how well pupils perform in their tests and examinations, as well as some other measures like attendance.

If you want to know more about a particular school or college, you can also visit the Ofsted website <http://www.ofsted.gov.uk/inspection-reports/find-inspection-report>

Local Schools

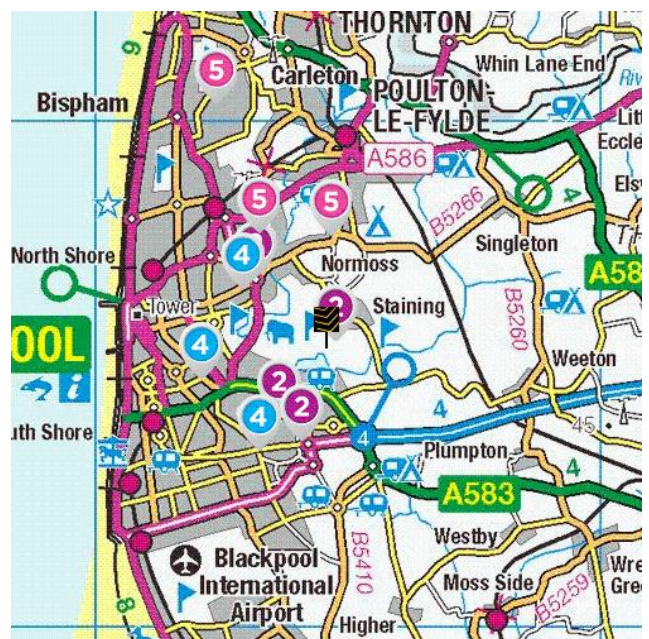
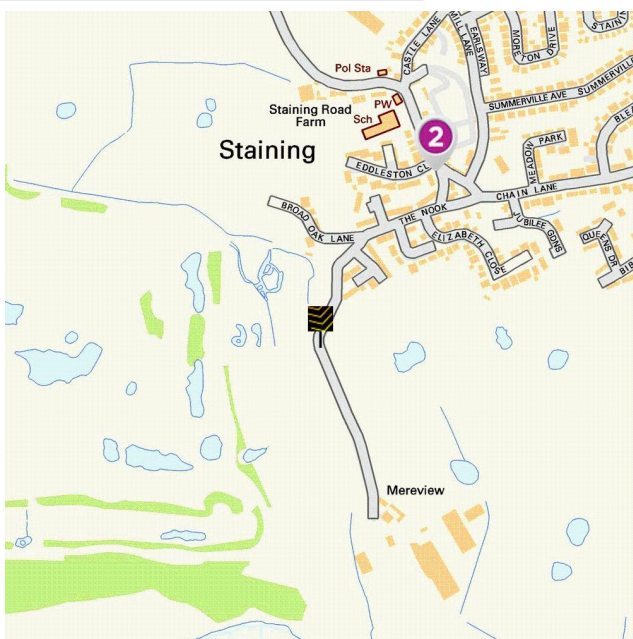

The next page shows tables and charts divided into Key Stages and a list of respective schools local to **Lodge Court**. There are four main age-related Key Stages defined as:



Special schools are marked with this icon

| Key Stage | Definition |
|-------------|---|
| Key Stage 1 | Fits broadly with the first stage of education, i.e. ages 5-7. |
| Key Stage 2 | Fits the later stage of primary education, often known as junior schools, i.e. ages 8-11. This takes pupils up to the standardised break at age 11 after which pupils generally change schools and transfer to secondary education. |
| Key Stage 3 | Secondary education split between key stages 3 and 4, with key stage 3 covering ages 11-13. |
| Key Stage 4 | Key Stage 4 (ages 14-16) covers the two year period of study for GCSE level examinations. |
| Key Stage 5 | Beyond key stage 4 is 16+ or Sixth Form provision, sometimes unofficially referred to as Key Stage 5. |



Farrell Heyworth Landmark House 5a Cleveleys Avenue, Thornton-Cleveleys, FY5 2UH **01253 886000**

| | Key Stage 2 - Information | Approx Distance |
|---|--|-----------------|
|  | <p>Name: Staining Church of England Voluntary Controlled Primary School Address: Staining Road, Blackpool, FY3 0BW Contact Number: 01253882983 Age Range: 4-11 yrs Local Education Authority: Lancashire Religious Character: Church of England</p> | 0.21 miles |
| | <p>Name: Stanley Primary School Address: Wordsworth Avenue, Blackpool, FY3 9UT Contact Number: 01253761022 Age Range: 4-11 yrs Local Education Authority: Blackpool Religious Character: Does not apply</p> | 0.94 miles |
| | <p>Name: Mereside Primary School Address: Langdale Road, Blackpool, FY4 4RR Contact Number: 01253761531 Age Range: 3-11 yrs Local Education Authority: Blackpool Religious Character: Does not apply</p> | 1.1 miles |
| | <p>Name: Boundary Primary School Address: Dinmore Avenue, Blackpool, FY3 7RW Contact Number: 01253287250 Age Range: 3-11 yrs Local Education Authority: Blackpool Religious Character: Does not apply</p> | 1.3 miles |
| | <p> Name: Park Community Academy Address: 158 Whitegate Drive, Blackpool, FY3 9HF Contact Number: 01253764130 Age Range: 2-19 yrs Local Education Authority: Blackpool Religious Character: Does not apply</p> | 1.57 miles |

Disclaimer: The information represented in this section has been sourced from the Department of Education's 2019 results data s and is based on the property's postcode.



Reading, Writing and Maths

| | Name | Expected | Higher |
|---|--|---------------|---------------|
| 2 | Staining Church of England Voluntary Controlled Primary School | 71.0 % | 0.0 % |
| | Stanley Primary School | 67.0 % | 7.0 % |
| | Mereside Primary School | 79.0 % | 0.0 % |
| | Boundary Primary School | 75.0 % | 12.0 % |
| | Park Community Academy | 0.0 % | 0.0 % |
| | Lancashire | 64.0 % | 10.0 % |
| | National | 65.0 % | 11.0 % |

Primary Progress Measures

As well as actual pupil performance in tests and exams an important Key Performance Indicator is that of progress measures that compare the actual achievements of other pupils nationally with similar prior attainment. Any increase in attainment achieved by each pupil will be reflected in the schools progress scores. They are fairer to schools in challenging circumstances, as they recognise a school that is doing a good job with an intake with poor prior attainment



Progress Measures for 2019

| | Name | Math | Reading | Writing |
|---|--|--------|---------|---------|
| 2 | Staining Church of England Voluntary Controlled Primary School | 1.9 % | -1.2 % | 0.4 % |
| | Stanley Primary School | 2.2 % | 0.1 % | 0.1 % |
| | Mereside Primary School | 5.1 % | 8.0 % | 2.4 % |
| | Boundary Primary School | 3.7 % | 3.7 % | 0.9 % |
| | Park Community Academy | -8.7 % | -8.9 % | -8.3 % |

Disclaimer: The information represented in this section has been sourced from the Department of Education's 2019 results data set and is based on the property's postcode.



Farrell Heyworth Landmark House 5a Cleveleys Avenue, Thornton-Cleveleys, FY5 2UH **01253 886000**

| | Key Stage 4 - Information | Approx Distance |
|---|---|-----------------|
|  | <p>Name: St Mary's Catholic Academy Address: St Walburga's Road, Blackpool, FY3 7EQ Contact Number: 01253396286 Age Range: 11-18 yrs Local Education Authority: Blackpool Religious Character: Roman Catholic</p> | 1.32 miles |
| | <p>Name: St George's School A Church of England Academy Address: Cherry Tree Road, Blackpool, FY4 4PH Contact Number: 01253316725 Age Range: 11-16 yrs Local Education Authority: Blackpool Religious Character: Church of England</p> | 1.44 miles |
| | <p>Name: Baines School Address: Highcross Road, Poulton-le-Fylde, FY6 8BE Contact Number: 01253883019 Age Range: 11-16 yrs Local Education Authority: Lancashire Religious Character: None Admission Policy: Comprehensive</p> | 1.46 miles |
| | <p> Name: Woodlands School Address: Whitegate Drive, Blackpool, FY3 9HF Contact Number: 01253316722 Age Range: 2-19 yrs Local Education Authority: Blackpool Religious Character: Does not apply</p> | 1.57 miles |
| | <p> Name: Park Community Academy Address: 158 Whitegate Drive, Blackpool, FY3 9HF Contact Number: 01253764130 Age Range: 2-19 yrs Local Education Authority: Blackpool Religious Character: Does not apply</p> | 1.57 miles |

Disclaimer: The information represented in this section has been sourced from the Department of Education's 2019 results data and is based on the property's postcode.



Percentage of pupils achieving 5+ A*-C/9-4 or equivalents including 9-4 in both English and mathematics GCSEs

| | Name | 2019 | 2018 | 2017 | 2016 |
|---|--|--------|--------|--------|--------|
| 4 | St Mary's Catholic Academy | 60.0 % | 63.0 % | 55.0 % | 55.0 % |
| | St George's School A Church of England Academy | 69.0 % | 59.0 % | 44.0 % | 50.0 % |
| | Baines School | 66.0 % | 72.0 % | 60.0 % | 62.0 % |
| | Woodlands School | N/A | N/A | N/A | N/A |
| | Park Community Academy | 0.0 % | 0.0 % | 0.0 % | 0.0 % |
| | Blackpool | 48.0 % | 47.3 % | 45.5 % | 43.0 % |
| | National | 60.0 % | 59.4 % | 56.6 % | 53.5 % |

Disclaimer: The information represented in this section has been sourced from the Department of Education's 2017 results data set and is based on the property's postcode.

Average number of GCSE entries per pupil

| | Name | Number |
|---|--|--------|
| 4 | St Mary's Catholic Academy | 7.8 |
| | St George's School A Church of England Academy | 7.3 |
| | Baines School | 8.1 |
| | Woodlands School | N/A |
| | Park Community Academy | 0.3 |
| | Blackpool | 6.8 |
| | National | 7.1 |

Disclaimer: The information represented in this section has been sourced from the Department of Education's 2019 results data set and is based on the property's postcode.



| | Key Stage 5 - Information | Approx Distance |
|---|---|-----------------|
|  | <p>Name: Baines School Address: Highcross Road, Poulton-le-Fylde, FY6 8BE Contact Number: 01253883019 Age Range: 11-16 yrs Local Education Authority: Lancashire Religious Character: None Admission Policy: Comprehensive</p> | 1.46 miles |
| | <p>Name: The Blackpool Sixth Form College Address: Highfurlong, Blackpool, FY3 7LR Contact Number: 01253394911 Age Range: 16+ yrs Local Education Authority: Blackpool Religious Character: Does not apply Admission Policy: Not applicable</p> | 1.72 miles |
| | <p>Name: Blackpool and the Fylde College Address: Ashfield Road, Blackpool, FY2 0HB Contact Number: 01253352352 Age Range: 16+ yrs Local Education Authority: Blackpool Religious Character: Does not apply Admission Policy: Not applicable</p> | 3.36 miles |
| | <p>Name: Lytham St Annes High School Address: Worsley Road, Lytham St Annes, FY8 4DG Contact Number: 01253733192 Age Range: 11-16 yrs Local Education Authority: Lancashire Religious Character: Does not apply</p> | 4.74 miles |
| | <p>Name: The St Anne's College Grammar School Address: 293 Clifton Drive South, Lytham St Annes, FY8 1HN Contact Number: 01253725815 Age Range: 2-19 yrs Local Education Authority: Lancashire Religious Character: None</p> | 4.81 miles |

Disclaimer: The information represented in this section has been sourced from the Department of Education's 2019 results data set and is based on the property's postcode.



Percentage of A level students achieving at least three levels at grades AAB or better, at least two of which are in facilitating subjects

| | Name | % |
|---|--------------------------------------|---------------|
| 5 | Baines School | N/A |
| | The Blackpool Sixth Form College | 9.1 % |
| | Blackpool and the Fylde College | N/A |
| | Lytham St Annes High School | N/A |
| | The St Anne's College Grammar School | N/A |
| | Lancashire | 15.1 % |
| | National | 16.5 % |

Disclaimer: The information represented in this section has been sourced from the Department of Education's 2019 results data set and is based on the property's postcode.

As well as actual pupil performance in tests and exams, an important Key Performance Indicator is that of Value Added. When pupils start a school, they all have varying levels of ability and social advantage. A school's Value Added score measures how much progress they have made from the beginning to the end of their compulsory secondary education (i.e. between the end of Key Stage 2 and the end of Key Stage 4). It is a quick measurement of the effect of a school on its pupils.

| | Name | Value Added |
|---|--------------------------------------|-------------|
| 5 | Baines School | N/A |
| | The Blackpool Sixth Form College | 0.0 |
| | Blackpool and the Fylde College | N/A |
| | Lytham St Annes High School | N/A |
| | The St Anne's College Grammar School | N/A |



Farrell Heyworth Landmark House 5a Cleveleys Avenue, Thornton-Cleveleys, FY5 2UH **01253 886000**



Everything you want
to know about
local health services





How local are the health services?

We all want good access to local health facilities, wherever we live. To see how well **Lodge Court** is served, we have set out below the exact locations of hospitals, Accident & Emergency centres, GPs, pharmacies, dentists, out-of-hours medical care and walk-in clinics. Where it's available, you will find more detailed information, including the names of practitioners and their contact details.

| Hospitals | Approx Distance | |
|-----------|--|-------------|
| | Blackpool Victoria Hospital, Whinney Heys Road, Blackpool, Lancashire, FY3 8NR | 0.95 miles |
| | Royal Preston Hospital, Sharoe Green Lane North, Preston, Lancashire, PR2 9HT | 11.83 miles |
| | Southport And Formby District General Hospital, Southport, Merseyside, PR8 6PN | 12.56 miles |
| | Royal Lancaster Infirmary, Ashton Road, Lancaster, Lancashire, LA1 4RP | 17.62 miles |
| | Chorley And South Ribble Hospital, Chorley and South Ribble Hospital, Chorley, Lancashire, PR7 1PP | 17.9 miles |
| A&E | Approx Distance | |
| | Blackpool Victoria Hospital, Whinney Heys Road, Blackpool, Lancashire, FY3 8NR | 0.95 miles |
| | Royal Preston Hospital, Sharoe Green Lane North, Preston, Lancashire, PR2 9HT | 11.83 miles |
| | Southport And Formby District General Hospital, Southport, Merseyside, PR8 6PN | 12.56 miles |
| | Royal Lancaster Infirmary, Ashton Road, Lancaster, Lancashire, LA1 4RP | 17.62 miles |
| | Chorley And South Ribble Hospital, Chorley and South Ribble Hospital, Chorley, Lancashire, PR7 1PP | 17.9 miles |

| Walk-in Clinics | | Approx Distance |
|---|--|-----------------|
|  | Blackpool Victoria Hospital, Whinney Heys Road, Blackpool, Lancashire, FY3 8NR | 0.95 miles |
| | Blackpool Nhs Walk-in Centre, Whitegate Health Centre, Blackpool, Lancashire, FY3 9ES | 1.63 miles |
| | Same Day Health Centre – Fleetwood, Same Day Health Centre, Fleetwood, Lancashire, FY7 6HP | 7.33 miles |
| | Ormskirk And District General Hospital, Ormskirk, Lancashire, L39 2AZ | 18.03 miles |
| | Same Day Health Centre – Morecambe, Same Day Health Centre, Morecambe, Lancashire, LA4 5LY | 18.62 miles |
| GPs | | Approx Distance |
|  | NEWTON DRIVE SURGERY, NEWTON DRIVE, LANCASHIRE, FY3 8NX | 1.06 miles |
| | DR G CELIKKOL'S PRACTICE, GRANGE PARK HEALTH CENTRE, FY3 7RW | 1.29 miles |
| | LAYTON MEDICAL CENTRE, LAYTON MEDICAL CENTRE, FY3 7EN | 1.57 miles |
| | MARTON MEDICAL PRACTICE, WHITEGATE HEALTH CENTRE, FY3 9ES | 1.63 miles |
| | GP LED HEALTH CENTRE, GP LED HEALTH CENTRE, FY3 9ES | 1.63 miles |
| Dental Surgeons | | Approx Distance |
|  | Community Dental Services, Ashton Road, LANCASTER, Lancashire, LA1 4RR | 17.49 miles |
| | Mayo Dental Clinic, Dallas Road, LANCASTER, Lancashire, LA1 1TW | 17.72 miles |
| | Mayo Dental Clinic, 3 Meeting House Lane, LANCASTER, Lancashire, LA1 1TJ | 17.83 miles |
| | Central Dental Practice, Telephone House, LANCASTER, Lancashire, LA1 1AB | 17.84 miles |
| | Brock Street Dental Practice, 8 Brock Street, LANCASTER, Lancashire, LA1 1UU | 17.9 miles |

Disclaimer: The information represented in this section has been sourced from Experian and is based on the property's postcode.



Farrell Heyworth Landmark House 5a Cleveleys Avenue, Thornton-Cleveleys, FY5 2UH **01253 886000**



Everything you want
to know about
local policing





Understanding who polices your neighbourhood

When you move to a new area, you want to know the arrangements for local community policing. See below for essential information about police services near to **Lodge Court**. We have included location and contact details for the police station and wherever possible, details of police officers assigned to the area.

Your policing neighbourhood

The name of your policing neighbourhood is **Marston** and it has a population of **6852**.

| Your Local Policing Team | | | |
|--------------------------|----------|---------|--------|
| Name | Rank | Tel No. | E-mail |
| Phil Webster | PCSO | | |
| Jennifer Bradshaw | Sergeant | | |

Disclaimer: The information represented in this section has been sourced from data.police.uk.

Locations of Interest

Blackpool Police Station
 station
 Gerry Richardson Way off Clifton Road Blackpool **For Sat Nav please use FY4 4US

Blackpool Police Station is open 08:00 to 20:00 Monday to Friday, 09:00 to 18:00 Saturday and Sunday

Disclaimer: The information represented in this section has been sourced from data.police.uk.



Farrell Heyworth Landmark House 5a Cleveleys Avenue, Thornton-Cleveleys, FY5 2UH **01253 886000**

