



Everything you need to know about:

Roseacre Road,
Roseacre, Preston,
PR4 3UE



Introduction



The Property



Local Authority



Transport Links

Education



Health



Local Policing





An invaluable insight into your new home

This i-PACK brochure offers an informed overview of **Roseacre Road** as a potential new home, along with essential material about its surrounding area and its local community. It provides a valuable insight for any prospective owner or tenant.

We wanted to provide you with information that you can absorb quickly, so we have presented it as visually as possible, making use of maps, icons, tables, graphs and charts. Overall, the brochure contains information about:

- **The Property** - including property details, floor plans, room details, photographs and Energy Performance Certificate.
- **Transport** - including locations of bus and coach stops, railway stations and ferry ports.
- **Health** - including locations, contact details and organisational information on the nearest GPs, pharmacies, hospitals and dentists.
- **Local Policing** - including locations, contact details and information about local community policing and the nearest police station, as well as police officers assigned to the area.
- **Education** - including locations of infant, primary and secondary schools and Key Performance Indicators (KPIs) for each key stage.





ROSEACRE ROAD, PRESTON £375,000



x4
Bedrooms



x3
Living Rooms



x2
Bathrooms

Where you are

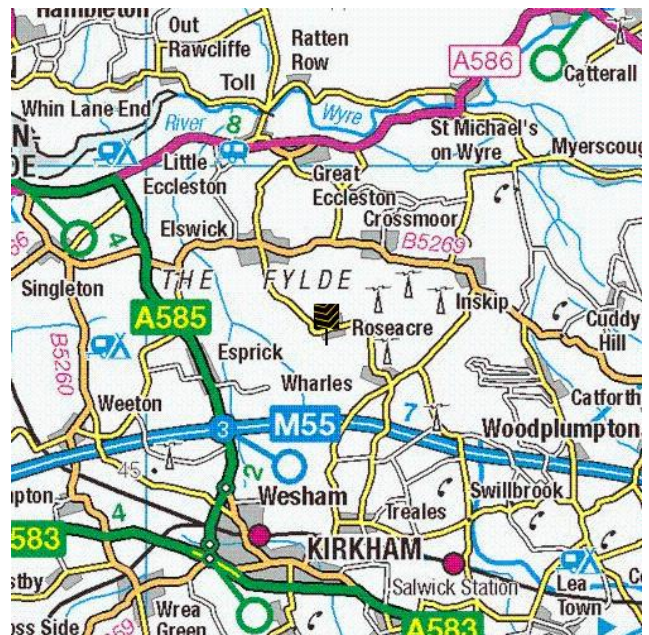
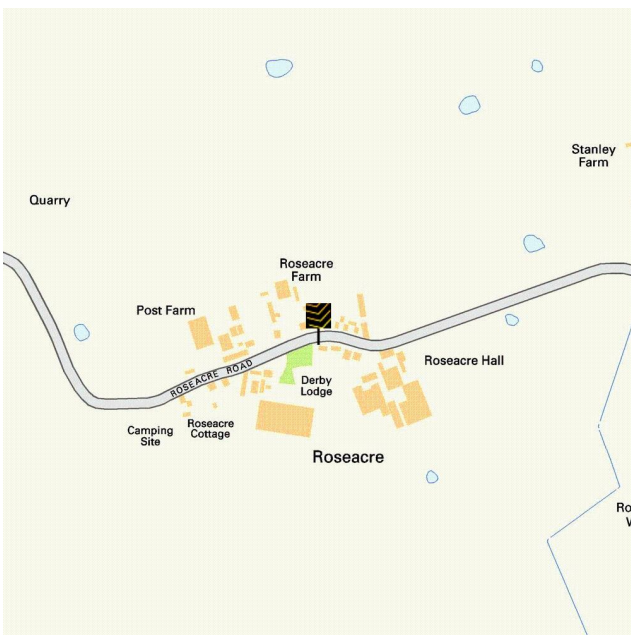



Rear Exterior



Reception Room One 4





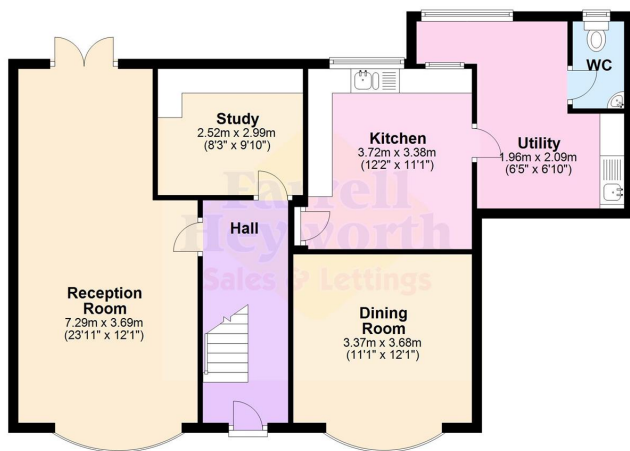

Ground Floor

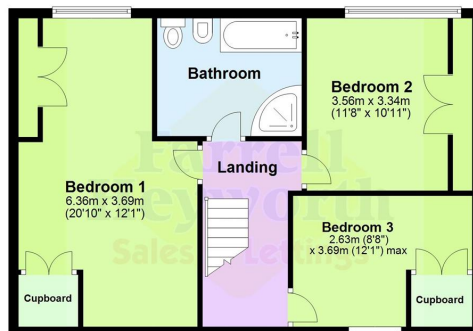

First Floor





Everything you want
to know about
local authorities





Get to know your local authorities

Local government directly affects quality of life, particularly when it comes to council tax, planning, waste disposal and the impact of local policies. You may want to investigate how this is likely to affect you if you decide to move. There are nearly 400 local authorities in England, with five different types of local government structure. These can be broadly divided into **single-tier** and **two-tier authorities**.

Single-tier authorities are **Metropolitan Authorities, London Boroughs** and **Unitary or Shire Authorities**.

Two-tier authorities have both a **County Council**, and a **District Council or City Council**.

There are also around 10,000 parish and town councils, effectively creating an additional tier in some areas - mostly, but not exclusively, in rural areas. The National Association of Local Councils (NALC) represents and works on behalf of these community councils and is a useful contact point.

The local authority locations and contact details for **Roseacre Road** are:

Shire / County / District	Website	Address	Contact details
Fylde Borough Council (Shire District)	https://new.fylde.gov.uk/	Lytham St Annes, Lytham St Annes, Lancashire, FY8 1LW	t: 01253 658658 f: 01253 713113 e: listening@fylde.gov
Lancashire County Council (Shire County)	http://www.lancashire.gov.uk	County Hall, Preston, Lancashire, PR1 8XJ	t: 0300 1236701 f: 01772 536199 e: enquiries@lancash.gov.uk

Disclaimer: The information displayed above has been obtained using the property's postcode in proximity to its local authority. It is recommended that this information is independently verified.



Everything you want
to know about
transport links







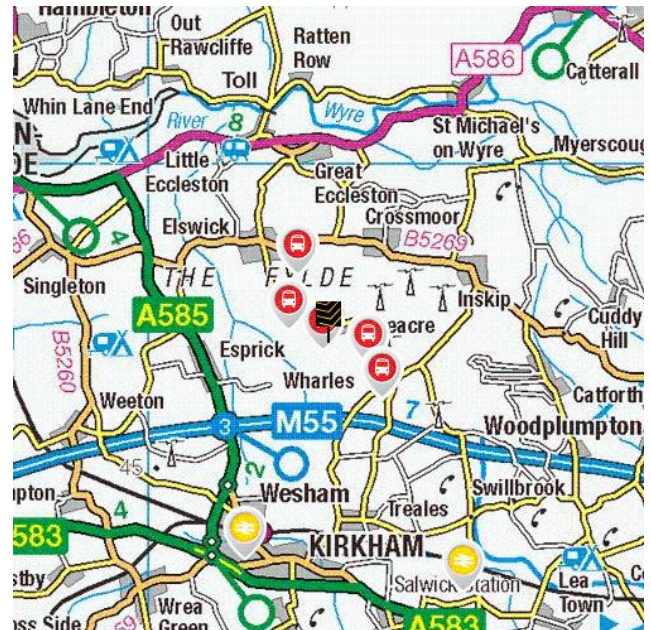
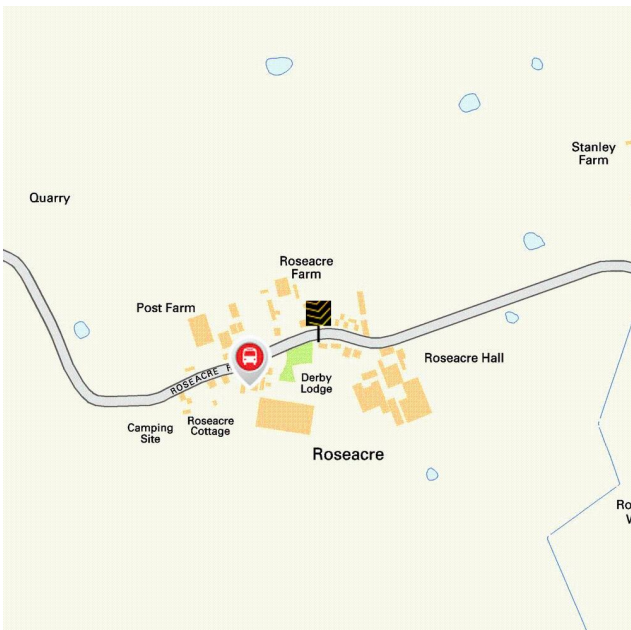

Become familiar with public transport links

Being able to choose to travel by public transport is important for many reasons. It helps to reduce congestion, provides access to work and education, and facilitates use of health and leisure facilities. If you or your family members travel abroad, access to the nearest ferry terminals is also likely to be a significant factor in choosing a new property. Using the maps below, you can pinpoint the precise locations of transport links for **Roseacre Road**. Tables for each type of transport indicate the property's distance from the nearest bus stops, railway stations, coach stops and ferry terminals (providing that these facilities are within the scale proximity of the maps.)

Transport Links



	Airports	Approx Distance
	Blackpool International Airport	8.14 miles
	Liverpool John Lennon Airport	33.63 miles
	Manchester Airport	40.01 miles
	Leeds Bradford International Airport	48.91 miles
	Ferry ports	Approx Distance
	Knott End-On-Sea Ferry Landing	9.11 miles
	Fleetwood for Knott End Ferry Landing	9.3 miles
	Heysham Ferry Terminal	14.59 miles
	Piel Island Ferry Landing	20.89 miles
	Roa Island Ferry Landing	21.43 miles
	Train Stations	Approx Distance
	Kirkham & Wesham Rail Station	2.8 miles
	Salwick Rail Station	3.43 miles
	Moss Side Rail Station	5.38 miles
	Poulton-le-Fylde Rail Station	5.63 miles
	Layton (Lancs) Rail Station	7.03 miles

Disclaimer: The information represented in this section has been sourced from the Department of Transport's Open Data and is based on the property's postcode. It is recommended that this information is independently verified.



Farrell Heyworth Landmark House 5a Cleveleys Avenue, Thornton-Cleveleys, FY5 2UH **01253 886000**

	Bus Stops	Approx Distance
	Roseacre Village	0.08 miles
	Hall Farm	0.53 miles
	Saswick House Farm	0.53 miles
	Hogarth Crescent	0.92 miles
	Hoole House	0.97 miles
	Coach Stops	Approx Distance
	Freckleton Coach Stop	4.87 miles
	Warton (Lancs): Pickwick Coach Stop	5.35 miles
	Garstang (Lancs): Crofters Hotel Coach Stop	6.74 miles
	Fulwood (Preston) Coach Stop	7.21 miles
	Lytham: Central Beach Coach Stop	7.44 miles

Disclaimer: The information represented in this section has been sourced from the Department of Transport's Open Data and is based on the property's postcode. It is recommended that this information is independently verified.



Farrell Heyworth Landmark House 5a Cleveleys Avenue, Thornton-Cleveleys, FY5 2UH **01253 886000**



Everything you want
to know about
local schools





How are local schools performing?

If schools are important to you, then this section sets out the published Key Performance Indicators for schools near to your prospective new home. Key Performance Indicators look primarily at how well pupils perform in their tests and examinations, as well as some other measures like attendance.

If you want to know more about a particular school or college, you can also visit the Ofsted website <http://www.ofsted.gov.uk/inspection-reports/find-inspection-report>

Local Schools

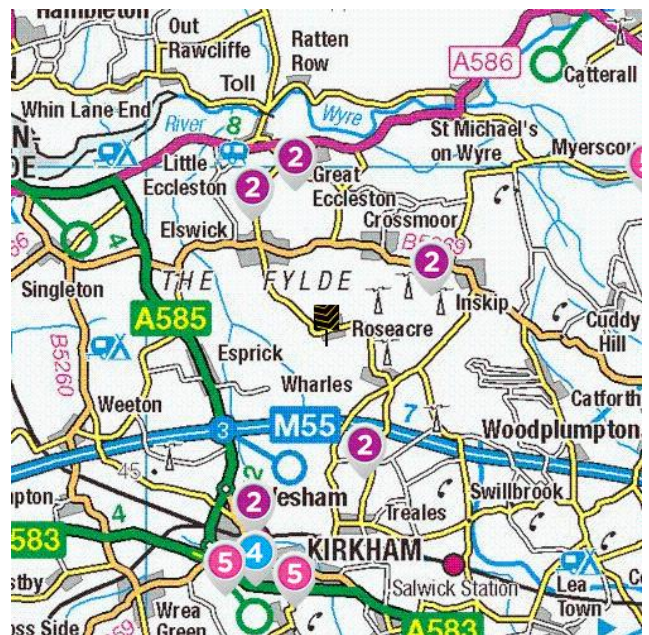
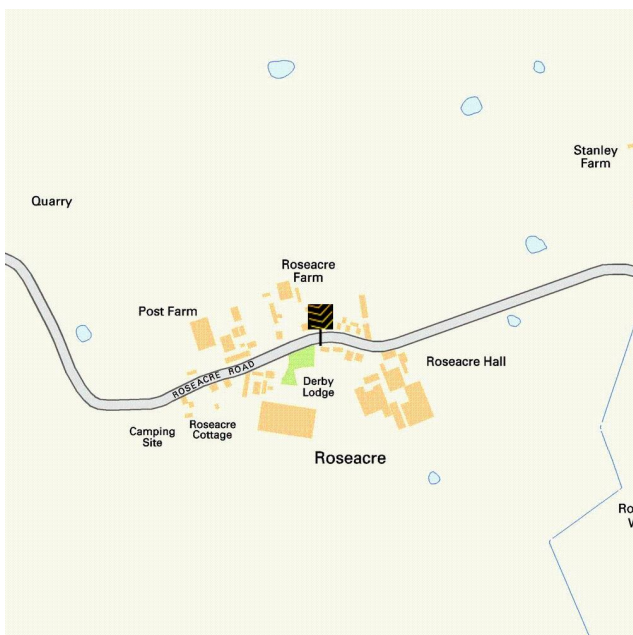

The next page shows tables and charts divided into Key Stages and a list of respective schools local to **Roseacre Road**. There are four main age-related Key Stages defined as:



Special schools are marked with this icon

Key Stage	Definition
Key Stage 1	Fits broadly with the first stage of education, i.e. ages 5-7.
Key Stage 2	Fits the later stage of primary education, often known as junior schools, i.e. ages 8-11. This takes pupils up to the standardised break at age 11 after which pupils generally change schools and transfer to secondary education.
Key Stage 3	Secondary education split between key stages 3 and 4, with key stage 3 covering ages 11-13.
Key Stage 4	Key Stage 4 (ages 14-16) covers the two year period of study for GCSE level examinations.
Key Stage 5	Beyond key stage 4 is 16+ or Sixth Form provision, sometimes unofficially referred to as Key Stage 5.



Farrell Heyworth Landmark House 5a Cleveleys Avenue, Thornton-Cleveleys, FY5 2UH **01253 886000**

	Key Stage 2 - Information	Approx Distance
	<p>Name: Inskip St Peter's Church of England Voluntary Aided School Address: Preston Road, Preston, PR4 0TT Contact Number: 01772690438 Age Range: 4-11 yrs Local Education Authority: Lancashire Religious Character: Church of England</p>	1.46 miles
	<p>Name: Treales Church of England Primary School Address: Church Road, Preston, PR4 3SH Contact Number: 01772684678 Age Range: 4-11 yrs Local Education Authority: Lancashire Religious Character: Church of England</p>	1.61 miles
	<p>Name: Great Eccleston Copp CofE Primary School Address: Copp Lane, Preston, PR3 0ZN Contact Number: 01995670969 Age Range: 3-11 yrs Local Education Authority: Lancashire Religious Character: Church of England</p>	1.85 miles
	<p>Name: St Mary's Catholic Primary School, Great Eccleston Address: St Mary's Road, Preston, PR3 0ZJ Contact Number: 01995670364 Age Range: 4-11 yrs Local Education Authority: Lancashire Religious Character: Roman Catholic</p>	2.02 miles
	<p>Name: St Joseph's Catholic Primary School, Medlar-with-Wesham Address: Garstang Road North, Preston, PR4 3HA Contact Number: 01772683009 Age Range: 5-11 yrs Local Education Authority: Lancashire Religious Character: Roman Catholic</p>	2.41 miles

Disclaimer: The information represented in this section has been sourced from the Department of Education's 2019 results data s and is based on the property's postcode.



Reading, Writing and Maths

	Name	Expected	Higher
2	Inskip St Peter's Church of England Voluntary Aided School	N/A	N/A
	Treales Church of England Primary School	67.0 %	22.0 %
	Great Eccleston Copp CofE Primary School	58.0 %	16.0 %
	St Mary's Catholic Primary School, Great Eccleston	100.0 %	17.0 %
	St Joseph's Catholic Primary School, Medlar-with-Wesham	75.0 %	13.0 %
	Lancashire	64.0 %	10.0 %
National	65.0 %	11.0 %	

Primary Progress Measures

As well as actual pupil performance in tests and exams an important Key Performance Indicator is that of progress measures that compare the actual achievements of other pupils nationally with similar prior attainment. Any increase in attainment achieved by each pupil will be reflected in the schools progress scores. They are fairer to schools in challenging circumstances, as they recognise a school that is doing a good job with an intake with poor prior attainment



Progress Measures for 2019

	Name	Math	Reading	Writing
2	Inskip St Peter's Church of England Voluntary Aided School	N/A	N/A	N/A
	Treales Church of England Primary School	0.5 %	-1.7 %	1.3 %
	Great Eccleston Copp CofE Primary School	-2.8 %	-3.6 %	-1.1 %
	St Mary's Catholic Primary School, Great Eccleston	N/A	N/A	N/A
	St Joseph's Catholic Primary School, Medlar-with-Wesham	1.3 %	1.8 %	1.1 %

Disclaimer: The information represented in this section has been sourced from the Department of Education's 2019 results data set and is based on the property's postcode.



Farrell Heyworth Landmark House 5a Cleveleys Avenue, Thornton-Cleveleys, FY5 2UH 01253 886000

	Key Stage 4 - Information	Approx Distance
	 <p>Name: Kirkham Pear Tree School Address: 29 Station Road, Preston, PR4 2HA Contact Number: 01772683609 Age Range: 2-19 yrs Local Education Authority: Lancashire Religious Character: Does not apply</p>	2.99 miles
	<p>Name: Carr Hill High School Address: Royal Avenue, Preston, PR4 2ST Contact Number: 01772682008 Age Range: 11-16 yrs Local Education Authority: Lancashire Religious Character: Does not apply Admission Policy: Comprehensive</p>	3.15 miles
	<p>Name: Kirkham Grammar School Address: Ribby Road, Preston, PR4 2BH Contact Number: 01772671079 Age Range: 3-19 yrs Local Education Authority: Lancashire Religious Character: None</p>	3.24 miles
	 <p>Name: Bracken School Address: 1 Harbour Lane, Preston, PR4 1YA Contact Number: 01772631531 Age Range: 11-16 yrs Local Education Authority: Lancashire Religious Character: None</p>	5.18 miles
	<p>Name: Hodgson Academy Address: Moorland Road, Poulton-le-Fylde, FY6 7EU Contact Number: 01253882815 Age Range: 11-16 yrs Local Education Authority: Lancashire Religious Character: Does not apply</p>	5.37 miles

Disclaimer: The information represented in this section has been sourced from the Department of Education's 2019 results data and is based on the property's postcode.



Percentage of pupils achieving 5+ A*-C/9-4 or equivalents including 9-4 in both English and mathematics GCSEs

	Name	2019	2018	2017	2016
4	Kirkham Pear Tree School	N/A	N/A	N/A	N/A
	Carr Hill High School	59.0 %	56.0 %	49.0 %	49.0 %
	Kirkham Grammar School	0.0 %	0.0 %	0.0 %	83.0 %
	Bracken School	N/A	N/A	N/A	N/A
	Hodgson Academy	75.0 %	77.0 %	79.0 %	77.0 %
	Lancashire	66.0 %	66.1 %	61.7 %	58.5 %
	National	60.0 %	59.4 %	56.6 %	53.5 %

Disclaimer: The information represented in this section has been sourced from the Department of Education's 2017 results data set and is based on the property's postcode.

Average number of GCSE entries per pupil

	Name	Number
4	Kirkham Pear Tree School	N/A
	Carr Hill High School	7.7
	Kirkham Grammar School	6.9
	Bracken School	N/A
	Hodgson Academy	7.7
	Lancashire	7.5
	National	7.1

Disclaimer: The information represented in this section has been sourced from the Department of Education's 2019 results data set and is based on the property's postcode.



	Key Stage 5 - Information	Approx Distance
	<p>Name: Carr Hill High School Address: Royal Avenue, Preston, PR4 2ST Contact Number: 01772682008 Age Range: 11-16 yrs Local Education Authority: Lancashire Religious Character: Does not apply Admission Policy: Comprehensive</p>	3.15 miles
	<p>Name: Kirkham Grammar School Address: Ribby Road, Preston, PR4 2BH Contact Number: 01772671079 Age Range: 3-19 yrs Local Education Authority: Lancashire Religious Character: None</p>	3.24 miles
	<p>Name: Myerscough College Address: St Michael's Road, Preston, PR3 0RY Contact Number: 01995642222 Age Range: 16+ yrs Local Education Authority: Lancashire Religious Character: Does not apply Admission Policy: Not applicable</p>	4.35 miles
	<p>Name: Baines School Address: Highcross Road, Poulton-le-Fylde, FY6 8BE Contact Number: 01253883019 Age Range: 11-16 yrs Local Education Authority: Lancashire Religious Character: None Admission Policy: Comprehensive</p>	5.59 miles
	<p>Name: Ashton Community Science College Address: Aldwych Drive, Preston, PR2 1SL Contact Number: 01772513002 Age Range: 11-16 yrs Local Education Authority: Lancashire Religious Character: Does not apply Admission Policy: Comprehensive</p>	5.94 miles

Disclaimer: The information represented in this section has been sourced from the Department of Education's 2019 results data s and is based on the property's postcode.



Percentage of A level students achieving at least three levels at grades AAB or better, at least two of which are in facilitating subjects

	Name	%
	Carr Hill High School	N/A
	Kirkham Grammar School	12.7 %
	Myerscough College	N/A
	Baines School	N/A
	Ashton Community Science College	N/A
	Lancashire	15.1 %
	National	16.5 %

Disclaimer: The information represented in this section has been sourced from the Department of Education's 2019 results data set and is based on the property's postcode.

As well as actual pupil performance in tests and exams, an important Key Performance Indicator is that of Value Added. When pupils start a school, they all have varying levels of ability and social advantage. A school's Value Added score measures how much progress they have made from the beginning to the end of their compulsory secondary education (i.e. between the end of Key Stage 2 and the end of Key Stage 4). It is a quick measurement of the effect of a school on its pupils.

	Name	Value Added
	Carr Hill High School	N/A
	Kirkham Grammar School	0.0
	Myerscough College	N/A
	Baines School	N/A
	Ashton Community Science College	N/A





Everything you want
to know about
local health services





How local are the health services?

We all want good access to local health facilities, wherever we live. To see how well **Roseacre Road** is served, we have set out below the exact locations of hospitals, Accident & Emergency centres, GPs, pharmacies, dentists, out-of-hours medical care and walk-in clinics. Where it's available, you will find more detailed information, including the names of practitioners and their contact details.

Hospitals		Approx Distance
	Blackpool Victoria Hospital, Whinney Heys Road, Blackpool, Lancashire, FY3 8NR	6.44 miles
	Royal Preston Hospital, Sharoe Green Lane North, Preston, Lancashire, PR2 9HT	6.58 miles
	Southport And Formby District General Hospital, Southport, Merseyside, PR8 6PN	14.08 miles
	Chorley And South Ribble Hospital, Chorley and South Ribble Hospital, Chorley, Lancashire, PR7 1PP	14.22 miles
	Royal Lancaster Infirmary, Ashton Road, Lancaster, Lancashire, LA1 4RP	15.25 miles
A&E		Approx Distance
	Blackpool Victoria Hospital, Whinney Heys Road, Blackpool, Lancashire, FY3 8NR	6.44 miles
	Royal Preston Hospital, Sharoe Green Lane North, Preston, Lancashire, PR2 9HT	6.58 miles
	Southport And Formby District General Hospital, Southport, Merseyside, PR8 6PN	14.08 miles
	Chorley And South Ribble Hospital, Chorley and South Ribble Hospital, Chorley, Lancashire, PR7 1PP	14.22 miles
	Royal Lancaster Infirmary, Ashton Road, Lancaster, Lancashire, LA1 4RP	15.25 miles

	Walk-in Clinics	Approx Distance
	Blackpool Victoria Hospital, Whinney Heys Road, Blackpool, Lancashire, FY3 8NR	6.44 miles
	Blackpool Nhs Walk-in Centre, Whitegate Health Centre, Blackpool, Lancashire, FY3 9ES	7.23 miles
	Same Day Health Centre – Fleetwood, Same Day Health Centre, Fleetwood, Lancashire, FY7 6HP	9.07 miles
	Dr T L Phillips At Barbara Castle Health Centre, Level Two, Lancashire, BB2 1AX	16.01 miles
	Royal Blackburn Hospital, Haslingden Road, Blackburn, Lancashire, BB2 3HH	17.1 miles
	GPs	Approx Distance
	GREAT ECCLESTON HLTH CTR, GREAT ECCLESTON HLTH CTR, PRESTON, LANCASHIRE, PR3 0ZA	2.13 miles
	ASH TREE HOUSE SURGERY, ASH TREE HOUSE, LANCASHIRE, PR4 2SE	2.9 miles
	KIRKHAM HEALTH CENTRE, KIRKHAM HEALTH CENTRE, PRESTON, PR4 2DL	3.06 miles
	THE LOCKWOOD AVENUE SURGERY, WESTBOURNE COURT, BLACKPOOL, LANCASHIRE, FY6 7AB	5.73 miles
	QUEENSWAY MEDICAL CENTRE, QUEENSWAY MC, QUEENSWAY, LANCASHIRE, FY6 7ST	5.78 miles
	Dental Surgeons	Approx Distance
	Community Dental Services, Ashton Road, LANCASTER, Lancashire, LA1 4RR	15.11 miles
	Mayo Dental Clinic, Dallas Road, LANCASTER, Lancashire, LA1 1TW	15.44 miles
	Brock Street Dental Practice, 8 Brock Street, LANCASTER, Lancashire, LA1 1UU	15.56 miles
	Mayo Dental Clinic, 3 Meeting House Lane, LANCASTER, Lancashire, LA1 1TJ	15.57 miles
	Central Dental Practice, Telephone House, LANCASTER, Lancashire, LA1 1AB	15.57 miles

Disclaimer: The information represented in this section has been sourced from Experian and is based on the property's postcode.



Farrell Heyworth Landmark House 5a Cleveleys Avenue, Thornton-Cleveleys, FY5 2UH **01253 886000**



Everything you want
to know about
local policing





Understanding who polices your neighbourhood

When you move to a new area, you want to know the arrangements for local community policing. See below for essential information about police services near to **Roseacre Road**. We have included location and contact details for the police station and wherever possible, details of police officers assigned to the area.

Your policing neighbourhood

The name of your policing neighbourhood is **Newton and Treales** and it has a population of **3227**.

Your Local Policing Team			
Name	Rank	Tel No.	E-mail
Jacqui Marwick	PCSO		

Disclaimer: The information represented in this section has been sourced from data.police.uk.

Locations of Interest

Blackpool Police Station
 station
 Gerry Richardson Way off Clifton Road Blackpool **For Sat Nav please use FY4 4US

Blackpool Police Station is open 08:00 to 20:00 Monday to Friday, 09:00 to 18:00 Saturday and Sunday

Disclaimer: The information represented in this section has been sourced from data.police.uk.



Farrell Heyworth Landmark House 5a Cleveleys Avenue, Thornton-Cleveleys, FY5 2UH **01253 886000**

