



28 Mill Stream House, Norfolk Street, Oxford, OX1 1EB

Location: Prime position opposite Westgate shopping development

Type: Luxury second floor 1 BEDROOM APARTMENT

Ideal For: Professional couples/singles

Accommodation:

Open plan reception room onto beautiful kitchen

Large double bedroom

Bathroom

Kitchen Features:

AEG integrated appliances (electric cooker, microwave oven, hob, fridge/freezer & dishwasher)

Storage:

Several cupboard spaces

Large built-in wardrobe in bedroom with lights

Ottoman style double bed with storage underneath

Additional Features:

Large patio doors for ample natural light

TV, phone & internet sockets in living room and bedroom

- 1 Bedroom
- 1 Reception
- 1 Bathroom
- Oxford City Centre
- Furnished Property
- Flat
- NO PARKING

£1,950 PCM

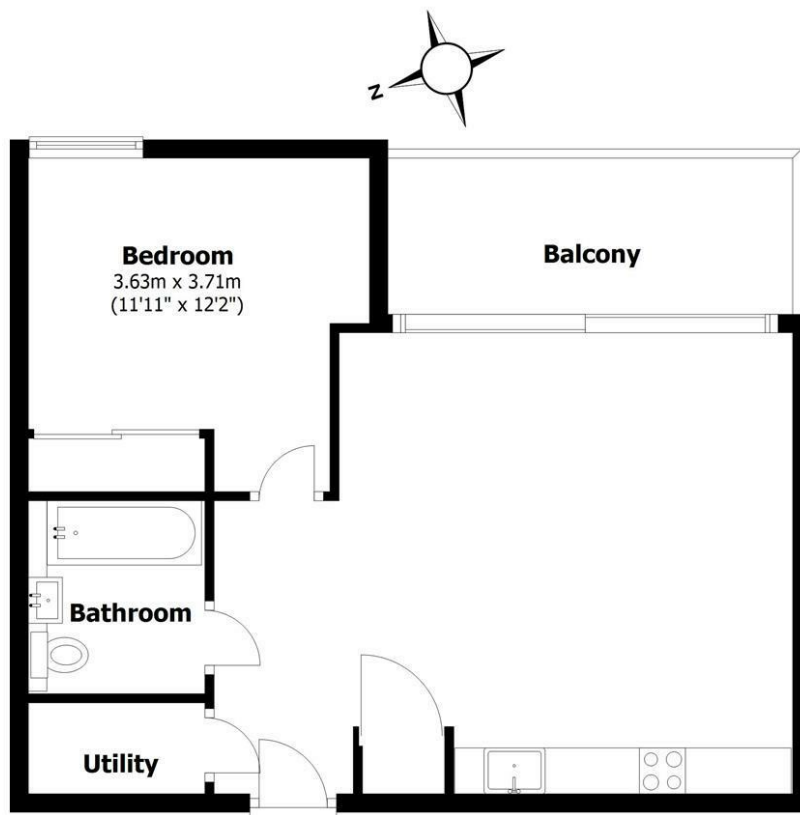

Floor Plan

Approx. 45.9 sq. metres (494.4 sq. feet)

This floor plan is for illustrative purposes only and provides an outline representation of the property only.

Produced for North Oxford Property Services.
Plan produced using PlanUp.

Energy Efficiency Rating		
	Current	Potential
Very energy efficient - lower running costs		
(92 plus) A		
(81-91) B	83	83
(69-80) C		
(55-68) D		
(39-54) E		
(21-38) F		
(1-20) G		
Not energy efficient - higher running costs		
England & Wales	EU Directive 2002/91/EC	

Environmental Impact (CO ₂) Rating		
	Current	Potential
Very environmentally friendly - lower CO ₂ emissions		
(92 plus) A	91	91
(81-91) B		
(69-80) C		
(55-68) D		
(39-54) E		
(21-38) F		
(1-20) G		
Not environmentally friendly - higher CO ₂ emissions		
England & Wales	EU Directive 2002/91/EC	