



207a Cowley Road, Cowley, Oxford, OX4 1XF

Available for academic year 2025/26' Large four bedroom split level student apartment.

The property has a large living room, FOUR DOUBLE bedrooms, shower room and kitchen with appliances. Internal viewings highly recommended.

On Street Residence Parking Permit required.

- 4 Bedrooms
- 1 Receptions
- Furnished Property
- No Garden
- Permit Parking Available

£3,100 PCM

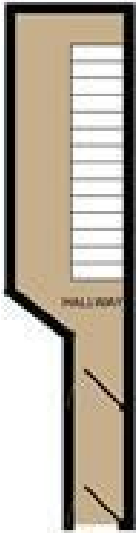

GROUND FLOOR
APPROX. FLOOR
AREA 9.6 SQ.M.
(103 SQ.FT.)



1ST FLOOR
APPROX. FLOOR
AREA 73.7 SQ.M.
(794 SQ.FT.)

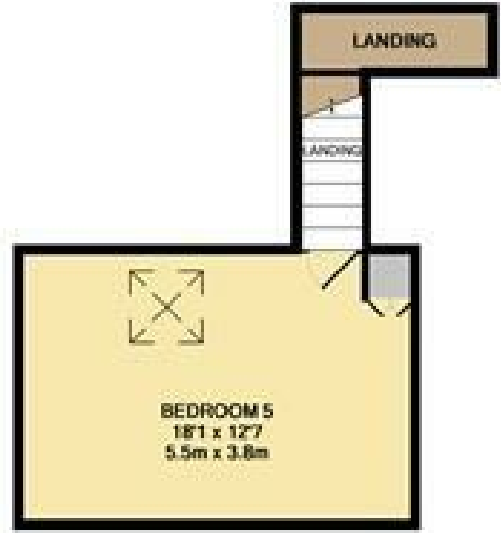

2ND FLOOR
APPROX. FLOOR
AREA 26.6 SQ.M.
(288 SQ.FT.)

COWLEY ROAD, OXFORD
TOTAL APPROX. FLOOR AREA 109.3 SQ.M. (1176 SQ.FT.)

While every effort has been made to ensure the accuracy of the floor plan illustrated here, measurements of doors, windows, rooms and any other items are approximate and no responsibility is taken for any error, omission or mis-statement. This plan is for illustrative purposes only and should be used as such by any prospective purchaser. The services, systems and appliances shown have not been tested and no guarantee as to their operability or efficiency can be given.
Made with Metropix 4200R

Energy Efficiency Rating		Current	Potential
Very energy efficient - lower running costs			
(92 plus) A			
(81-91) B			
(69-80) C			
(55-68) D			
(39-54) E			
(21-38) F			
(1-20) G			
Not energy efficient - higher running costs			
		44	65
England & Wales	EU Directive 2002/91/EC		

Environmental Impact (CO ₂) Rating		Current	Potential
Very environmentally friendly - lower CO ₂ emissions			
(92 plus) A			
(81-91) B			
(69-80) C			
(55-68) D			
(39-54) E			
(21-38) F			
(1-20) G			
Not environmentally friendly - higher CO ₂ emissions			
England & Wales	EU Directive 2002/91/EC		