



2 Isis House, Abingdon Road, Oxford, OX1 4LD

Property Particulars:

Property Type:

1-bedroom unfurnished apartment

Location:

Address: Isis House, OX1

Easy access to the city centre for work, shopping, and entertainment

Proximity to the river, offering a picturesque and serene setting

Interior Features:

Bedroom:

Spacious and comfortable

Bathroom:

Modern and well-appointed

- 1 Bedroom
- 1 Reception
- 1 Bathroom
- South Oxford
- Flat

£1,400 PCM

GROUND FLOOR

APPROX. 33.2 SQ. METRES (357.1 SQ. FEET)

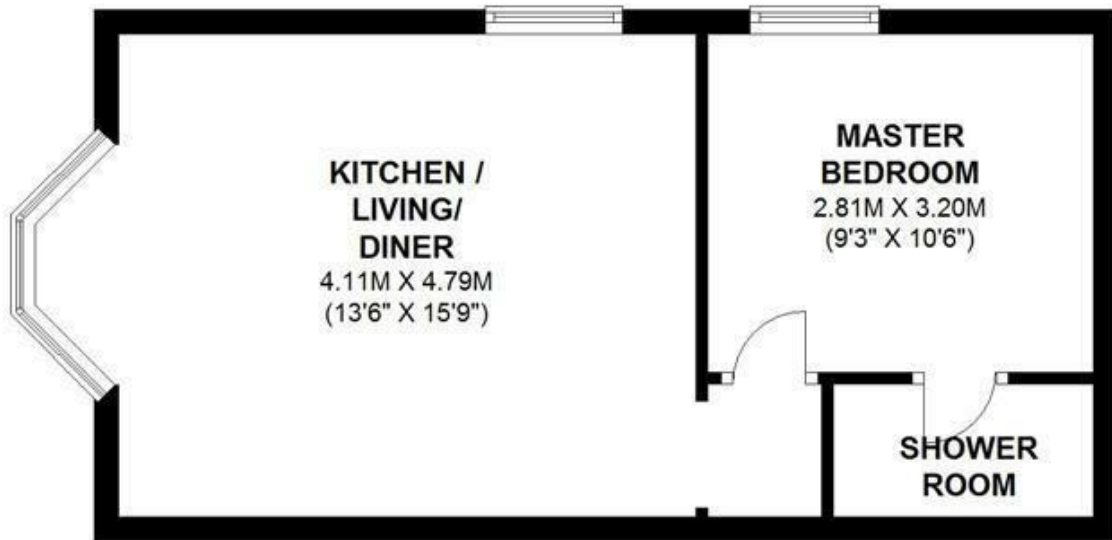

TOTAL AREA: APPROX. 33.2 SQ. METRES (357.1 SQ. FEET)

