



39 Prestwich Place, Oxford, OX2 0ED

Popular 2 bed townhouse near City Centre and Ring Road.
Modern kitchen & lounge with patio door to garden.
Enclosed garden with canal views.
Double bedroom, twin bedroom & family bathroom.
Parking for 2 cars. Council tax band D.
Key Features:

Prime location for commuting and city access.
Stylish modern kitchen for culinary enthusiasts.
Lounge with patio door for indoor-outdoor living.
Enclosed garden offers scenic relaxation space.
Comfortable bedrooms suitable for families or sharers.
Family bathroom for convenience.
Ample parking space for 2 cars.
Council tax band D ensures reasonable rates.
Summary:

- 2 Bedrooms
- 1 Reception Room
- 1 Bathroom
- Parking
- Botley
- Furnished Property
- House
- Small Garden

£1,850 PCM

FIRST FLOOR

APPROX. 18.0 SQ. METRES (193.9 SQ. FEET)

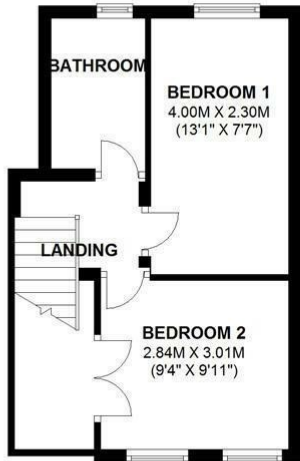

GROUND FLOOR

APPROX. 25.2 SQ. METRES (271.7 SQ. FEET)

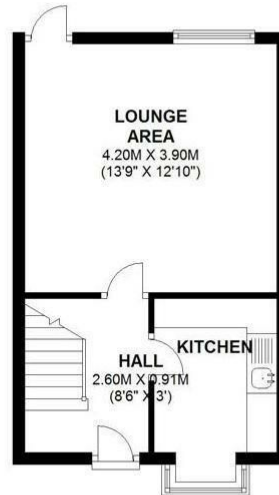

TOTAL AREA: APPROX. 43.3 SQ. METRES (465.6 SQ. FEET)

