



# RE/MAX

## PROPERTY HUB



## 13 Horseshoe Drive, Newton Abbot, TQ12 6WL

### Asking price £240,000

RE/MAX are delighted to present this fabulous, modern, semi-detached property with two double bedrooms, an enclosed and landscaped rear garden, conservatory and parking, on a recent development in the popular market town of Newton Abbot.

Inside, it is well-presented with light and neutral décor throughout, and feels warm and welcoming with gas central heating and double glazing.

The ground floor comprises of an entrance hallway, with a broom cupboard, a staircase rising to the first floor, and a convenient ground-floor cloakroom with a WC and basin. A good-sized kitchen/dining room has plenty of worktop space and a range of fitted base and wall units, providing ample storage. It has a fan-oven with a gas hob and an integral filter hood above, floor space for an upright fridge/freezer, and plumbing beneath the worktop for a washing machine and other white goods. Completing the ground floor is a carpeted living room, filled with light from a window and French doors to the rear garden. To the rear of the property off of the living room, is a newly constructed conservatory adding additional living space, overlooking the garden.

Upstairs, there are two light and airy double bedrooms, one with a cupboard above the stairs containing the condensing combi-boiler that provides the central heating and hot water on demand. A modern bathroom contains a bath, with a shower and glass screen above, a pedestal basin and a WC, all in white, and the landing has a hatch in the ceiling to the loft space.



## Floor Plan

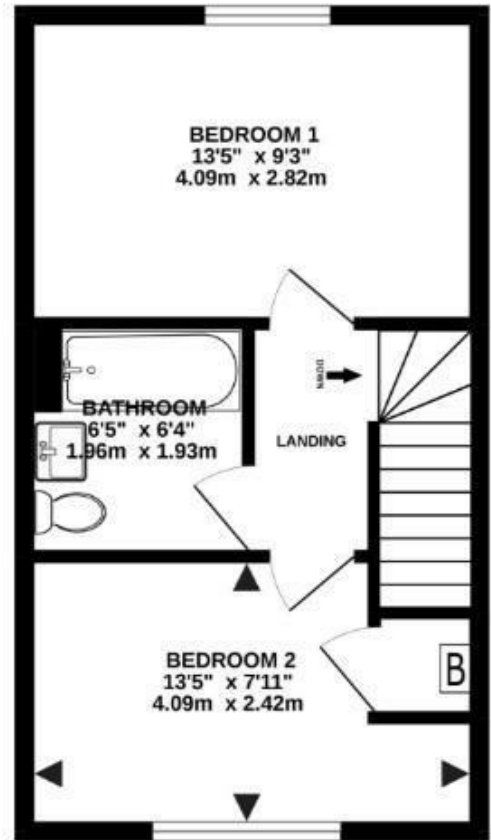
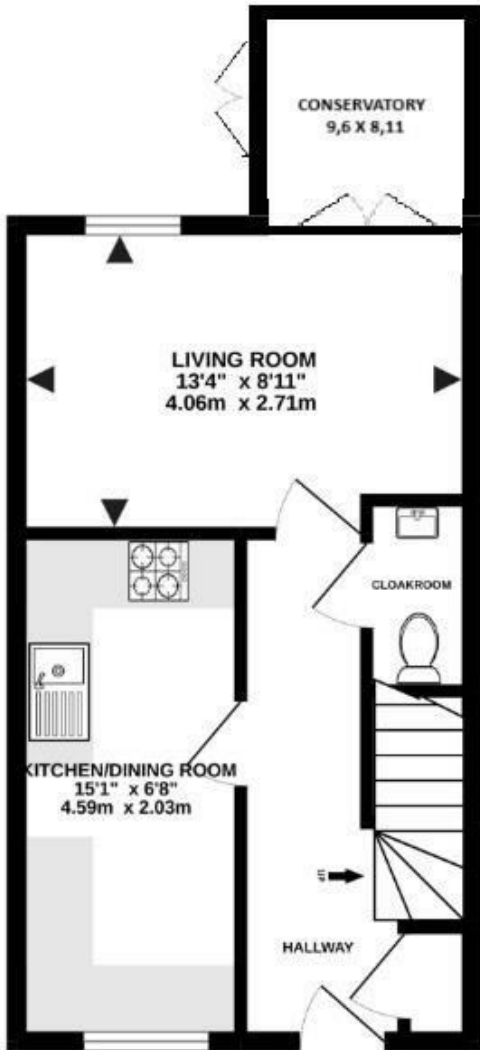

## Area Map

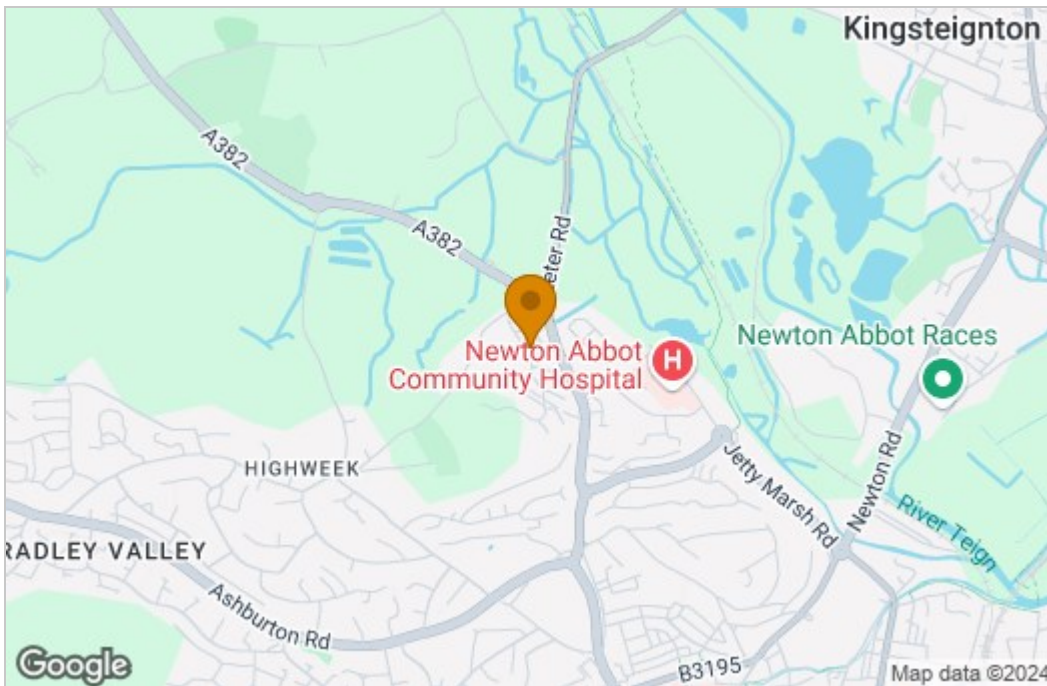

## Energy Efficiency Graph

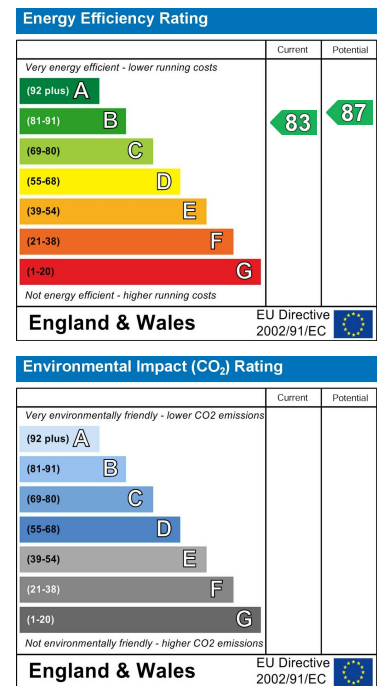

These particulars, whilst believed to be accurate are set out as a general outline only for guidance and do not constitute any part of an offer or contract. Intending purchasers should not rely on them as statements of representation of fact, but must satisfy themselves by inspection or otherwise as to their accuracy. No person in this firm's employment has the authority to make or give any representation or warranty in respect of the property.

2 Reynell Road, Newton Abbot, Devon, TQ12 6YA

Tel: 07850 038794 Email: ryan.flory@remax.uk <https://remax.uk/associates/Ryan%20Flory>