



# RE/MAX

## PROPERTY HUB



**26 Sovereign Road, Newton Abbot, TQ12 1YL**

**Guide price £295,000**

RE/MAX are delighted to bring to the market this beautifully presented 3 bedroom semi detached house. The property briefly comprises, 3 good sized bedrooms, master en-suite, fully tiled bathroom, built in wardrobes in bedrooms 1 and 2, an open plan kitchen/diner, with a fitted hob, oven, extractor hood, fridge freezer, dishwasher and plumbing for a washing machine. The french doors are off of the kitchen/diner leading to the private and enclosed rear garden. There is driveway parking for two cars, and a downstairs W/C. The property is in immaculate condition throughout and would make the perfect home.



## Floor Plan

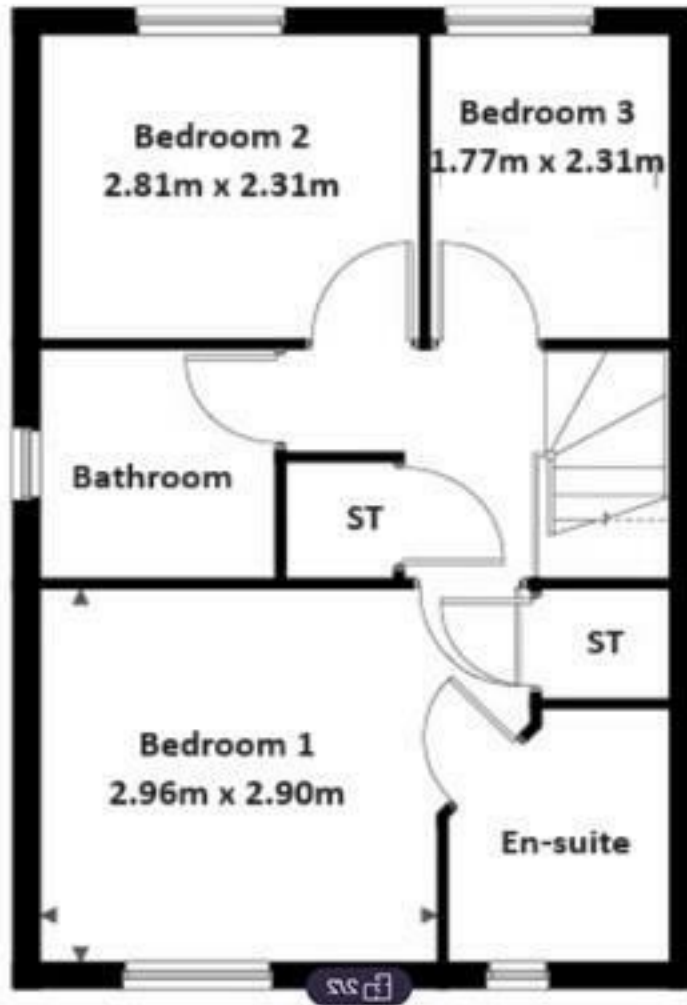

## Area Map

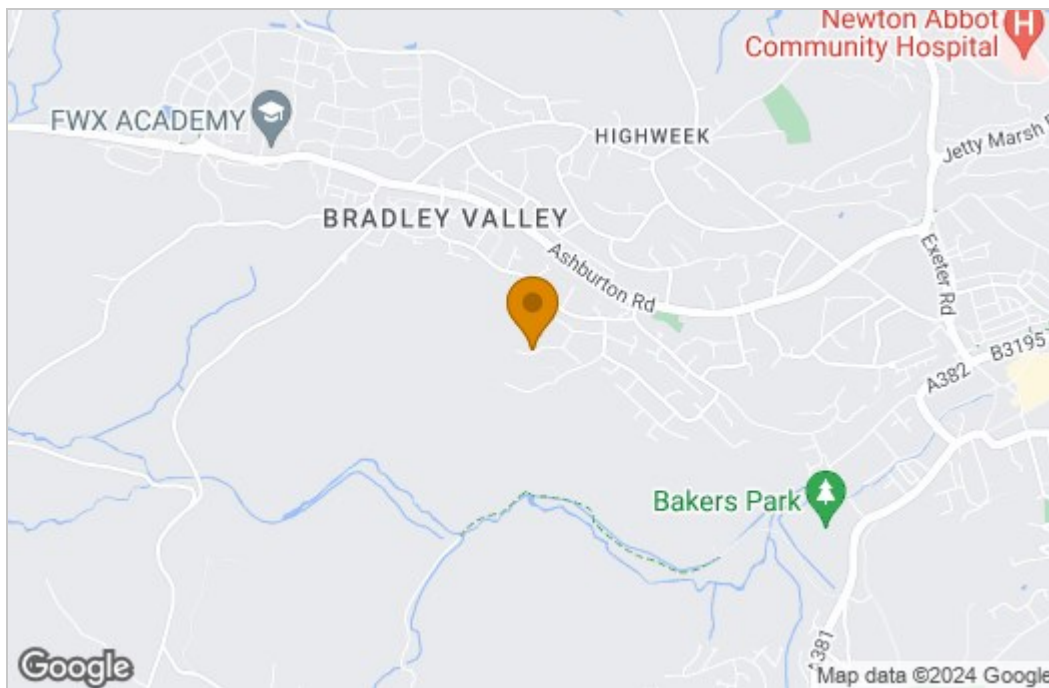

## Energy Efficiency Graph

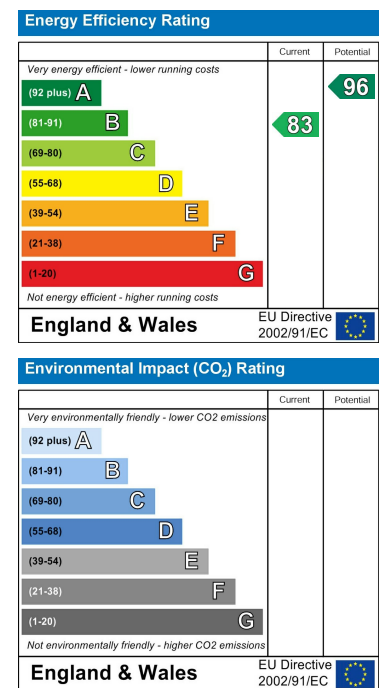

These particulars, whilst believed to be accurate are set out as a general outline only for guidance and do not constitute any part of an offer or contract. Intending purchasers should not rely on them as statements of representation of fact, but must satisfy themselves by inspection or otherwise as to their accuracy. No person in this firm's employment has the authority to make or give any representation or warranty in respect of the property.