



RE/MAX

PROPERTY HUB



8 Peters Crescent, Marldon, TQ3 1PQ

Offers over £300,000

Located in the popular village location of Marldon, with easy access to the Torbay Ring Road, as well as through to nearby towns of Totnes and Newton Abbot. The village has a few local shops available as well as the convenience store within the local Petrol Station nearby. The village has a popular Primary School, together with a couple of local pubs/restaurants.

This detached bungalow is offered for sale chain free and is in good order throughout. The bungalow open countryside views stretching across to the Moors.

The accommodation briefly comprises of a good size entrance lobby and hallway, with lounge enjoying good open views, a separate dining room with opening through to the fitted kitchen, 2 double bedrooms and a bathroom. There is also a garage at the side of the property with a large rear garden with countryside views.

An internal viewing is recommended.

Floor Plan

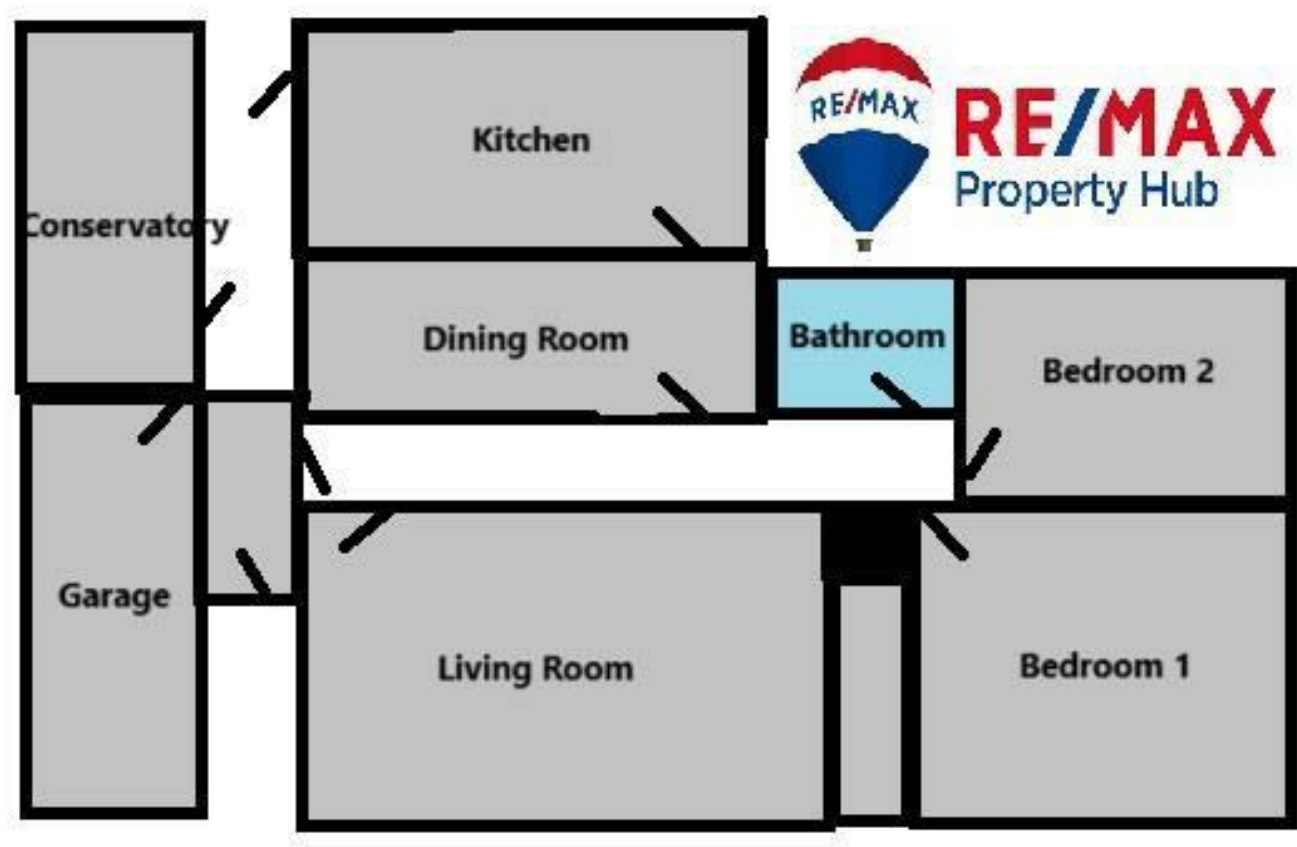

Area Map



Energy Efficiency Graph

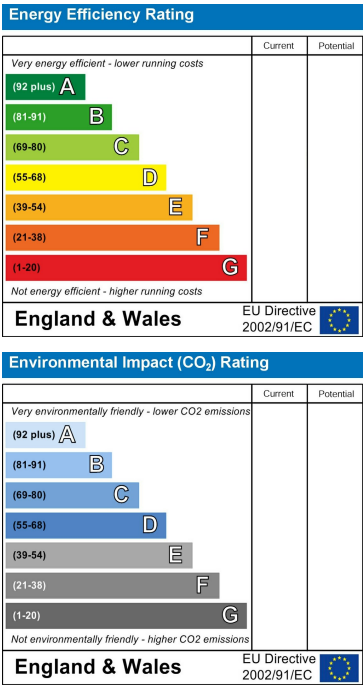

These particulars, whilst believed to be accurate are set out as a general outline only for guidance and do not constitute any part of an offer or contract. Intending purchasers should not rely on them as statements of representation of fact, but must satisfy themselves by inspection or otherwise as to their accuracy. No person in this firms employment has the authority to make or give any representation or warranty in respect of the property.