



RE/MAX

PROPERTY HUB



7 Pomeroy Road, Newton Abbot, TQ12 1LQ

Guide price £190,000

RE/MAX are delighted to bring to the market this stone fronted period style terraced house, situated in a convenient and sought after level location within the centre of this popular market town, Newton Abbot. The modernised and well-presented accommodation boasting original features, two bedrooms, a spacious living room, modern kitchen/diner, bathroom/WC and conservatory/utility area. Gas central heating and double glazing are installed and outside there is a small courtyard and residents parking.

The property has recently had a new combination boiler fitted and a full re-wire. This would make the perfect first time purchase or buy to let.

Location

Situated in a level location within the town centre, the property enjoys access to all that this popular market town offers. There is an abundance of shopping and leisure facilities and access to both bus and train links. The coastal resorts of Torbay and Teignbridge along with the beauty of Dartmoor National Park are within close proximity.

Floor Plan

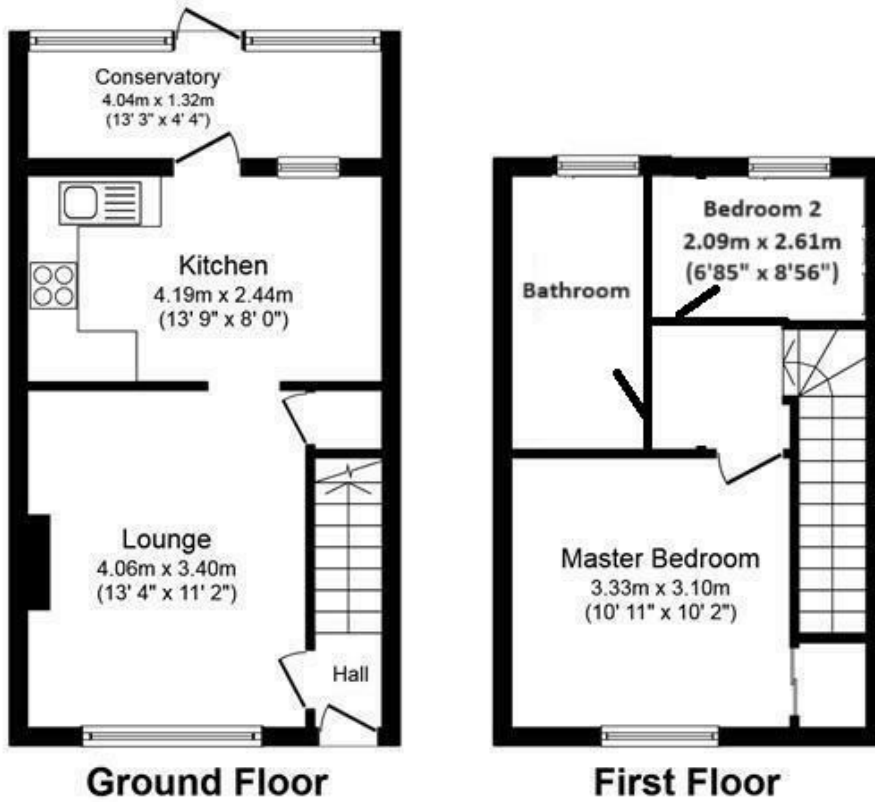

Total floor area 61.0 sq. m. (657 sq. ft.) approx

This plan is for illustration purposes only and may not be representative of the property. Plan not to scale.

Area Map

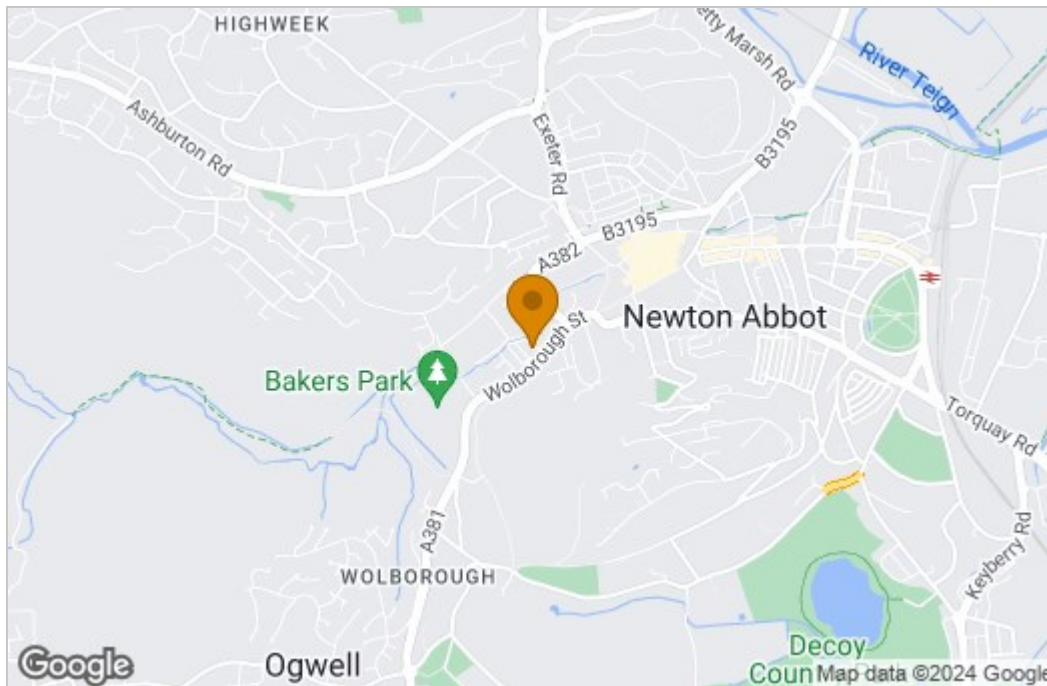

Energy Efficiency Graph

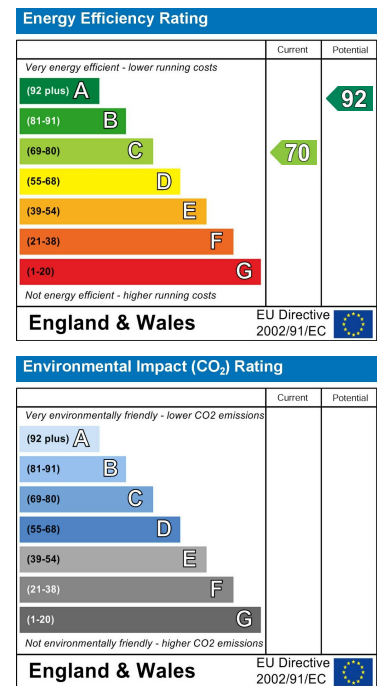

These particulars, whilst believed to be accurate are set out as a general outline only for guidance and do not constitute any part of an offer or contract. Intending purchasers should not rely on them as statements of representation of fact, but must satisfy themselves by inspection or otherwise as to their accuracy. No person in this firm's employment has the authority to make or give any representation or warranty in respect of the property.

2 Reynell Road, Newton Abbot, Devon, TQ12 6YA

Tel: 07850 038794 Email: ryan.flory@remax.uk <https://remax.uk/associates/Ryan%20Flory>