

# BURGIN ATKINSON

& C O M P A N Y



18 Brixworth Way, Retford, Nottinghamshire, DN22 6TT

4 BEDROOM HOME - OFFERED WITH NO ONWARD CHAIN - VIEWS OVER THE CHESTERFIELD CANAL - SPACIOUS LOUNGE - DINING ROOM - KITCHEN - SUNROOM - DOWNSTAIRS W/C - MAIN FAMILY BATHROOM - ENCLOSED REAR GARDEN - SPACIOUS SINGLE GARAGE - OFF STREET PARKING - WELL PRESENTED FAMILY HOME - EPC C

- 4 BEDROOM FAMILY HOME
- EDGE OF TOWN LOCATION
- KITCHEN, DINING ROOM AND SUNROOM
- SPACIOUS LOUNGE
- SPACIOUS SINGLE GARAGE
- COUNTRYSIDE WALKS NEARBY
- VIEWS OVER THE CHESTERFIELD CANAL
- QUIET LOCATION
- EPC RATED C

**£285,000**

Sell from  
**£995**  
Any Property  
Any Price

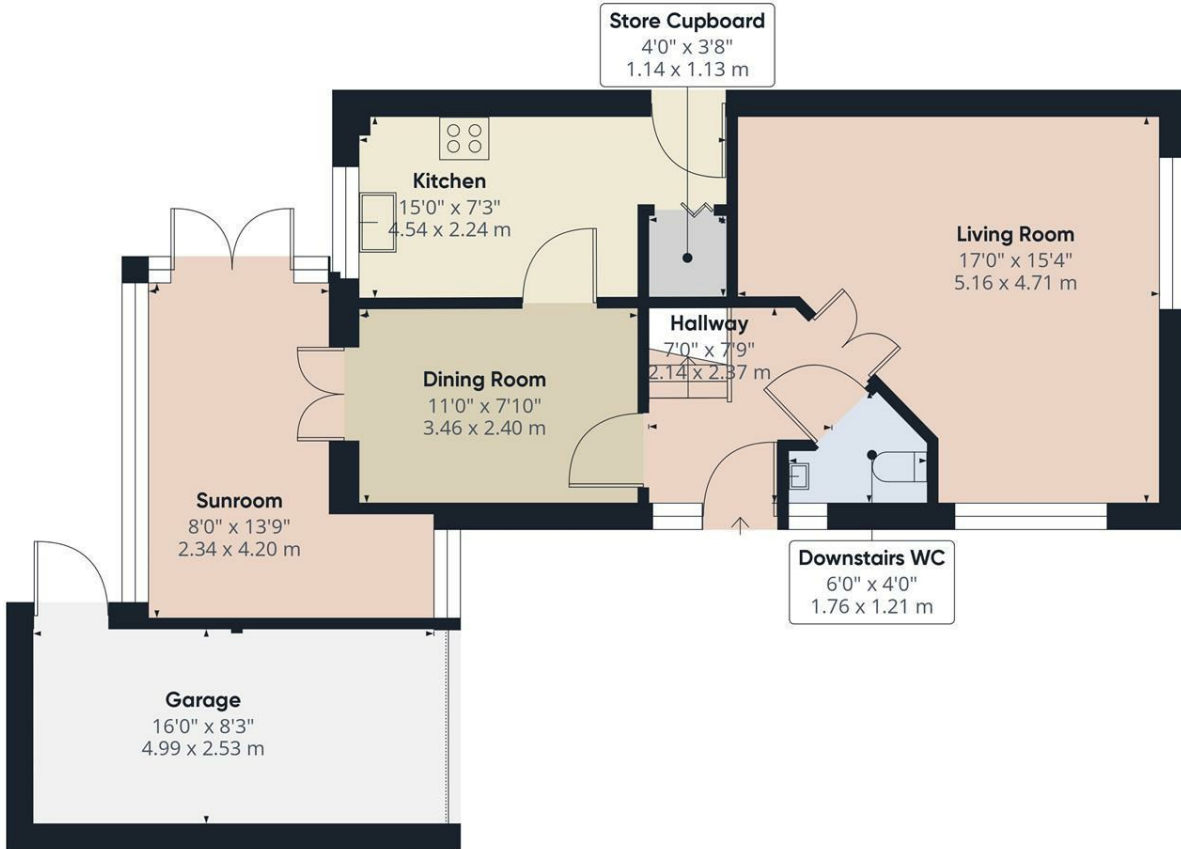

Approximate total area<sup>1)</sup>  
769.51 ft<sup>2</sup>  
71.49 m<sup>2</sup>

(1) Excluding balconies and terraces

While every attempt has been made to ensure accuracy, all measurements are approximate, not to scale. This floor plan is for illustrative purposes only.

GIRAFFE360

Ground Floor

