



18 Lindley Avenue

Latchford, Warrington, WA4 1QB

£270,000

THOUGHTFULLY EXTENDED SEMI DETACHED, FANTASTIC FAMILY HOME, BEAUTIFULLY PRESENTED WITH PLANTATION SHUTTERS THROUGHOUT, SPACIOUS LOUNGE/DINER, MODERN HIGH GLOSS FITTED KITCHEN, CONSERVATORY, FOUR GOOD SIZE BEDROOMS, MODERN SHOWER ROOM, DOWNSTAIRS WC, GARAGE CONVERSIONS, FABULOUS GARDENS & DRIVEWAY PARKING.

This Well Maintained and Loved Family Home will appeal to couples or families with its flexible living space and contemporary outdoor areas. The current owners have extended and altered this property to suit their growing family but now wish to downsize. The accommodation comprises Entrance Porch, Entrance Hallway, Lounge/Diner, Fitted Kitchen with space for appliances, Conservatory, Downstairs WC, Garage/Office, Four Bedrooms and a Modern Shower Room. Externally there is a gated, block paved driveway with adjacent front garden whilst the rear garden boasts a boutique trendy feel with its pergola, hidden paved area and low maintenance artificial grass.

Viewing

Please contact our Let n Sell Office on 07958 253511 if you wish to arrange a viewing appointment for this property or require further information.

- THOUGHTFULLY EXTENDED SEMI DETACHED
- FANTASTIC FAMILY HOME
- BEAUTIFULLY PRESENTED WITH PLANTATION SHUTTERS THROUGHOUT
- SPACIOUS LOUNGE/DINER
- MODERN HIGH GLOSS FITTED KITCHEN
- CONSERVATORY
- FOUR GOOD SIZE BEDROOMS
- MODERN SHOWER ROOM
- DOWNSTAIRS WC
- GARAGE CONVERSION, FABULOUS GARDENS & DRIVEWAY PARKING



4



1



2



D

Floor Plan

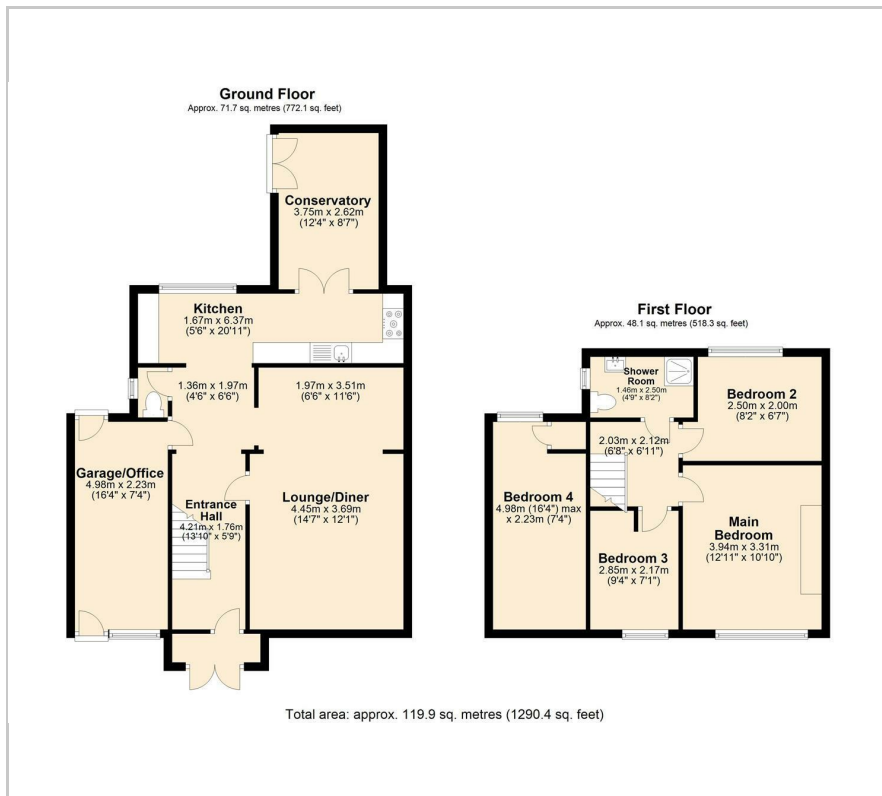

Area Map

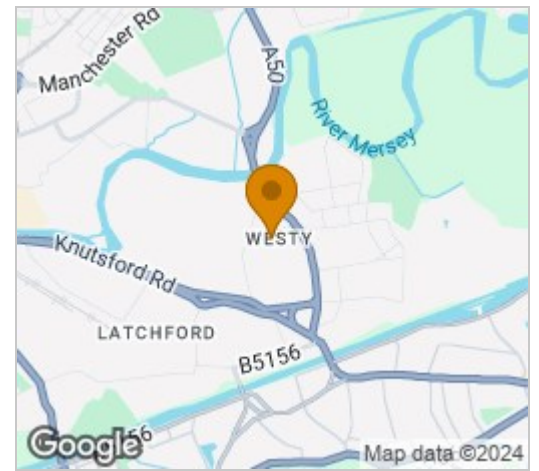

Energy Efficiency Graph

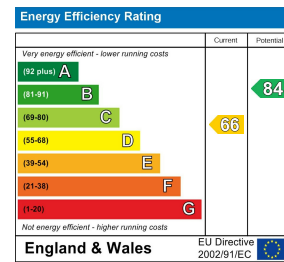

These particulars, whilst believed to be accurate are set out as a general outline only for guidance and do not constitute any part of an offer or contract. Intending purchasers should not rely on them as statements of representation of fact, but must satisfy themselves by inspection or otherwise as to their accuracy. No person in this firm's employment has the authority to make or give any representation or warranty in respect of the property.