



Offers over £155,000

Shoreside Cottage, 15 Balfour Village,  
Shapinsay, KW17 2DX

Harcus.





Offered for sale is this charming two-bedroom mid-terraced cottage. It boasts a generous layout and has been meticulously maintained, featuring a rear garden with an outbuilding, along with an additional front garden adjacent to the road by the water's edge.

Situated just a short stroll from the ferry terminal, this delightful home provides a unique opportunity to enjoy peaceful coastal living in a picturesque setting, with easy access to the Mainland.

Accommodation comprises Living room, Dining Kitchen, two double Bedrooms and a Bathroom.



2 bedroom



1 bathroom



1 public room



## Living room

4.27m x 3.93m (14ft x 12ft 11")

This delightful living room is carpeted with a wood burning stove set on a stone hearth providing a welcoming focal point. Soft, neutral tones complement the room's elegant decor, making it a perfect space for relaxation or entertaining guests. The space includes a built-in bookshelf, and a beautiful dresser is also included in the sale. Dimplex Quantum Storage Heater.







### **Kitchen**

4.73m x 2.77m (15ft 6" x 9ft 1")

This charming kitchen features floor and eye-level units, and provides ample storage and worktop space. It comes equipped with a cooker, fridge freezer and a washing machine. The dining area offers ample space for the table and chairs which are also included in the sale. Natural light is afforded through a window looking out to the rear garden. Dimplex Quantum Storage Heater .







### Bathroom

2.77m x 2.10m (9ft 1" x 6ft 10")

Well appointed bathroom fitted with a shower over the bath, W.C. and a wash hand basin. With a modesty glazed window and vinyl flooring. Airing cupboard. Heated towel rail.

### Bedroom 1

3.93m x 3.41m (12ft 11" x 11ft 2")

This spacious double bedroom benefits from windows at both the front and rear, allowing a good flow of natural light to fill the space. The room is carpeted with neutral decor, creating a welcoming and adaptable ambiance. Additional features include a tiled fireplace and an alcove with an integrated cupboard. Table and chairs are included in the sale. Dimplex Quantum Storage Heater.







## Bedroom 2

3.93m x 2.69m (12ft 11" x 8ft 10")

This double bedroom is carpeted and with neutral decor. A window looks out to the front of the property with views over Elwick Bay. The room includes a built-in wardrobe, along with an additional freestanding wardrobe, which is included in the sale. Dimplex Quantum Storage Heater.







At the front of the property, you'll find a generous lawned garden situated on the seaside of the road. This wonderful space provides direct access to the shore, where you can delight in observing seals basking in the sun. 2 x 330L Green Johanna Food Composter bins are included in the sale

The rear garden is similarly laid to lawn and features an outbuilding 6.09m x 4.94m (19ft 11" x 16ft 2") equipped with power and lighting. Additionally, there is also a greenhouse 2.65m x 1.89m (8ft 8" x 6ft 2").





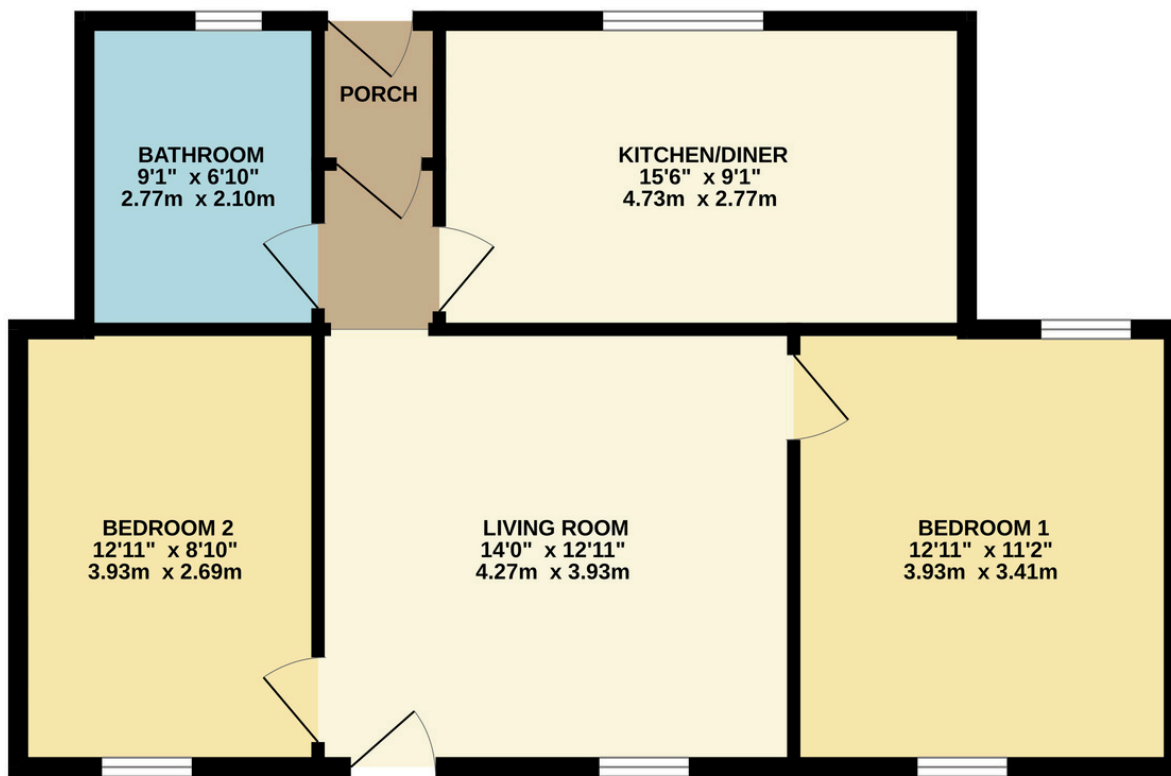

Shapinsay has much to offer and is conveniently commutable via the roll-on roll-off ferry service, which takes approximately 25 minutes to reach Kirkwall. The community features a store/post office, restaurant/cafe, primary school and a community centre that includes a doctor's surgery and fitness suite.





Shoreside Cottage has electric Quantum storage heating. Wooden double glazed windows and doors. Located in the Conservation Area and is a Category 'C' Listed building.

Viewing by Prior Arrangement.

## Services

Mains Services

## Council Tax

Band A. This may be reassessed when the property is sold.

## Energy Performance Certificate

Band D.

## Fixtures & fittings

All floor coverings, light fittings, white goods, dresser, wardrobe and two sets of tables and chairs are included in the sale.

## Price

Offers over £155,000

## Interested parties

Please note your interest to Harcus Law.

## Offers

Written offers should be submitted to Harcus Law.

## Arrange a viewing

### Contact us

Harcus Law  
13 Bridge Street Kirkwall, Orkney  
KW15 1HR

Opening hours:  
Monday to Friday 09:00 - 17:00  
Closed for an hour 13:00 - 14:00



01856 877 866



[enquiries@harcuslaw.co.uk](mailto:enquiries@harcuslaw.co.uk)

Harcus Property has produced the particulars of this property, including all photographs & measurements. They are intended to be a guide for prospective purchasers and are believed to be truthful as of May 2025. All measurements are approximate sizes only. Harcus Property will take no responsibility or liability for any mistakes or omissions made or any consequences thereof. The vendor maintains the right to withdraw the property from the market.