

High Street, Langford, Biggleswade, SG18 9RR

£280,000

 2  1  1



Charming & Beautifully Restored Two-Bedroom Victorian Cottage in the Heart of Langford with parking and garage

Key Features

- Beautifully Restored Victorian Cottage – Thoughtfully updated while preserving original charm
- Characterful Lounge – Features a stunning fireplace, picture rails, alcove cupboards, and shelving
- Spacious Newly Fitted Kitchen – Designed for modern living with ample storage and workspace
- Two Generous Double Bedrooms – Including a master with charming stripped floorboards and panelled walls.
- Characterful Brick Barn with Pan-Tiled Roof – Offering additional storage or potential workspace.
- Newly Fitted Acoustic Windows & Doors – Enhancing energy efficiency and maintaining period aesthetics
- Elegant Herringbone Hardwood Flooring – Adds warmth and sophistication throughout the ground floor.
- Refurbished Utility/Boot Room – Stylish panelled walls and a UPVC stable door leading to the courtyard.
- Large Enclosed Rear Garden – A perfect outdoor retreat with plenty of space for relaxation
- Off-Road Parking & Secure Garage – Providing parking for two cars and extra storage options.

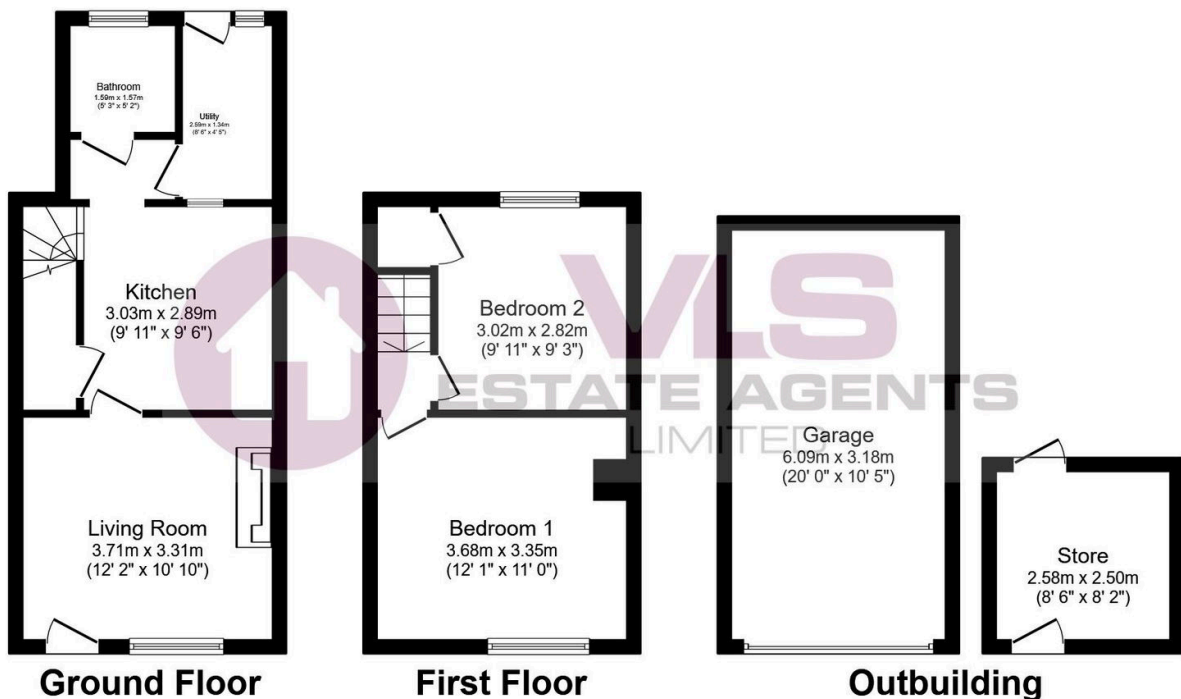

Total floor area 81.7 m² (879 sq.ft.) approx

This floor plan is for illustrative purposes only. It is not drawn to scale. Any measurements, floor areas (including any total floor area), openings and orientation are approximate. No details are guaranteed, they cannot be relied upon for any purpose and they do not form part of any agreement. No liability is taken for any error, omission or misstatement. A party must rely upon its own inspection(s). Powered by www.focalagent.com