



8 Muirfield, Luton, LU2 7SB

Nova are delighted to present this well maintained two bedroom property, ideally situated in a quiet cul-de-sac within the popular Bushmead development. Offering immediate availability, this home is perfect for couples or small families looking to settle in a highly desirable area.

Decorated in a modern and contemporary style throughout, the property offers comfortable and practical living. The accommodation briefly comprises: welcoming entrance area, spacious lounge with stairs to the first floor, a well-equipped kitchen with direct access to the private rear garden, two generously sized bedrooms and a fitted bathroom suite.

Additional features include:

- * Gas central heating
- * Enclosed rear garden

- Nova Estate Agents
- Press Play Button For 360° Walkaround Tour
- Available Now!
- 2 Bedroom Home
- Allocated Parking
- Private Rear Garden
- Popular Bushmead Location

£1,250 Per month

Approx Gross Internal Area
55 sq m / 597 sq ft

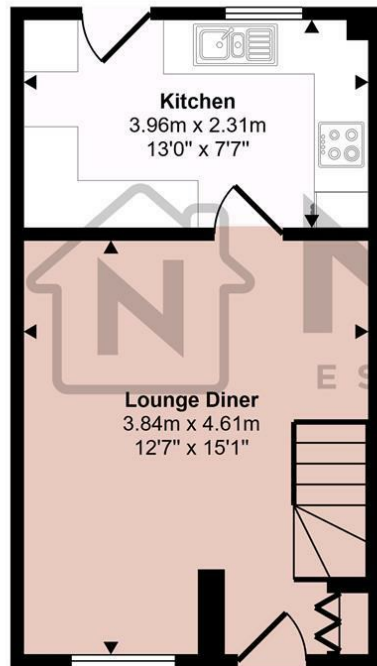

Ground Floor
Approx 27 sq m / 296 sq ft

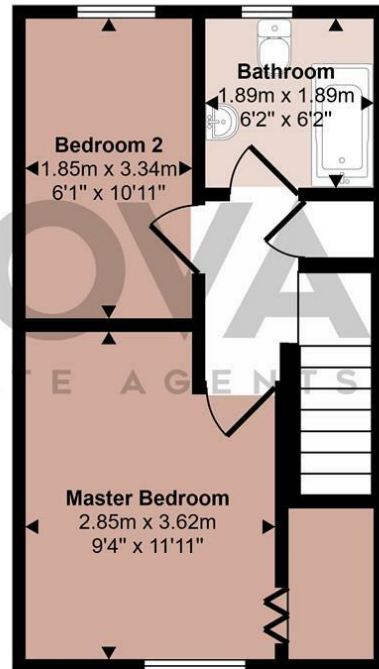

First Floor
Approx 28 sq m / 301 sq ft

This floorplan is only for illustrative purposes and is not to scale. Measurements of rooms, doors, windows, and any items are approximate and no responsibility is taken for any error, omission or mis-statement. Icons of items such as bathroom suites are representations only and may not look like the real items. Made with Made Snappy 360.

