



## 9, Moulton Court Moulton Rise, Luton, Beds, LU2 0AL

This beautifully refurbished 2 bedroom flat on Moulton Court offers modern living in an unbeatable location, just a 2-minute walk from the station, making it ideal for commuters. Featuring a brand new extended lease, the flat has been fully refurbished to a high standard with a bright and airy living area, a sleek fitted kitchen with two spacious bedrooms, and a contemporary tiled bathroom. Perfect for professionals, couples, or small families, this move-in ready home combines luxury and convenience. Being sold chain free, don't miss out, contact Nova Estate Agents today to arrange a viewing and make this fantastic property your new home!

- Nova Estate Agents
- Press Play Button For 360° Walkaround Tour
- 2 Double Bedroom Apartment
- Completely Refurbished
- Chain Free
- Long Lease of 149
- 5 Minute Walk From Luton Central Station
- Low Service Charge And Ground Rent

£175,000

Approx Gross Internal Area  
57 sq m / 617 sq ft

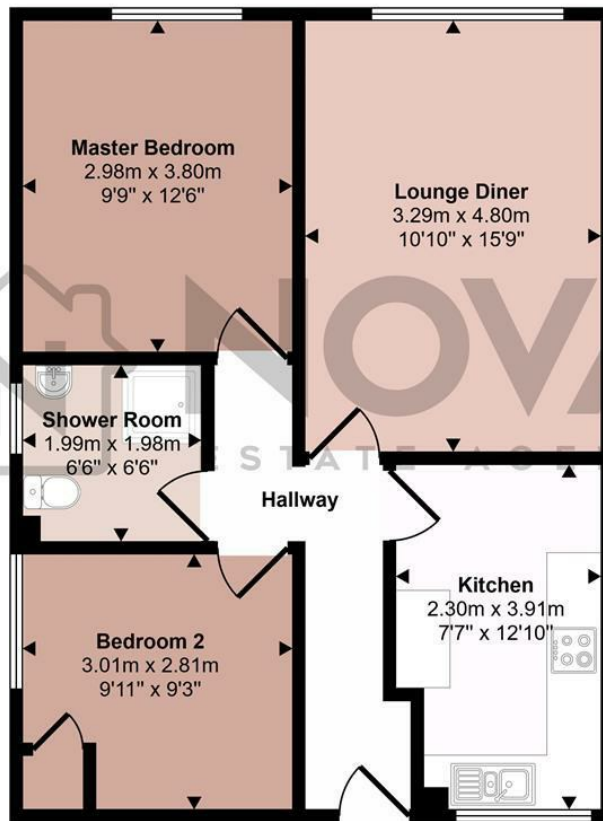

Floorplan

This floorplan is only for illustrative purposes and is not to scale. Measurements of rooms, doors, windows, and any items are approximate and no responsibility is taken for any error, omission or mis-statement. Icons of items such as bathroom suites are representations only and may not look like the real items. Made with Made Snappy 360.

