



25 Staten House Rillaton Walk, Milton Keynes, MK9 2BX

A stunning 2 bedroom apartment in the centre of Milton Keynes. This modern flat is ideally situated close to all the amenities, including shops, bars, and restaurants, making it the perfect place for those who want to be in the midst of it all. The apartment features two double bedrooms, providing spacious and comfortable living spaces, and a modern, stylish family bathroom with all essential amenities. The bright and airy lounge offers stunning views over the square, creating a welcoming atmosphere for relaxation and entertainment. Additional benefits include allocated underground parking for secure vehicle storage. Available on a part-furnished basis, this fantastic apartment will be ready for you in early August, allowing you to move in with ease and add your personal touch. Whether you're a professional looking for a convenient commute or a couple seeking a vibrant lifestyle, this property is perfect for you. Contact Nova Estate Agents today to arrange a viewing to secure this rarely available home.

- Nova Estate Agents
- Stunning 2 Bedroom Apartment in Central Milton Keynes
- Part Furnished
- Available Early August
- Allocated Parking
- Brilliant Location With All Amenities In Walking Distance
- 2 Double Bedrooms
- Brilliant Views

£1,400 Per month

Approx Gross Internal Area
59 sq m / 636 sq ft

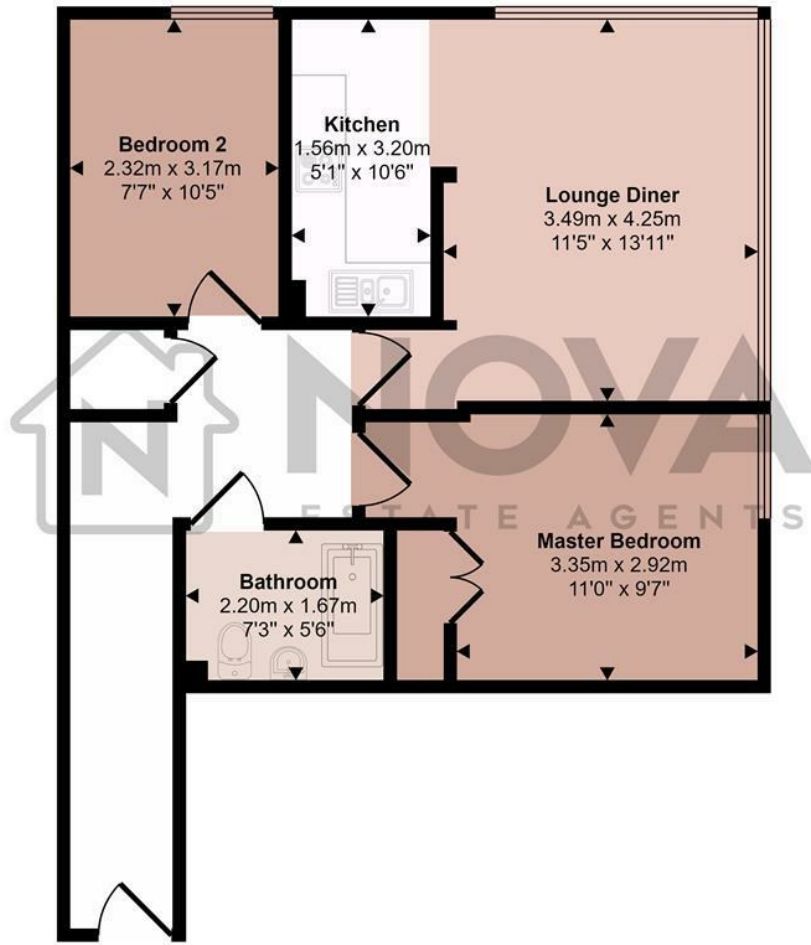

Floorplan

This floorplan is only for illustrative purposes and is not to scale. Measurements of rooms, doors, windows, and any items are approximate and no responsibility is taken for any error, omission or mis-statement. Icons of items such as bathroom suites are representations only and may not look like the real items. Made with Made Snappy 360.

Energy Efficiency Rating		Current	Potential
Very energy efficient - lower running costs			
(92 plus) A			
(81-91) B		82	82
(69-80) C			
(55-68) D			
(39-54) E			
(21-38) F			
(1-20) G			
Not energy efficient - higher running costs			
England & Wales	EU Directive 2002/91/EC		