



NOVA
ESTATE AGENTS



6 West Way, Putteridge, Luton, Bedfordshire, LU2 8DZ

Introducing this delightful 3 bedroom property, available for let in the sought after Putteridge area of Luton. This home offers comfortable living spaces, generous room sizes, a lovely garden, and the added convenience of a garage. With its excellent condition and desirable location, this property is perfect for those seeking a wonderful place to call home.

Upon entering, you'll be greeted by a welcoming hallway, providing access to the various rooms of the house. The spacious and well lit living room offers a perfect space for relaxation and entertainment. The large windows bathe the room in natural light, creating a warm and inviting atmosphere. There is a versatile kitchen to the rear of the property which leads onto a utility area further adding to the convenience of the property.

Upstairs, you will discover three generously sized bedrooms, each offering a comfortable space to relax in. The rooms are well proportioned, allowing for various furniture configurations and personal

- Nova Estate Agents
- Available Start August
- Unfurnished
- 3 Bedroom House
- Driveway
- Garage
- Large Rear Garden
- Summer Lounge Area
- Utility Room

£1,500 Per month

GROUND FLOOR

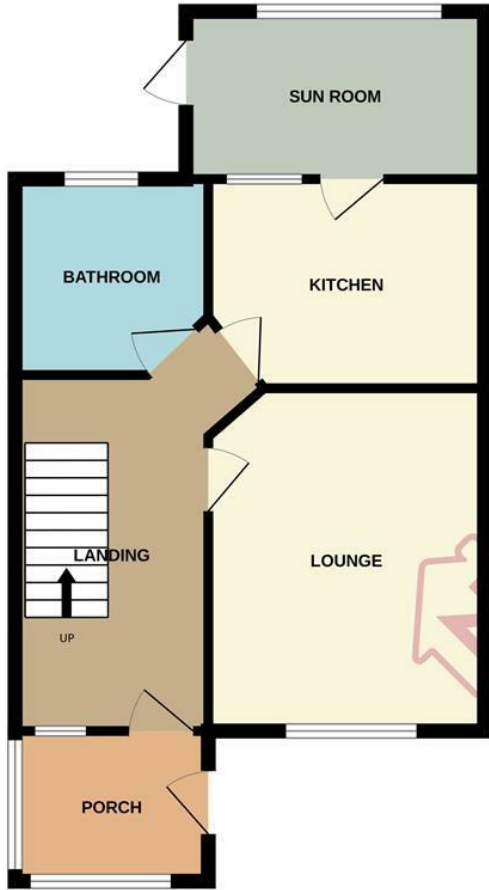

1ST FLOOR

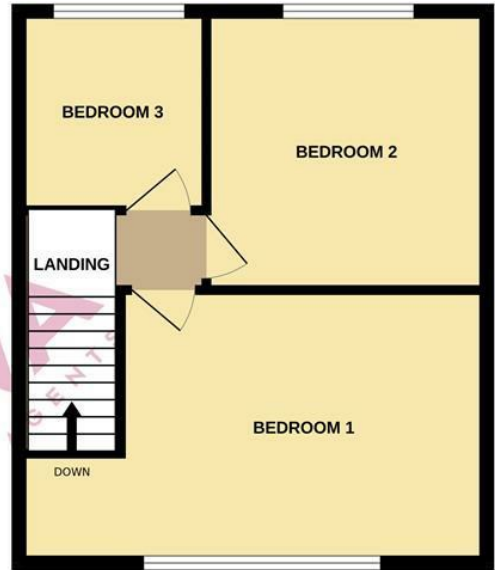

Whilst every attempt has been made to ensure the accuracy of the floorplan contained here, measurements of doors, windows, rooms and any other items are approximate and no responsibility is taken for any error, omission or mis-statement. This plan is for illustrative purposes only and should be used as such by any prospective purchaser. The services, systems and appliances shown have not been tested and no guarantee as to their operability or efficiency can be given.
Made with Metropix ©2023

Energy Efficiency Rating		Current	Potential
Very energy efficient - lower running costs			
(92 plus) A			90
(81-91) B			
(69-80) C		65	
(55-68) D			
(39-54) E			
(21-38) F			
(1-20) G			
Not energy efficient - higher running costs			
England & Wales		EU Directive 2002/91/EC	