



## 34 Ravenhill Way, Luton, LU4 0YS

Step into luxury living at Ravenhill Way, where sophistication meets contemporary design in this expansive six bedroom detached property. Boasting extensive extensions, this home offers spacious and versatile living areas, perfect for accommodating a modern family's lifestyle.

The highlight of the home is its sleek and modern kitchen, equipped with top of the line appliances and stylish finishes, ideal for culinary enthusiasts and hosting gatherings. Towards the rear is an extension that has been created with plenty of windows and a large pitched skylight window on the roof flooding the space with natural light, this really is the perfect area to unwind overlooking onto the garden.

With an open plan layout downstairs the ground floor is ideally suited to entertain whilst cooking, eating or socialising. There is also a separate living room if you wish for somewhere more private. On the first floor there are five good sized bedrooms, with the master bedroom having

- Nova Estate Agents
- Heavily Extended Home
- Open Plan Living
- High Spec Kitchen
- Modern Bathroom
- Good Size Bedrooms
- Detached
- Driveway and Garage

£550,000

GROUND FLOOR



1ST FLOOR



2ND FLOOR

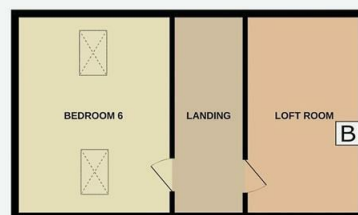

Whilst every attempt has been made to ensure the accuracy of the floorplan contained here, measurements of doors, windows, rooms and any other items are approximate and no responsibility is taken for any error, omission or mis-statement. This plan is for illustrative purposes only and should be used as such by any prospective purchaser. The services, systems and appliances shown have not been tested and no guarantee as to their operability or efficiency can be given.  
Made with Metropix ©2024

Energy Efficiency Rating		
	Current	Potential
<i>Very energy efficient - lower running costs</i>		
(92 plus) <b>A</b>		
(81-91) <b>B</b>		
(69-80) <b>C</b>		
(55-68) <b>D</b>		
(39-54) <b>E</b>		
(21-38) <b>F</b>		
(1-20) <b>G</b>		
<i>Not energy efficient - higher running costs</i>		
<b>England &amp; Wales</b>	EU Directive 2002/91/EC	