

# Flat 2, 234 Bowerham Road, Lancaster, Lancashire, LA1



**£145 Per Week**



Head Office: 83 Bowerham Road Lancaster LA1 4AQ  
T 01524 548888 E [enquiries@mightyhouse.co.uk](mailto:enquiries@mightyhouse.co.uk) W [www.mightyhouse.co.uk](http://www.mightyhouse.co.uk)



Mighty House is a trading name of P&PC Surveyors Limited. Registered Office: 70 Daisy Hill, Dewsbury, WF13 1LS. Company no: 06498054

\*\*\*Beautiful 6 Bed Property Available for the 2025/26 academic year\*\*\*

you have landed the perfect house for next year!

This is a substantial, 6 bedroom 6 bathroom property that certainly has the 'wow' factor.

Incredibly stylish, modern, has a boutique feeling and this property has had no expense spared in terms of finish.

Located in the highly desirable student area of Bowerham, this property is great for groups of 6.

£145 for Standard rooms and £165 for Kitchenette rooms.

The first floor consists of 2 bedrooms with kitchenettes and en-suites, 3 bedrooms with en-suites and 1 bedroom with its own separate bathroom.

It includes a large shared kitchen area and lounge!

This property can be secured with just a £400 deposit!!

All our students benefit from top level contents insurance including covering all your gadgets inside the property. What is even better is that if you choose Mighty Student Living you will also get other benefits such as the 'Mighty Card' - our local student discount card and entry to our competitions. To keep up to date with our latest giveaways, quality student houses and offers make sure to follow us on our Facebook, Twitter & Instagram page.

Give us a call today on 01524 544222 and we can schedule a viewing for you. We can also show you around 2 other properties we recommend on each viewing so you can have some peace of mind that

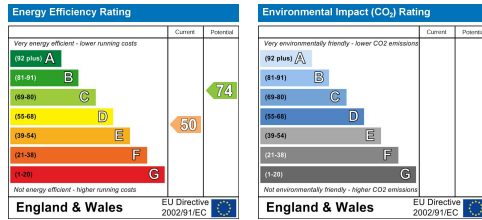



**Ground Floor**

Approx. 132.7 sq. metres (1428.2 sq. feet)

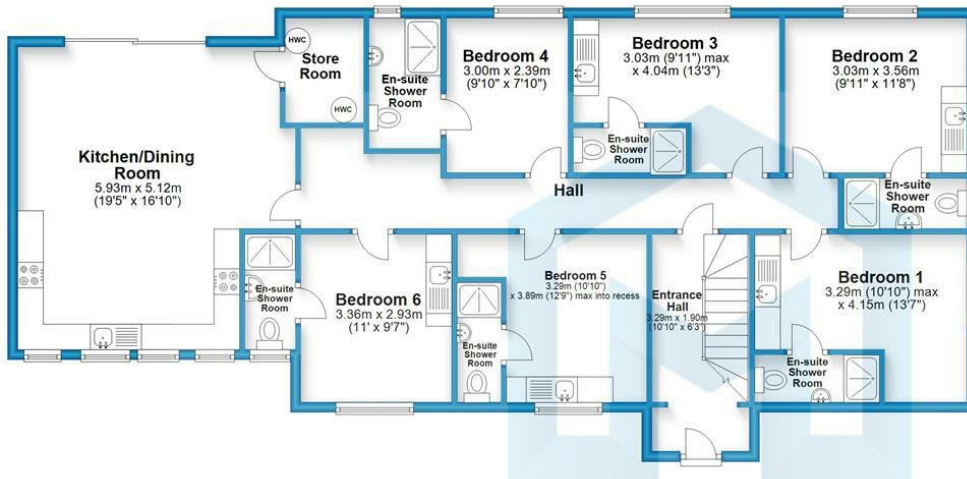

**First Floor**

Approx. 98.6 sq. metres (1061.3 sq. feet)

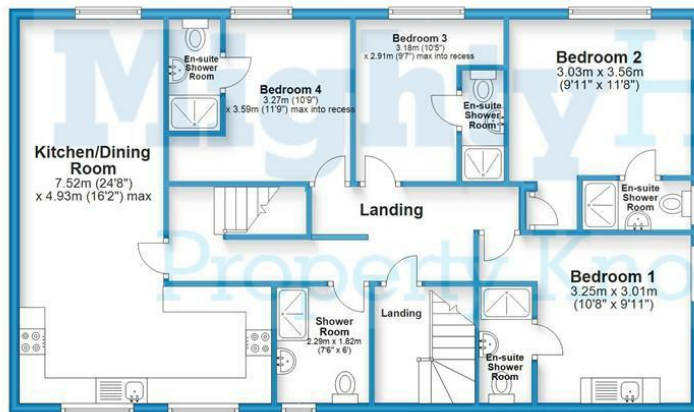

Total area: approx. 255.9 sq. metres (2754.1 sq. feet)

This floor plan is for illustrative purposes only and is not to scale. Where measurements are shown they are approximate and should not be relied on. No liability is accepted in respect to consequential loss arising from the use of this plan.  
Plan produced using PlanUp.

Bowerham Road, Lancaster

**Second Floor**

Approx. 24.6 sq. metres (264.5 sq. feet)

