

234 Bowerham Road, Lancaster, Lancashire, LA1 4JP



£145 Per Week



Head Office: 83 Bowerham Road Lancaster LA1 4AQ
T 01524 548888 E enquiries@mightyhouse.co.uk W www.mightyhouse.co.uk



Mighty House is a trading name of P&PC Surveyors Limited. Registered Office: 70 Daisy Hill, Dewsbury, WF13 1LS. Company no: 06498054

*****Beautiful 12 Bed En-suite Rooms Available for the 2025/26*****

This is a substantial property that certainly has the 'wow' factor. It is incredibly stylish, modern and has a boutique feeling, this property has had no expense spared in terms of finish.

Located in the highly desirable student area of Bowerham, this property is great for individuals or a variety of group sizes!!

This offers independent living without the high rental price!

£145 for standard rooms with no kitchenette and £165 for kitchenette rooms.

It includes a large shared kitchen area and lounge with lots of off street parking at the property.

This property can be secured for just a £400 deposit!!

All our students benefit from top level contents insurance including covering all your gadgets inside the property. What is even better is that if you choose Mighty Student Living you will also get other benefits such as the 'Mighty Card' - our local student discount card and entry to our competitions. To keep up to date with our latest giveaways, quality student houses and offers make sure to follow us on our Facebook, Twitter & Instagram page.

Give us a call today on 01524 544222 and we can schedule a viewing for you. We can also show you around 2 other properties we recommend on each viewing so you can have some peace of mind that you have landed the perfect house for next year!

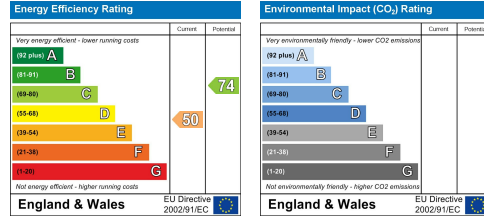

Ground Floor

Approx. 132.7 sq. metres (1428.2 sq. feet)

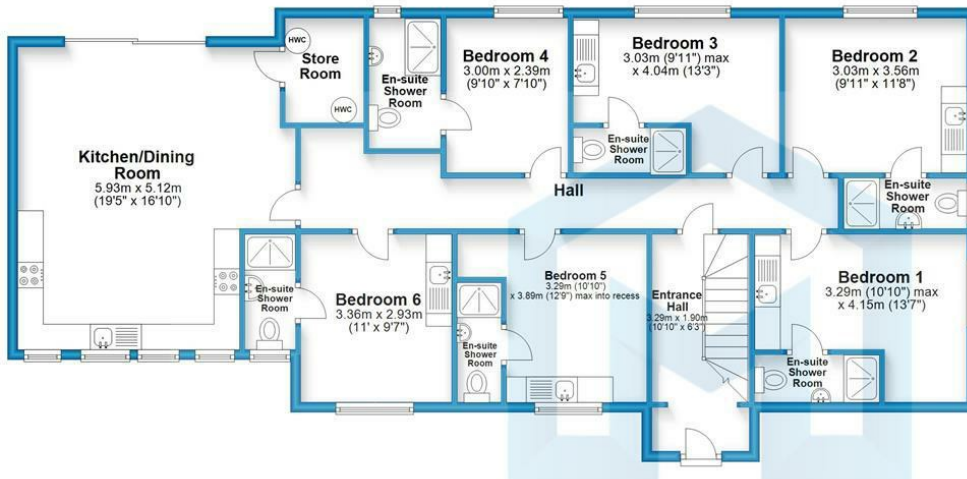

First Floor

Approx. 98.6 sq. metres (1061.3 sq. feet)

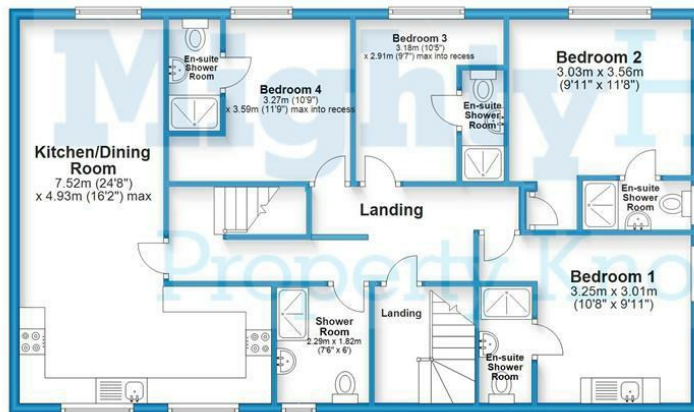

Total area: approx. 255.9 sq. metres (2754.1 sq. feet)

This floor plan is for illustrative purposes only and is not to scale. Where measurements are shown they are approximate and should not be relied on. No liability is accepted in respect to consequential loss arising from the use of this plan.
Plan produced using PlanUp.

Bowerham Road, Lancaster

Second Floor

Approx. 24.6 sq. metres (264.5 sq. feet)

