

35 Stirling Road, Moorlands, Lancaster, LA1 3DF



£144 Per Week



Head Office: 83 Bowerham Road Lancaster LA1 4AQ
T 01524 548888 E enquiries@mightyhouse.co.uk W www.mightyhouse.co.uk



Mighty House is a trading name of P&PC Surveyors Limited. Registered Office: 70 Daisy Hill, Dewsbury, WF13 1LS. Company no: 06498054

Excellent 3 bedroom house available for 2025/26

This lovely 3 bedroom property is in a great location very close to the town centre, University of Cumbria and transport links.

This house features 3 double bedrooms which include a wardrobe, double bed, chest of drawers, desk and chair.

Modern fitted kitchen with fridge, freezer, washing machine, microwave and oven. Plenty of cupboards, for storage. Lovely cosy lounge with sofas and TV, perfect for relaxing. This property comes fully furnished. There are also 3 bathrooms in this property which is rare!

All bills are included! Enquire TODAY and book your viewing!

We also offer 'Noposit' instead of a traditional deposit - for all information on this, please see the Noposit page of our website:
<https://mightystudentliving.co.uk/noposit>

More about living with Mighty Student Living...

All our students benefit from top level contents insurance including covering all your gadgets inside the property. You also get the benefits of the 'Mighty Card' - our local student discount card and entry to our competitions. To keep up to date with our latest giveaways, quality student houses and offers make sure to follow us on our Facebook, Twitter & Instagram page.

Please let us know if you wish to view and we can schedule an online video viewing in the first instance. If you are interested in the property, a physical viewing can be arranged.

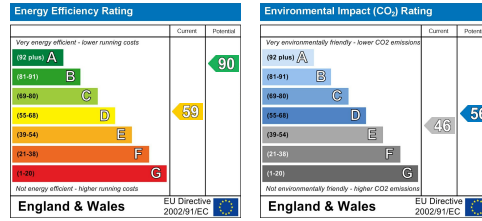

Head Office: 83 Bowerham Road Lancaster LA1 4AQ
T 01524 548888 E enquiries@mightyhouse.co.uk W www.mightyhouse.co.uk



Mighty House is a trading name of P&PC Surveyors Limited. Registered Office: 70 Daisy Hill, Dewsbury, WF13 1LS. Company no: 06498054

Ground Floor

Approx. 34.0 sq. metres (365.6 sq. feet)

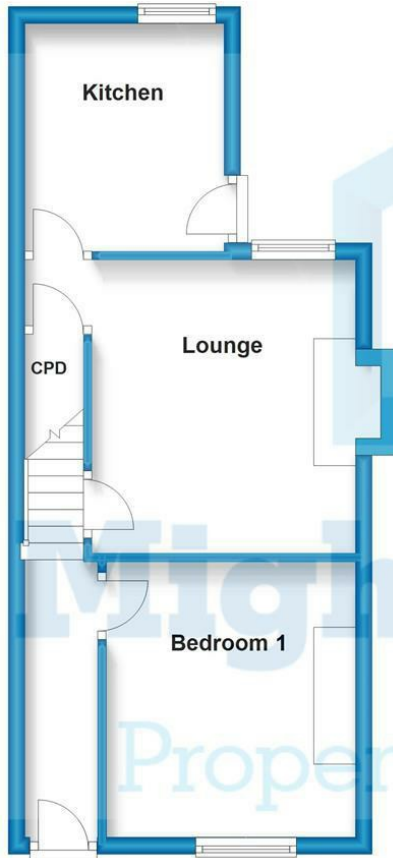

First Floor

Approx. 34.5 sq. metres (370.9 sq. feet)

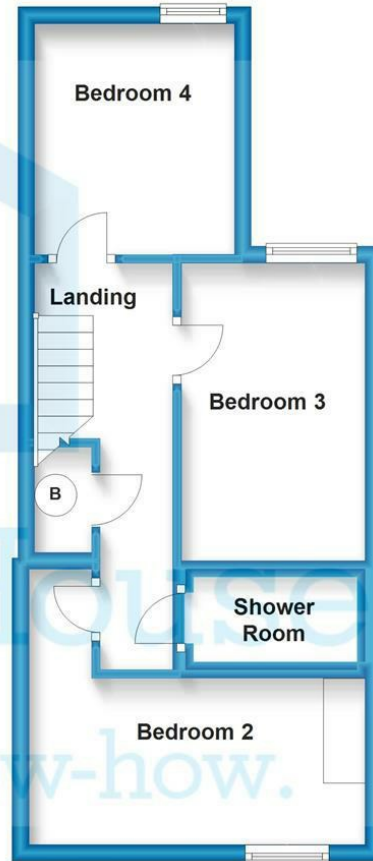

Total area: approx. 68.4 sq. metres (736.4 sq. feet)

This floor plan is for illustrative purposes only and is not to scale. Where measurements are shown they are approximate and should not be relied on. No liability is accepted in respect to consequential loss arising from the use of this plan.
Plan produced using PlanUp.