

AUCTION GUIDE

£199,000

Hounslow Road

Twickenham, TW2 7HB

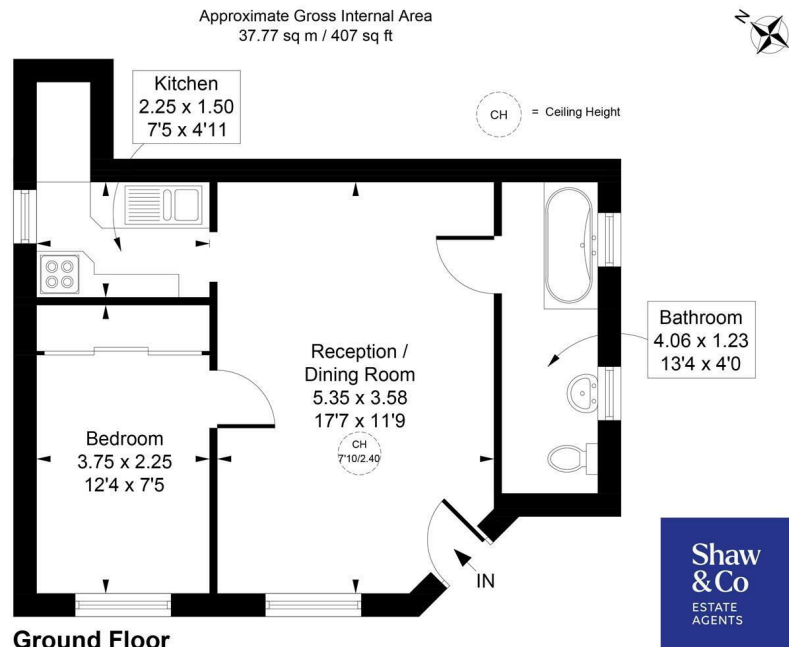

Whilst every attempt has been made to ensure the accuracy of the floor plan contained here, measurements of doors, windows, rooms and any other items are approximate and no responsibility is taken for any error, omission, or mis-statement. This plan is for illustrative purposes only and should be used as such by any prospective purchase.
© Vizion Property Marketing Produced for Shaw & Co.

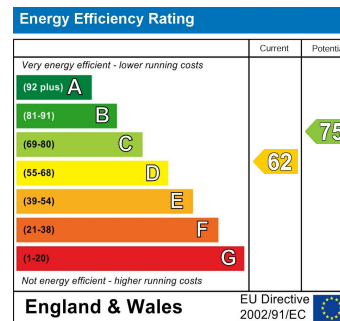
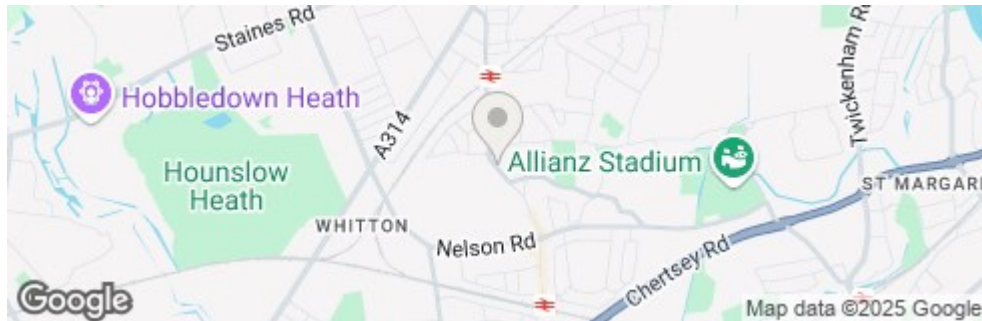

- One Bedroom Maisonette
- Share of Freehold
- Allocated Parking For One Car
- Richmond Upon Thames Borough
- Being Sold via Secure Sale. Terms & Conditions apply
- Ground Floor
- No Service Charge / No Ground Rent
- No Onward Chain
- Ideally Situated Between The Vibrant High Streets Of Whitton And Hounslow

Agents Note: These particulars are for guidance only. All measurements area approximate and should be rechecked by buyers / tenants. While care has been taken to ensure accuracy, they should be solely relied upon.

Shaw & Co
ESTATE AGENTS

OFFICE ADDRESS
Whitton
Twickenham
TW2 7LT

OFFICE DETAILS
0208 894 3646
whitton@shawandcoestates.com