

£694,950

Staines Road East

Sunbury-On-Thames, TW16 5AY

Staines Road, Sunbury On Thames

Approximate Gross Internal Area
1227 sq ft - 114 sq m

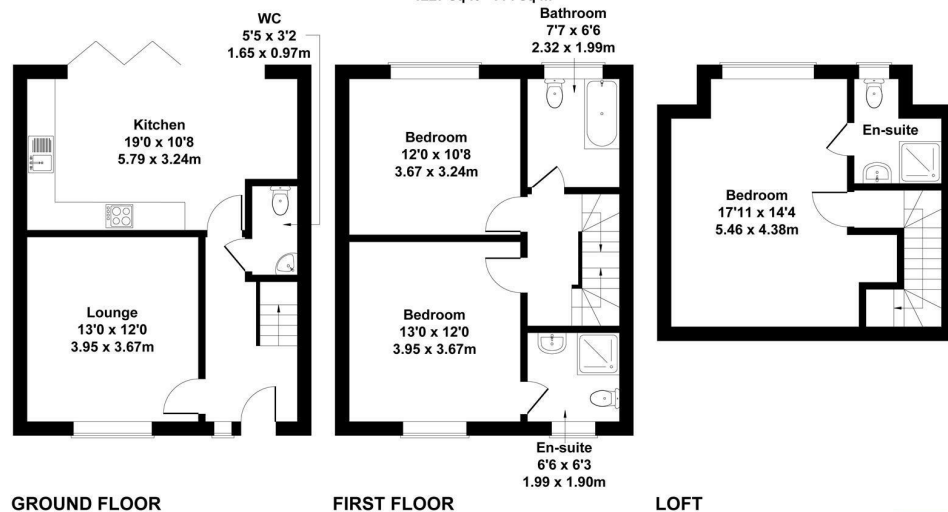

Not to Scale. Produced by The Plan Portal 2025
For Illustrative Purposes Only.

Shaw
& Co

3



3



1

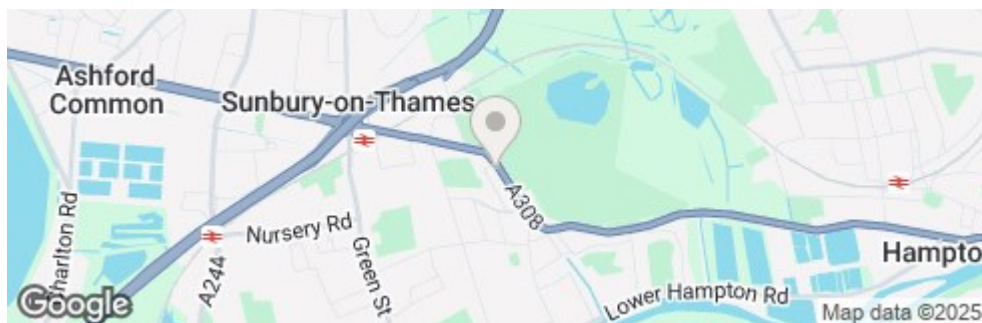

Energy Efficiency Rating		
	Current	Potential
Very energy efficient - lower running costs		
(92 plus) A		
(81-91) B		
(69-80) C		
(55-68) D		
(39-54) E		
(21-38) F		
(1-20) G		
Not energy efficient - higher running costs		
England & Wales	EU Directive 2002/91/EC	

- New Build Home - Built in 2025
- 10 Year New Build Warranty
- Underfloor Heating
- EV Charging Point
- Family Bathroom
- 3 Bedroom Semi Detached
- Contemporary Design
- Fully Fitted Kitchen Appliances
- Two Ensuites
- Ground Floor Cloakroom W/C

Agents Note: These particulars are for guidance only. All measurements area approximate and should be rechecked by buyers / tenants. While care has been taken to ensure accuracy, they should be solely relied upon.

**Shaw
& Co**
ESTATE
AGENTS

OFFICE ADDRESS
Whitton
Twickenham
TW2 7LT

OFFICE DETAILS
0208 894 3646
whitton@shawandcoestates.com