

£600,000

Nelson Gardens

Hounslow, TW3 3UJ

Nelson Gardens Whitton, Hounslow, TW3 3UJ

Approximate Gross Internal Area
1399 sq ft - 130 sq m

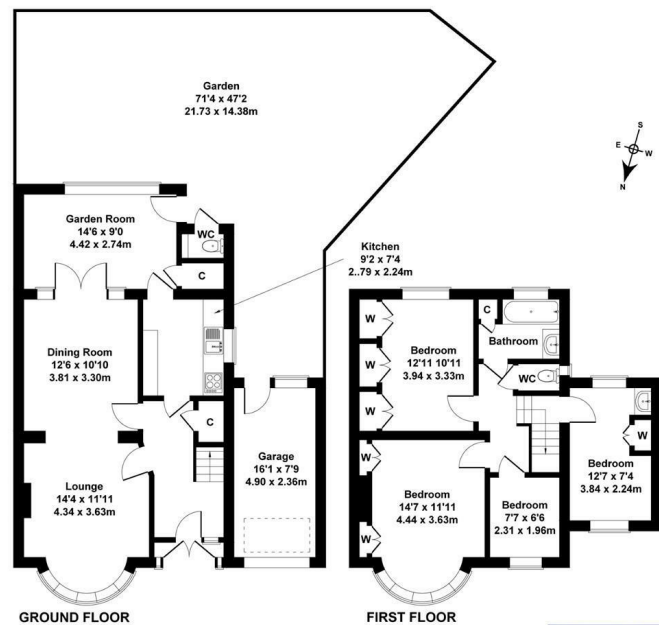

Not to Scale. Produced by The Plan Portal 2024
For Illustrative Purposes Only.

Shaw & Co
ESTATE AGENTS

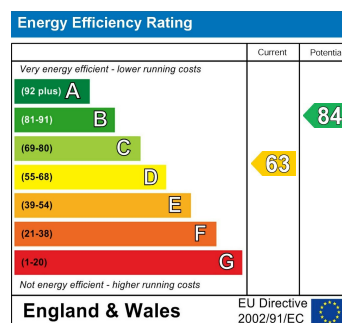

- 4-Bedroom Semi-Detached
- Chain Free
- Extended
- Driveway
- Large South Facing Rear Garden
- Garage
- Whitton Borders

Agents Note: These particulars are for guidance only. All measurements area approximate and should be rechecked by buyers / tenants. While care has been taken to ensure accuracy, they should be solely relied upon.

Shaw
& Co
ESTATE
AGENTS

OFFICE ADDRESS
Whitton
Twickenham
TW2 7LT

OFFICE DETAILS
0208 894 3646
whitton@shawandcoestates.com