

**Shaw  
& Co**  
ESTATE  
AGENTS

**£450,000**  
**Belgrave Road**  
Hounslow, TW4 7BY

Shaw  
& Co



## PROPERTY SUMMARY

Shaw & Co present this three-bedroom mid-terrace home located in a Hounslow. This property offers convenient access to Hounslow town centre, Hounslow West Tube station, local shops, highly regarded schools, and excellent transport links.

The ground floor features a spacious lounge, W/C and a large kitchen/diner, perfect for family living and entertaining. Upstairs, you'll find three well-proportioned bedrooms and a family bathroom.

Externally, the property benefits from both front and rear gardens, providing outdoor space for relaxation or gardening. Additional features include double-glazed windows throughout and district heating for added comfort and efficiency.

An ideal choice for families or investors seeking a home in this prime location.

3



1



1







**Approximate Gross Internal Area**  
**963 sq ft - 89 sq m**

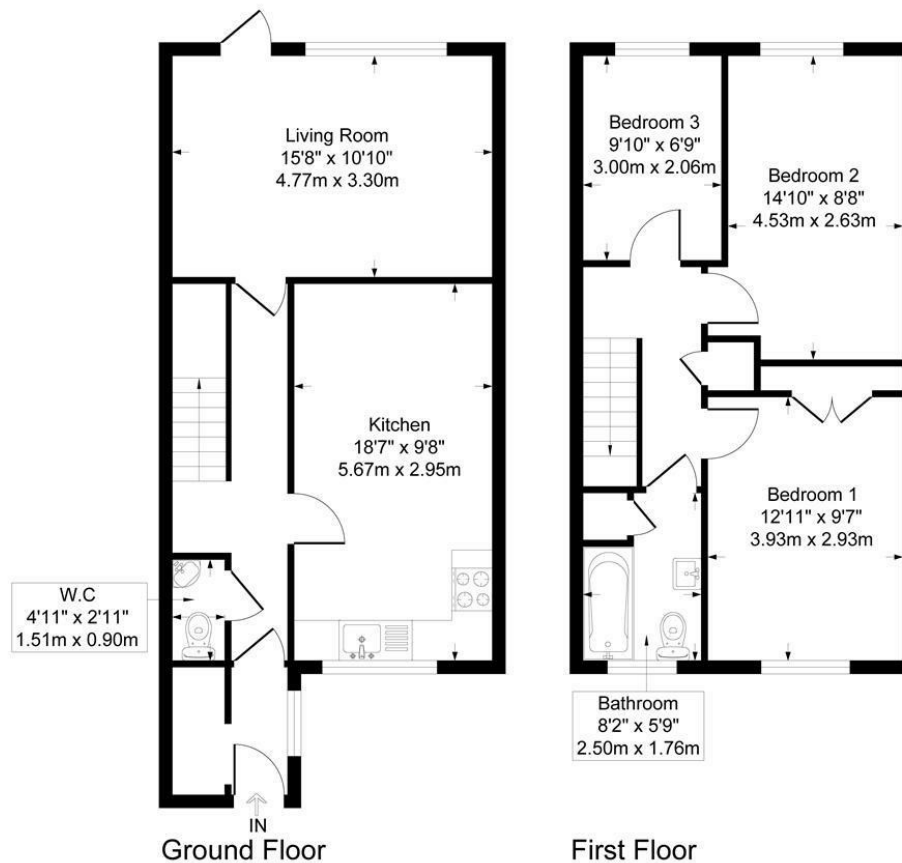

Although every attempt has been made to ensure accuracy, all measurements are approximate.  
 This floorplan is for illustrative purposes only and not to scale.  
 Measured in accordance with RICS Standards.

**LOCAL AUTHORITY**

Hounslow

**TENURE**

Freehold

**COUNCIL TAX BAND**

D

**VIEWINGS**

By prior appointment only

Energy Efficiency Rating		
	Current	Potential
Very energy efficient - lower running costs		
(92 plus) A		91
(81-91) B	77	
(69-80) C		
(55-68) D		
(39-54) E		
(21-38) F		
(1-20) G		
Not energy efficient - higher running costs		
England & Wales	EU Directive 2002/91/EC	



Agents Note: Whilst every care has been taken to prepare these particulars, they are for guidance purposes only. All measurements are approximate and are for general guidance purposes only and whilst every care has been taken to ensure their accuracy, they should not be relied upon and potential buyers/tenants are advised to recheck the measurements

**Shaw  
& Co**  
 ESTATE  
 AGENTS

**OFFICE ADDRESS**

Whitton  
 Twickenham  
 TW2 7LT

**OFFICE DETAILS**

0208 894 3646  
 whitton@shawandcoestates.com