

Shaw & Co
ESTATE AGENTS

£650,000

Nelson Gardens

Hounslow, TW3 3UJ

PROPERTY SUMMARY

CHAIN FREE. We are delighted to present this spacious extended family home on the Whitton borders, situated within the London Borough of Richmond.

The ground floor features an entrance hall, a living/dining room, a garden room, a fitted kitchen, and a convenient downstairs W/C. The first floor comprises four bedrooms and a bathroom with a separate W/C.

Additional benefits include a large mature south-facing garden, a garage, and off-street parking.

4



2



2





Nelson Gardens Whitton, Hounslow, TW3 3UJ

Approximate Gross Internal Area
1399 sq ft - 130 sq m

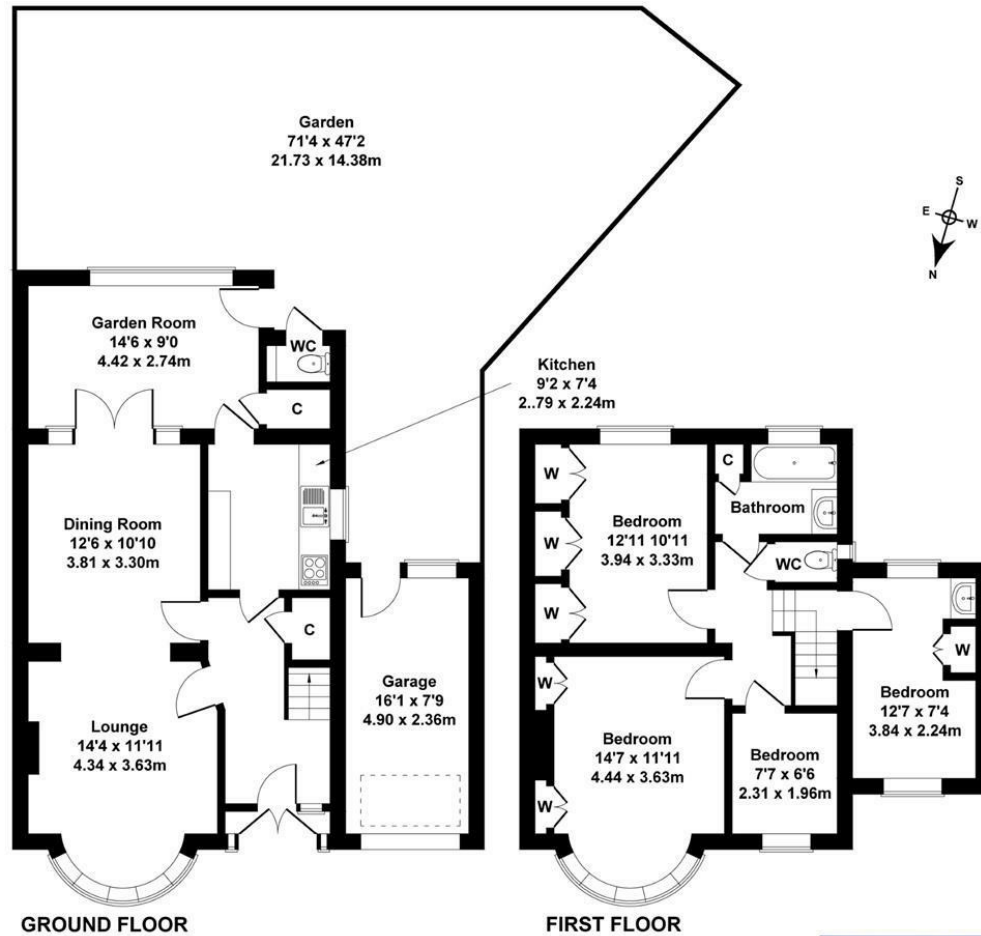

GROUND FLOOR

FIRST FLOOR

Not to Scale. Produced by The Plan Portal 2024
For Illustrative Purposes Only.



LOCAL AUTHORITY
Richmond Upon Thames

TENURE
Freehold

COUNCIL TAX BAND
E

VIEWINGS
By prior appointment only

Energy Efficiency Rating		Current	Potential
Very energy efficient - lower running costs			
(92 plus) A			84
(81-91) B			
(69-80) C			
(55-68) D		63	
(39-54) E			
(21-38) F			
(1-20) G			
Not energy efficient - higher running costs			
England & Wales		EU Directive 2002/91/EC	



Agents Note: Whilst every care has been taken to prepare these particulars, they are for guidance purposes only. All measurements are approximate and are for general guidance purposes only and whilst every care has been taken to ensure their accuracy, they should not be relied upon and potential buyers/tenants are advised to recheck the measurements

Shaw & Co
ESTATE AGENTS

OFFICE ADDRESS

Whitton
Twickenham
TW2 7LT

OFFICE DETAILS

0208 894 3646
whitton@shawandcoestates.com