





# Caernarvon Close, Hatherley, Cheltenham, GL51

£295,000

3 1 1



- Three Bedrooms
- Gas Central Heating
- Kitchen/Diner To Rear
- Conservatory
- Terraced
- Garage With Parking
- Hatherley Location
- Low Maintenance Rear Garden





This is a splendid three bedroom mi-terraced property situated in a popular location. The house has all schooling on its doorstep and would be a perfect starter family home.

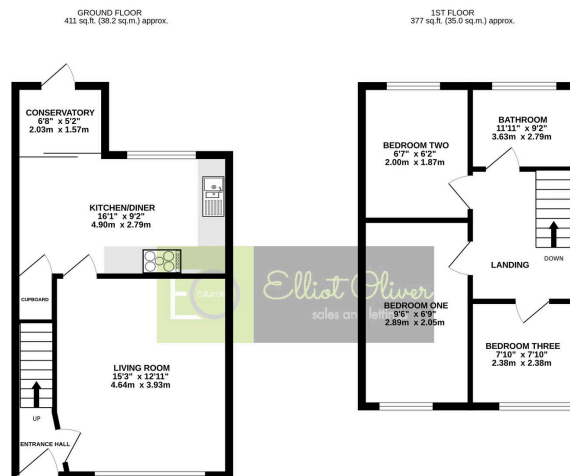

**TOTAL FLOOR AREA:** 788 sq.ft. (73.2 sq.m.) approx.

While every attempt has been made to ensure the accuracy of the floorplans contained here, measurement of floor, window, ceiling, and door dimensions are approximate and not guaranteed. It is to be used for reference only, and not for construction or other purposes. This plan is for illustrative purposes only and should be used as such by the prospective purchaser. The services, systems and appliances shown have not been tested and no guarantee as to their operability or efficiency can be given.

Made with Metropac 03025