



The Printworks, Lansdown Crescent Lane, Cheltenham, GL50

£500,000

🛏️ 2 🚿 2 🛋️ 1



- Three-storey layout offering ample living space across multiple levels
- Spacious ground-floor double bedroom with en-suite shower room
- Modern kitchen
- Charming courtyard area, providing additional outdoor space
- Garage
- Open-plan first-floor living area
- Luxurious top-floor master bedroom with en-suite bathroom, featuring a separate bathtub and shower.
- Prime location with short walking distance to the desirable Montpellier district in Cheltenham



A modern three-storey townhouse near Montpellier, featuring an open plan living area, two bathrooms, two double bedrooms, and courtyard.

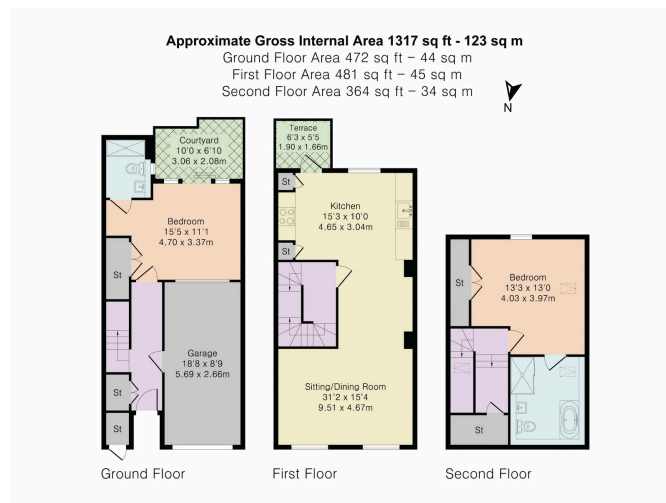

PINK PLAN

Although Pink Plan Ltd ensures the highest level of accuracy, measurements of doors, windows and rooms are approximate and no responsibility is taken for error, omission or misstatement. These plans are for representation purposes only as defined by RICS code of measuring practice. No guarantee is given on total square footage of the property within this plan. The figure shown is for initial guidance only and should not be relied on as a basis of valuation.

1000 Limited Property History

