



Napier House, Pittville Lawn, Cheltenham, GL52

£375,000

🛏 2 🚿 2 🛋 1



- Grade II Listed
- Two Bedrooms
- Spacious Living Room
- Off Road Parking Space
- EV Charger Point
- En-suite Shower
- Communal Gardens
- First Floor
- Permit Parking
- Vibrant Location



This exquisite two-bedroom apartment, a Grade II listed gem, is situated in the heart of Cheltenham, just a stone's throw from the tranquil Pittville Park and the thrill of the renowned Cheltenham Racecourse. Combining period elegance with modern conveniences, the property offers easy access to the vibrant town centre, making it an ideal location for both relaxation and entertainment.



Approximate Gross Internal Area 1085 sq ft - 101 sq m

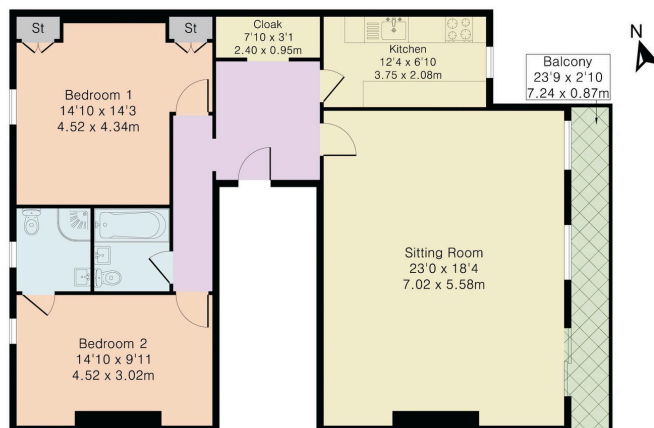

First Floor

