



Tommy Taylors Lane, Pittville, Cheltenham, GL50

£425,000

3 1 1



- Three Well-Proportioned Bedrooms
- Semi-Detached house
- Open-Plan Kitchen/Dining/Sitting Room
- Modern Family Bathroom
- Outbuilding
- Ample Off-Street Parking
- Private Rear Garden
- Scenic Views of Malvern Hills
- Prestbury Location



A spacious three-bedroom semi-detached home in sought-after Prestbury, boasting a stunning open-plan kitchen/living space, modern bathroom, outbuilding with office and utility, ample parking, and a private garden. Enjoy breathtaking views of Malvern Hills.

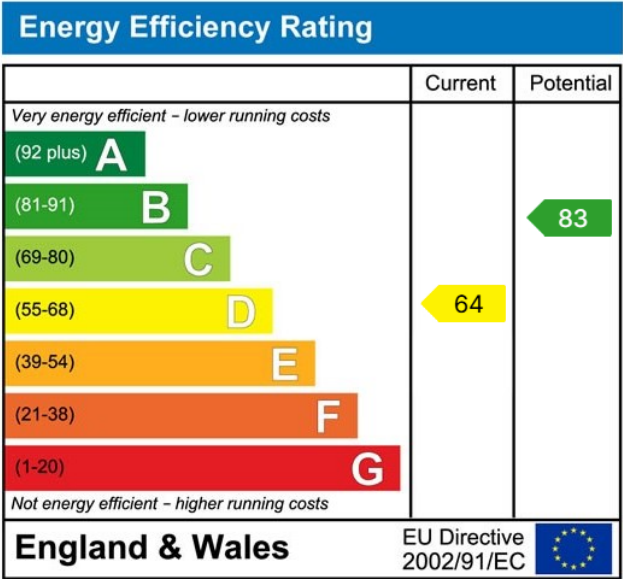
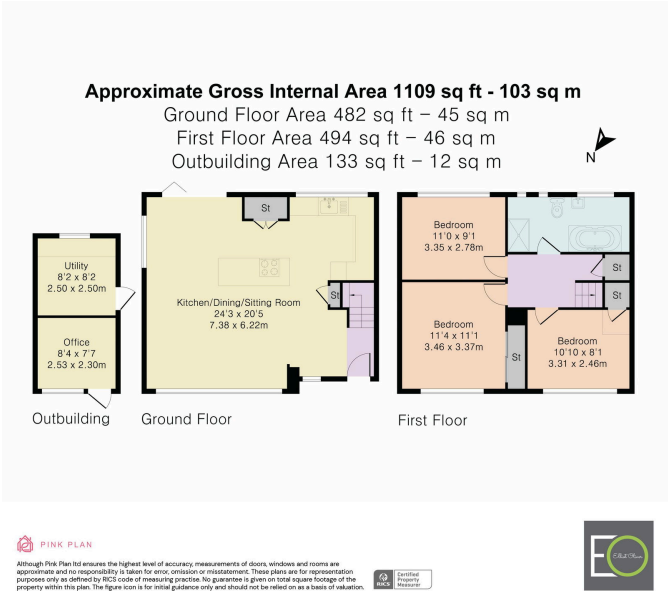

Elliot Oliver Sales

101 Promenade, Cheltenham GL50 1NW
01242 321091
www.elliottoliver.co.uk

