



Lansdown Crescent, Lansdown, Cheltenham, GL50

£180,000

🛏️ 1 🚿 1 🚗 1



- One Double Bedroom
- Top Floor Apartment
- Views of Leckhampton Hill
- Regency Grade Two Listed Building
- Walking Distance To The Town Centre
- No Onward Chain
- Permit Parking
- Communal Gardens



This beautifully presented top floor regency is located in a beautiful regency building in the Lansdown area of Cheltenham with impressive views across the Town and Leckhampton Hill. Offered to the market with no onward chain the property comprises of: entrance hall leading to modern kitchen with integrated appliances and breakfast bar, good sized living room, shower room and generous double bedroom. The property has sash windows throughout allowing plenty of natural light. Further benefiting from on road parking, & a communal garden.

TOP FLOOR
384 sq.ft. (35.7 sq.m.) approx.

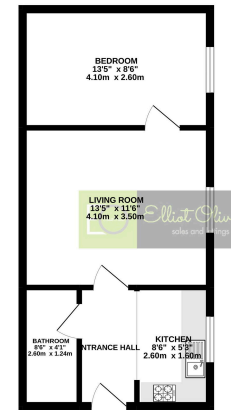

TOTAL FLOOR AREA: 384 sq.ft. (35.7 sq.m.) approx.
Where every effort has been made to ensure the accuracy of the floorplan information, representations are made without liability for any errors or omissions and the purchaser is advised to verify the information by independent professional means. The purchaser is advised to verify the information by independent professional means. The purchaser is advised to verify the information by independent professional means.

TOP FLOOR
384 sq.ft. (35.7 sq.m.) approx.



TOTAL FLOOR AREA: 384 sq.ft. (35.7 sq.m.) approx.
Where every effort has been made to ensure the accuracy of the floorplan information, representations are made without liability for any errors or omissions and the purchaser is advised to verify the information by independent professional means. The purchaser is advised to verify the information by independent professional means. The purchaser is advised to verify the information by independent professional means.

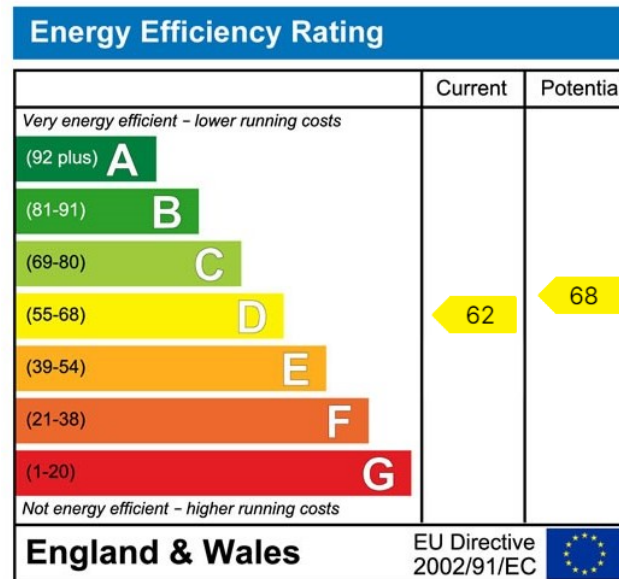

Elliot Oliver Sales
 101 Promenade, Cheltenham GL50 1NW
 01242 321091
 www.elliottoliver.co.uk

