



Tawny Close, Bishops Cleeve, Cheltenham, GL52

£290,000

3 1 0





This is a well presented three bedroom, end of terrace is situated in a well established cul-de-sac in Bishops Cleeve built by Bovis Homes.

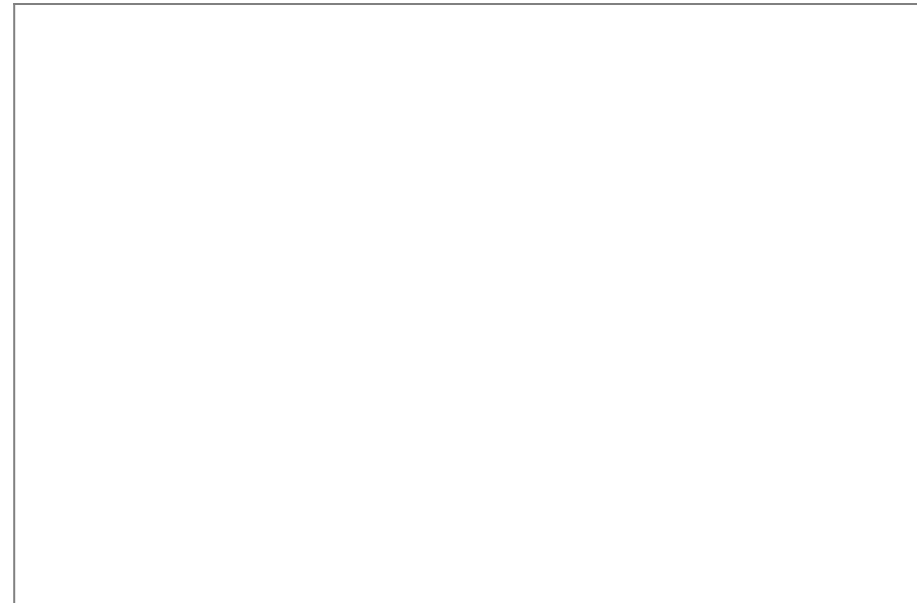
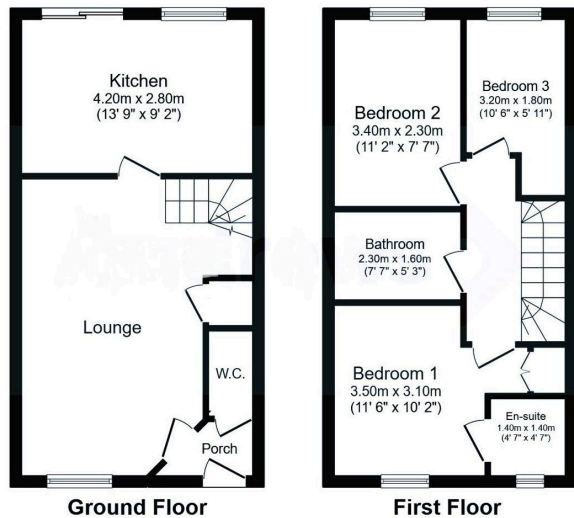

Cheltenham, Bishops Cleeve, GL52
 Total floor area 69.7 sq.m. (750 sq.ft.) approx
 This floor plan is for illustrative purposes only. It is not drawn to scale. Any measurements, floor areas (including any total floor area), openings and orientation are approximate. No details are guaranteed, they cannot be relied upon for any purpose and they do not form part of any agreement. No liability is taken for any error, omission or misstatement. A party must rely upon its own inspection(s). Plan produced for Andrews. Powered by www.focalagent.com



Elliot Oliver Sales
 101 Promenade, Cheltenham GL50 1NW
 01242 321091
 www.elliottoliver.co.uk

