



# Washpool Road, Bishops Cleeve, Cheltenham, GL52

£230,000

🛏️ 2 🚿 1 🚗 1



- Two double bedrooms
- Walking Distance Of The Village
- Bright and Spacious Open Plan Living
- Inbuilt Storage
- Easy access to amenities
- Coach House
- Very Well Presented
- Family bathroom
- Garage



This is a wonderful two bedroom detached coach house set within a quarter of a mile from the Bishops Cleeve village centre. This property comes to the market with no onward chain.

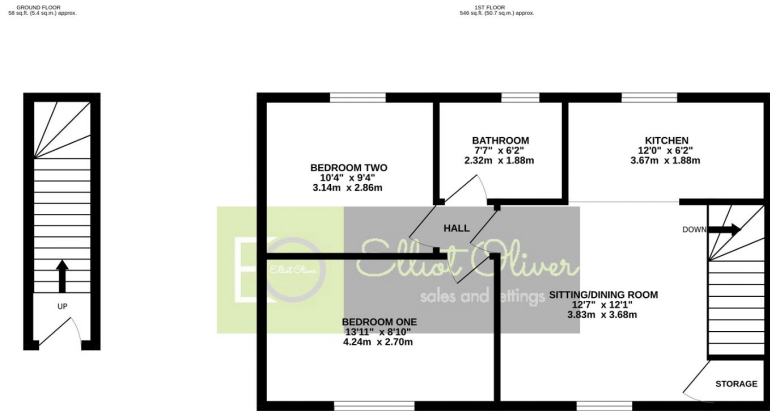

TOTAL FLOOR AREA - 604 sq ft (56.1 sq m) approx.  
 While every attempt has been made to ensure the accuracy of the floorplan contained here, measurements of doors, windows, rooms and any other items are approximate and no responsibility is taken for any error, omission or mis-statement. This plan is for illustrative purposes only and should be used as such for any prospective purchaser. The services, systems and apparatus shown have not been tested and no guarantee as to their operability or efficiency can be given.  
 Made with Neopex ©2021

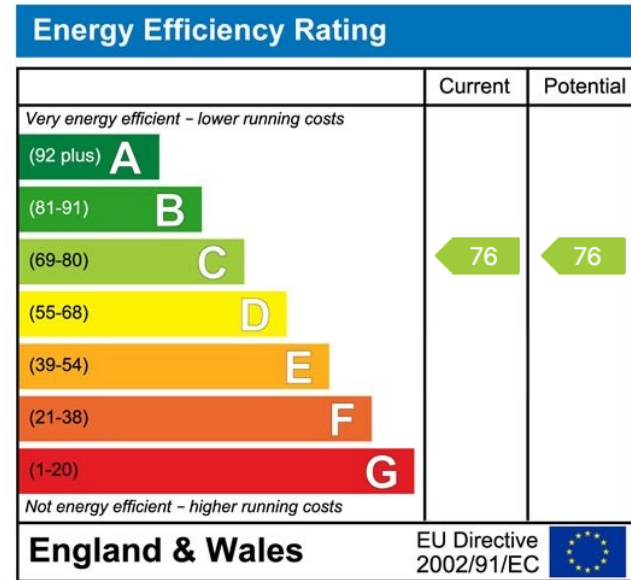

Elliot Oliver Sales  
 101 Promenade, Cheltenham GL50 1NW  
 01242 321091  
 www.elliottoliver.co.uk

