





# Berkeley Street, Cheltenham GL52 2SX

£175,000

🛏 1 🚿 1 🚻 1



- First Floor
- One Double Bedroom
- Off Road Parking
- Ideal for Investors
- Council Tax Band: A
- Period Property
- Seperate Kitchen
- Town Centre Location
- Chain Free





We are delighted to offer to the market this lovely one bedroom first floor period apartment in a Grade II listed building located in Cheltenham Town Centre and within close proximity to Sandford Park. The property briefly comprises of a welcoming entrance hall, a spacious living room and a fitted kitchen. There is also a double bedroom and a large bathroom. The apartment further benefits from off road parking, permit parking and is chain free.



GROUND FLOOR  
402 sq.ft. (37.3 sq.m.) approx.

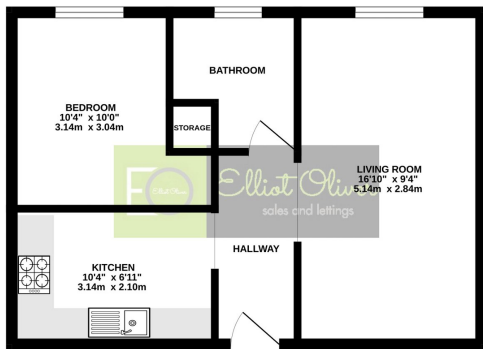

TOTAL FLOOR AREA - 402 sq.ft. (37.3 sq.m.) approx.  
 \*EPC rating is based on the best practice for the current year of the European Commission. Measurements of rooms, surfaces, walls and any other items are approximate and are not responsible to be used for any other purpose or interpretation. The data in the EPC is for information purposes only and should be used for any prospective purchase. The energy rating is approximate and should not be used as a guarantee of energy performance. The energy rating is subject to change without notice and is not guaranteed. © 2022

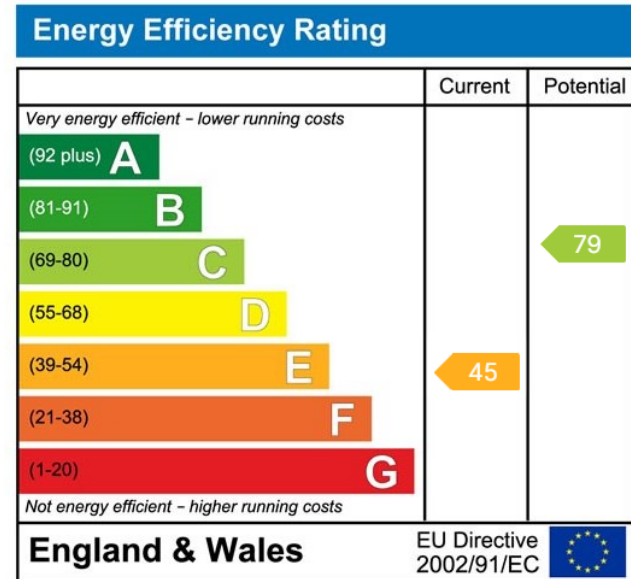

Elliot Oliver Sales  
 101 Promenade, Cheltenham GL50 1NW  
 01242 321091  
 www.elliottoliver.co.uk

