



Regency Place, Cheltenham, GL52

£550,000

🛏️ 3 🪑 2 🛋️ 1



- Modern Town House
- Kitchen / Diner
- Downstairs WC
- Rear Garden
- Town Centre Location
- Three Bedrooms
- Study
- En Suite to Main Bedroom
- Off Road Parking Space



A modern three bedroom town house located in the gated development of Regency Place in the heart of Cheltenham Town Centre. The property would be ideal for a professional couple or family and comprises:- Entrance hall, kitchen / diner with appliances which include a fridge / freezer, oven, hob, dishwasher and washing machine, a study and useful cloakroom, the first floor offers a living room, bedroom three and family bathroom, the second floor leads to the main bedroom with built in wardrobes and en suite shower room and lastly bedroom two. The property further benefits from a rear garden and off road parking for one car.

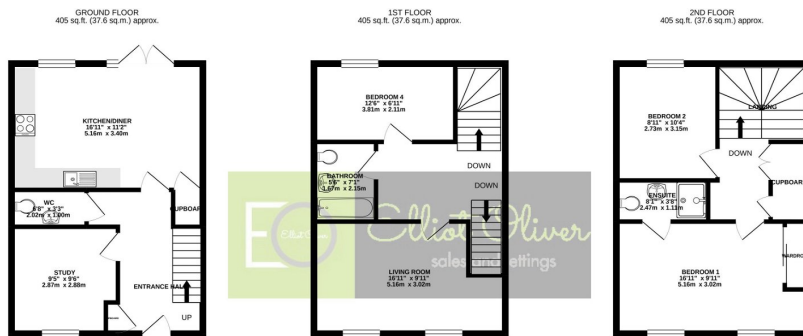

TOTAL FLOOR AREA: 1214 sq ft. (112.9 sq m.) approx.
 Whilst every attempt has been made to ensure the accuracy of the floorplans contained here, measurements of doors, windows, rooms and any other items are approximate and no responsibility is taken for any error, omission or mis-statement. This plan is for illustrative purposes only and should be used as such by any prospective purchaser. The furniture, fixtures and appliances shown have not been tested and no guarantee as to their operability or efficiency can be given.
 Made with Metrepro (2021)

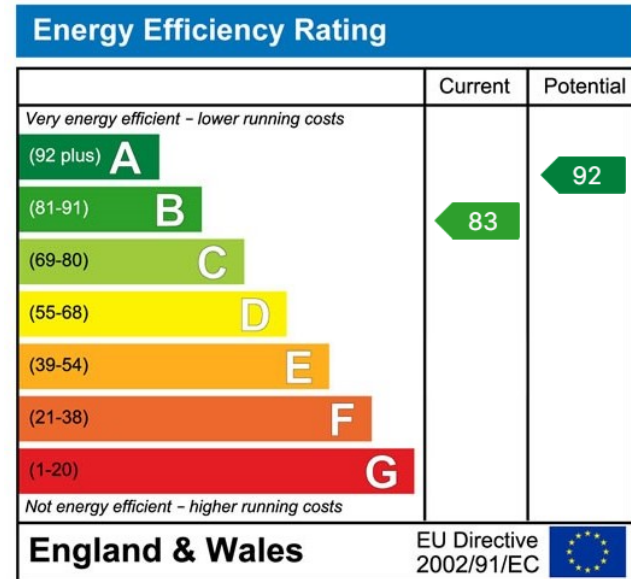

Elliot Oliver Sales
 101 Promenade, Cheltenham GL50 1NW
 01242 321091
 www.elliottoliver.co.uk

