





Hewlett Road, Cheltenham, GL52

Offers Over £600,000

🛏️ 4 🚿 3 🚗 2





A truly remarkable four bedroom semi-detached property in the beautiful Pittville area, has been done to an exceptionally high standard, with viewing highly recommended.

As you enter via the main front entrance you will be greeted straight to the main lounge/dining area guest W.C. Double frosted glass pocket sliding doors then lead

To the rear of the property is a wonderful open plan kitchen/dining space. This is beautifully designed with a range of Neff built in appliances, Quartz work-surfaces and plenty of storage solutions. Completing the ground floor is a downstairs cloak room and bi fold doors leading to the garden.

The first floor includes two double bedrooms, with one of them benefitting an en-suite with walk in shower, plus an additional family bathroom with shower over bath.

Onto the second floor is the principal bedroom which offers built in wardrobe space and a luxurious en-suite bathroom complete with separate shower, bath, wash basin and WC. All bathrooms are done to an exceptional standard and uses Roca bathroom fittings and Porcelanosa flooring tiles.

Externally, there is an enclosed rear, landscaped garden with outbuilding, which can be used as an office. The additional benefit is driveway parking for up to 3 vehicles (two to the side and one in the front).



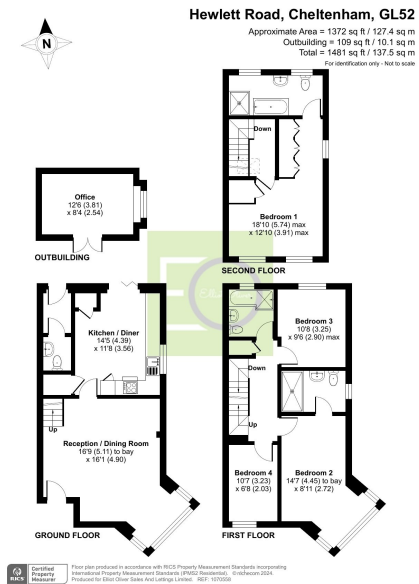

- Four bedrooms
- Semi-detached property
- Driveway- parking for up to 3 vehicles
- Over three floors
- Modern kitchen
- Ample storage
- Three bathrooms
- High specification throughout
- Outbuilding- office space
- Within easy reach of local amenities and town centre

