



St. Thomas Road, Coventry, CV6 7AR

**SHELDON
BOSLEY
KNIGHT**

LAND AND
PROPERTY
PROFESSIONALS

Property Description

*** AVAILABLE NOW *** This spacious three bedroom end terrace family home is in a much desired location close to great local amenities and schools that are within walking distance and transport links to further afield including the M1, M6 and A46. This wonderful home comprises in brief; Entrance hall with separate lounge with large window to the front elevation, there is a 2nd separate reception room, with a downstairs toilet under the stairs and to the rear of the property there is a fitted kitchen including fridge freezer and washing machine and a rear door leading out onto the private enclosed rear garden and a downstairs bathroom completes the accommodation on the ground floor. To the first floor: 1 double bedrooms, with the main bedroom having dual aspect double glazed windows to the rear and side elevation overlooking open green space. There are two further single bedrooms, This property has on street parking, a private garden is offered UNFURNISHED. Energy Rating D. Council Tax Band A





Key Features

- AVAILABLE NOW
- Longford, Coventry
- End of Terrace House
- 3 Bedrooms
- Unfurnished
- Rear Garden
- On Street Parking
- Council Tax Band A
- Energy Rating E

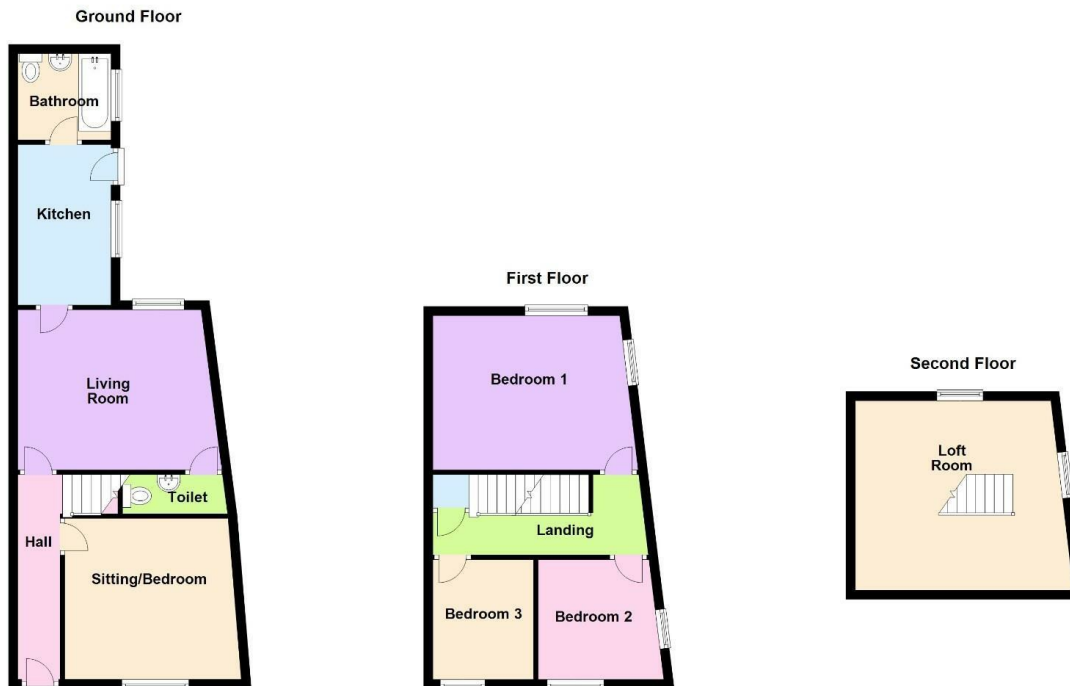

PCM
£995 PCM

EPC Rating - E

Tenure -

Council Tax Band - A

Local Authority -

We routinely refer clients to both our recommended Legal Firm and a panel of Financial Services Providers. It is your decision whether you choose to deal with these companies. In making that decision, you should know that we receive a referral fee