



Firedrake Croft, Coventry, CV1 2DR

**SHELDON
BOSLEY
KNIGHT** LAND AND
PROPERTY
PROFESSIONALS

Property Description

*** AVAILABLE 7TH SEPTEMBER ***

Welcome to Firedrake Croft, Coventry - a charming terraced house that could be your next dream home! As you step inside, you'll be greeted by a cosy reception room, ideal for relaxing with family or entertaining guests. With two bedrooms, there's plenty of space for a growing family, guests, or even a home office. The single bathroom ensures convenience for all residents. Built in 2004, this property offers modern amenities while retaining a homely feel. The allocated parking space for one vehicle adds to the convenience of this wonderful home, making trips in and out hassle-free. Located in Coventry, a city steeped in history and culture, this property provides easy access to local amenities, schools, and transport links, making it a desirable location for anyone looking to settle in a vibrant community. Don't miss out on the opportunity to make this terraced house in Firedrake Croft your own - book a viewing today and step into your future home!





Key Features

- AVAILABLE 7TH SEPTEMBER
- Two Double Bedrooms
- Mid Terraced
- Allocated Parking
- Kitchen/Diner
- Close to Coventry City Centre and Coventry University
- Council Tax Band A
- EPC Rating C

PCM
£1,000 PCM

EPC Rating - C

Tenure -

Council Tax Band - A

Local Authority -
Coventry City Council

Ground Floor

Approx. 31.3 sq. metres (336.8 sq. feet)

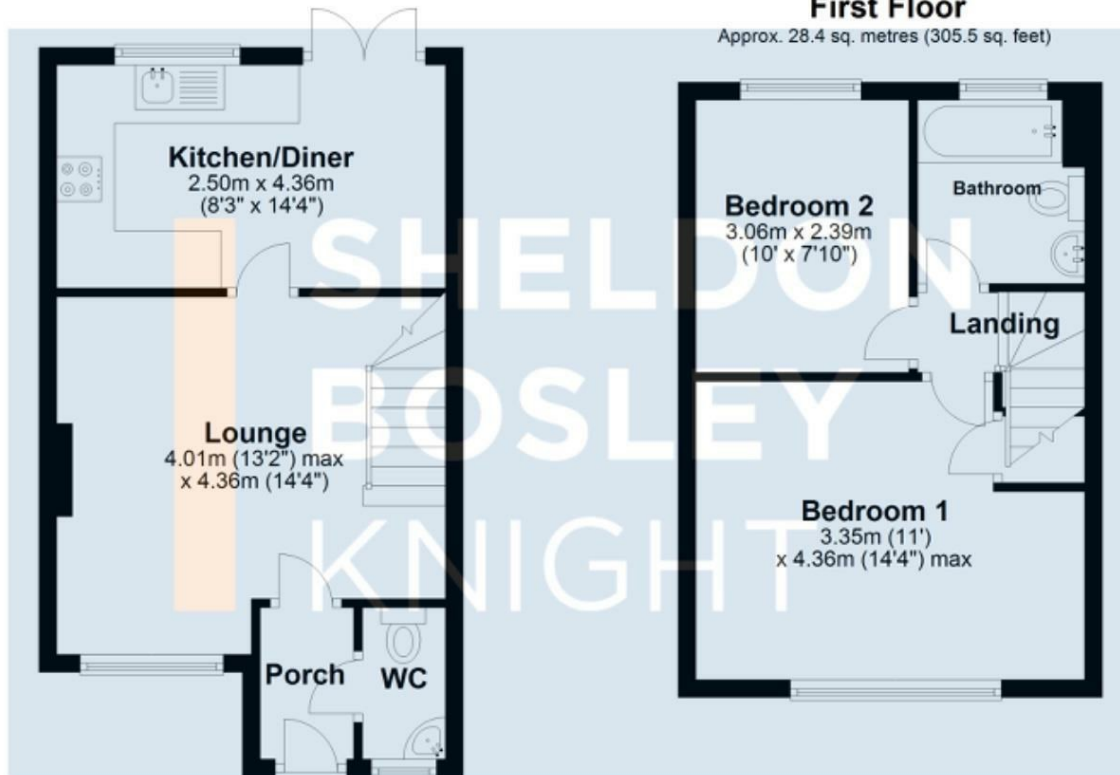

First Floor

Approx. 28.4 sq. metres (305.5 sq. feet)

Total area: approx. 59.7 sq. metres (642.3 sq. feet)

All efforts have been made to ensure that the measurements on this floorplan are accurate however these are for guidance purposes only.
Plan produced using PlanUp.

We routinely refer clients to both our recommended Legal Firm and a panel of Financial Services Providers. It is your decision whether you choose to deal with these companies. In making that decision, you should know that we receive a referral fee